

SPECIFICATION

Infrastructure

Walls

RCC framed structure with solid cement block walls

Flooring

Vitrified tiles for apartment, ceramic tiles for balcony

Main door

Ghana teak solid wooden door with shutters

Internal door

Solid honne/mathi wood frame with flush door shutter

Window

UPVC window (polycad or equivalent make) for balcony door, windows and ventilators

Hall/dining

Telephone and TV point connection, Wash basin for dining

Bedrooms

Telephone and TV point in master bed room

A.C provision in all bedrooms two way light control

Bathroom

Wall mounted E.W.C for all toilets

All tap fittings of ESS ESS make or equivalent

Ceramic tiles (anti skid) for bathroom floors

Provision for exhaust fan

Kitchen

Adequate power points

Provision for exhaust fan

Provision for fixing water purifiers near sink

Plumbing and drainage connection with power point for washing machine

Ceramic tile above counter up to 2 feet height

LOCATION MAP



For
Exceptional
People



EGPI

Ever Green Properties and Investments

No-9, 14th Cross, Malleshwaram, Bangalore - 560 003.

Ph: 080 - 4206 7105 | Mob: 96635 08393

website: www.egpi.in Email: contact@egpi.in

A Project Approved by
HDFC Bank & Bank of India

ARCHITECT
AGNOMEDIA

No-47, 7th Cross, Saraswathi Puram, Bangalore - 560 096

Mobile: 98455 48204

Note: This brochure is purely conceptual and does not constitute a legal document. The architects and promoters reserve the right to change, delete or add any specification or elevation mentioned herein.

AMENITIES

- ◆ 3KW power for 3 bhk and 2 KW power for 2 bhk flats.
- ◆ Over head water tank and underground sump tank with required pumps (automatic pumps).
- ◆ Automatic water level controller for overhead tank.
- ◆ Bore well in addition to corporation water connection.

EGPI AIKYA

@ Link Road, Malleshwaram



TYPICAL FLOOR PLAN

AREA STATEMENT

FLAT-A	3 BHK	1548.00 sft.
FLAT-B	2 BHK	1292.00 sft.
FLAT-C	3 BHK	1550.00 sft.
FLAT-D	3 BHK	1550.00 sft.

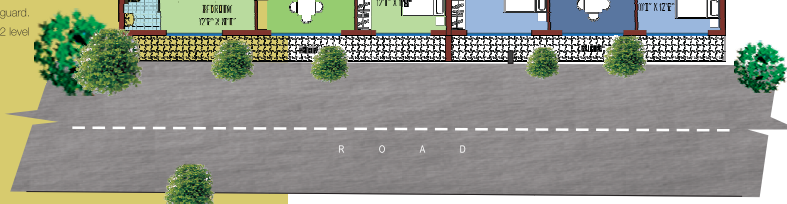

**EGPI
AIKYA**
Link Road, Malleswaram



A new look at
Conveniences

The project has an enviable location, off Link Road, near Malleswaram, one of Bangalore's throbbing hubs. Major shopping arcades like Mantri Mall, Big Bazar & Mega Mart are just a store's throw away. Also shopping for daily needs in and around 8th Cross, Malleswaram is always a pleasure. Well known restaurants, including Halli Mane, reputed educational institutions, state-of-the-art health care options and renowned places of worship are all close by making life at Egpi Aikya a pleasure.

HIGH LIGHTS

- ♦ One fully automatic elevator of 6 passenger capacity
- ♦ Generator to ensure electricity backup for common and apartment lighting (up to 1KW) with sound proof acoustic enclosure
- ♦ Fire extinguishers
- ♦ Attractive melamine polished Ghana teak wood main entrance door.

- ♦ vitrified tile flooring for apartments and granite for staircase and common area
- ♦ Design glazed tile on wall upto 7 feet height for bathrooms
- ♦ Stainless steel sink and granite platform for kitchen.
- ♦ Off white colored sanitary ware (hindware/paryware) in all the toilets.
- ♦ Premium acrylic emulsion paint over putty finished ceilings and walls
- ♦ Modular electrical switches of anchor roma make
- ♦ Electrical wiring using anchor/havells/v-guard.
- ♦ Spacious car parking and provision for 2 level mechanical car park.
- ♦ community /multipurpose hall
- ♦ multi gym

