



BUNGALOW 8



Corporate Office:

RidhiRaj Builders, 1st Floor, SLC Tower, 166, Amrapali Marg, Rathod Nagar, Vaishali Nagar, Jaipur – 302021.

T: 0141-2350377 E: info@ridhirajbuilders.com W: www.ridhirajbuilders.com

BUNGALOW
LIVING REDEFINED

The purest symbol of positivity, growth and elevation, 8 is a number which conjures hope and positive energies to fulfill your lives.

Swift, subtle and the only number which can be regarded to possess a complete character, signifying peace and harmony.



THE WINNER IN YOU WON'T COMPROMISE

Perfection needs no proof. That's what Bungalow 8 stands for. It does not need to prove its influential exclusivity. Bungalow 8 is not just a treasure trove of good fortune, power and iconic standing in the society. It is also a proximate society of the real winners in life. It's the address for those who believe in scaling the heights and giving life the real sense of contentment, in all aspects possible.

It's the source of infinite pleasures, infinite power and infinite adulation. It's not just the promise of a new home for you; but also an assurance of pure indulgence in its eternal magnificence.



NOT JUST AN ADDRESS, BUT A STATEMENT

For those who believe that living is all about getting the most out of life. A sense of style is a blessing given only to a few. For these discerning people we present Bungalow 8 at Bhawani Singh Road, Rambagh Circle, the most prestigious location of Jaipur.

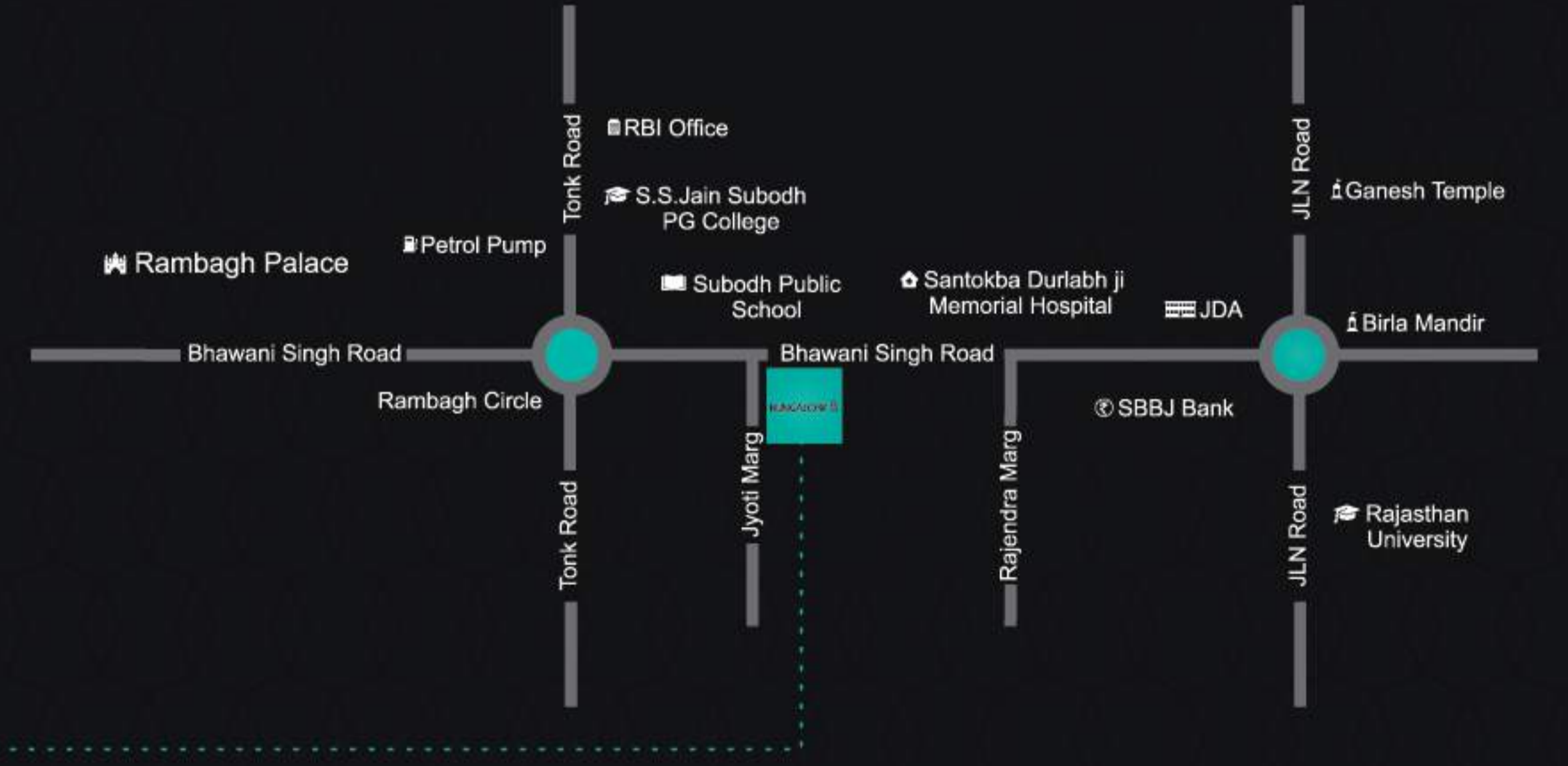



8 BUNGALOWS ONLY FOR 8 AFFLUENT FAMILIES.

The actuality, which makes Bungalow 8 an enigma, is the fact that it's a set of eight most pristine and perfectly created abodes which would become a residence for the eight most iconic families of the city.



MASTER SUITE

EPITOMIZING THE VERY CORE OF LUXURY FOR YOUR DISTINCT COMFORTS!

The master suite is one of the most enlightening enclosures created for you to enjoy life to the hilt. Not less than a presidential suite in a 7-star property, the master bedroom converts itself into a luxury soaked habitat with unparalleled features that infinitely elevate the pleasure of the moments.

The Master Suite Highlights include –

- Grand walk-in wardrobe that lives up to the designer clothing you own.
- Sprawling & spacious bathroom with Jacuzzi & glass walls.
- Refreshing private garden to add complacency to your mornings and evenings.
- Discreet sitting area, ensuring complete privacy and tranquillity.

MAINTAIN EXCLUSIVITY!

A drawing room, separate from the living room options you with an exclusive space for uninterrupted social and formal meetings.



DRAWING ROOM



HOME THEATRE

ORGANIZE YOUR OWN FILM FESTIVAL OR GET COZY WITH YOUR FAVORITE SITCOM
Home Theatre in each Flat

INSPIRING YOUR ENIGMA

The center of your household, your kitchen is undoubtedly the key factor, which adds the taste of joy into your daily life.

The island kitchen at Bungalow 8 would present a picturesque, spacious and fitted with exclusive high-end fixtures styled to suit your homemaker's divine cooking experience. The sophisticated kitchen has some practical advantages with the attached servant room, utility room for washing and drying and a spacious store room making up "service quarters" for your concierge, ensuring un-interrupted assistance.



KITCHEN

STAY NESTLED IN THE LAP OF LUXURY!

The living and dining room area does not only present a picture of pure distinction but also relaxes you luxuriantly. These characteristics turn it into your most beloved space in the entire household.



GARDEN

MOMENTS THAT GET YOUR HEART TO BLOOM AND FILL YOU WITH JOY

Specially manicured and ambient private garden would bring alive your mood as you behold a breathtaking view of the Rambagh Circle's mesmerizing green expanse on your west, Subodh Public School park on the north and Birla Mandir on the east.

BUNGALOW 8



Three level biometric security system



Air conditioned royal entrance lobby



Well equipped gymnasium



Fully landscaped green area

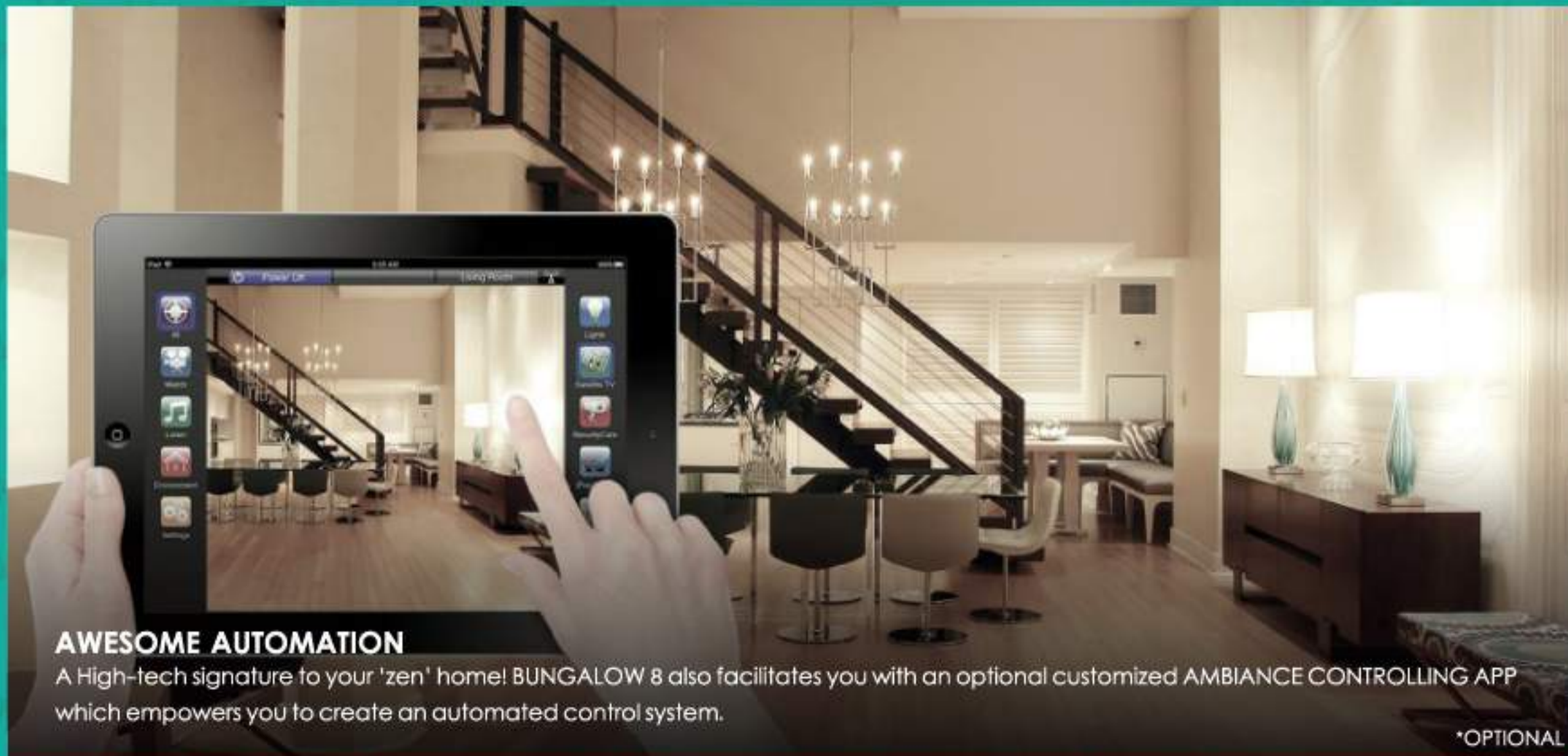

AWESOME AUTOMATION

A High-tech signature to your 'zen' home! BUNGALOW 8 also facilitates you with an optional customized AMBIANCE CONTROLLING APP which empowers you to create an automated control system.

*OPTIONAL

SPECIFICATIONS

GENERAL

- RCC framed Earthquake compliant structure.
- 100% Vastu perfect flats.
- All four side open flats.
- Two automatic elevators with latest technology.

COMMON AMENITIES

- Designed landscaped Lawn and Fountains.
- Silent DG for power back up for common areas and flats.
- Air conditioned gymnasium with Steam/Sauna.
- Exquisite Air Conditioned entrance lobby with Italian marble flooring.
- Imported marble flooring in common lobbies on all floors.
- Garbage disposal chutes.

LIFESTYLE SERVICES

- Each bungalow to have DTH connection.
- Fully Wifi enabled apartments.

FLOORING

- Italian/Imported marble in drawing ,dining and living area. Wooden/Vitrified in bedrooms. Anti skid tiles in Bathrooms.

DOORS AND WINDOWS

- Door frames of seasoned first quality teak wood (SAGWAN).
- Designer wooden doors and insulated UPVC / anodized aluminium French windows with wire mesh for low noise and heat.

KITCHEN

- Full modular high-end island kitchen.
- Centralized LPG gas pipeline system.

TOILETS

- Designer toilets with international standard sanitary ware and cp fittings (Kohler / Grohe).
- Wall hung W.C in each toilet.
- Jacuzzi in master suite bathroom.

ELECTRICAL

- Air conditioning in all bedrooms, drawing room, dining / living rooms of Daiken / O General.
- All wiring of good quality ISI grade of Finolex or equivalent brands.
- Fans and lights in all rooms.
- Geysers and exhaust in toilets.
- TV, telephone and internet line points.
- Modular switches of Anchor/Havells or equivalent brand.

SAFETY AND SECURITY

- CCTV cameras with 24 hrs recording.
- EPABX for security and intra-building communication
- Biometric door lock at entrance lobby.
- Video door phones in each flat.
- Efficient and effective fire fighting systems as per norms.

WATER SUPPLY

- 24 hrs adequate water supply.
- Boring with overhead storage tank.
- Underground water tank for additional water storage.
- Rain water harvesting system to maintain ground water level.

SOLAR ENERGY

- Solar heater to heat water in all bathrooms and kitchen.

TYPICAL FLOOR PLAN



5BHK (1 FLOOR 1 FLAT PLAN)



40 Feet Jyoti Marg on the Right

100 Feet Bhawani Singh Road in Front

BASEMENT FLOOR PLAN



STILT FLOOR PLAN

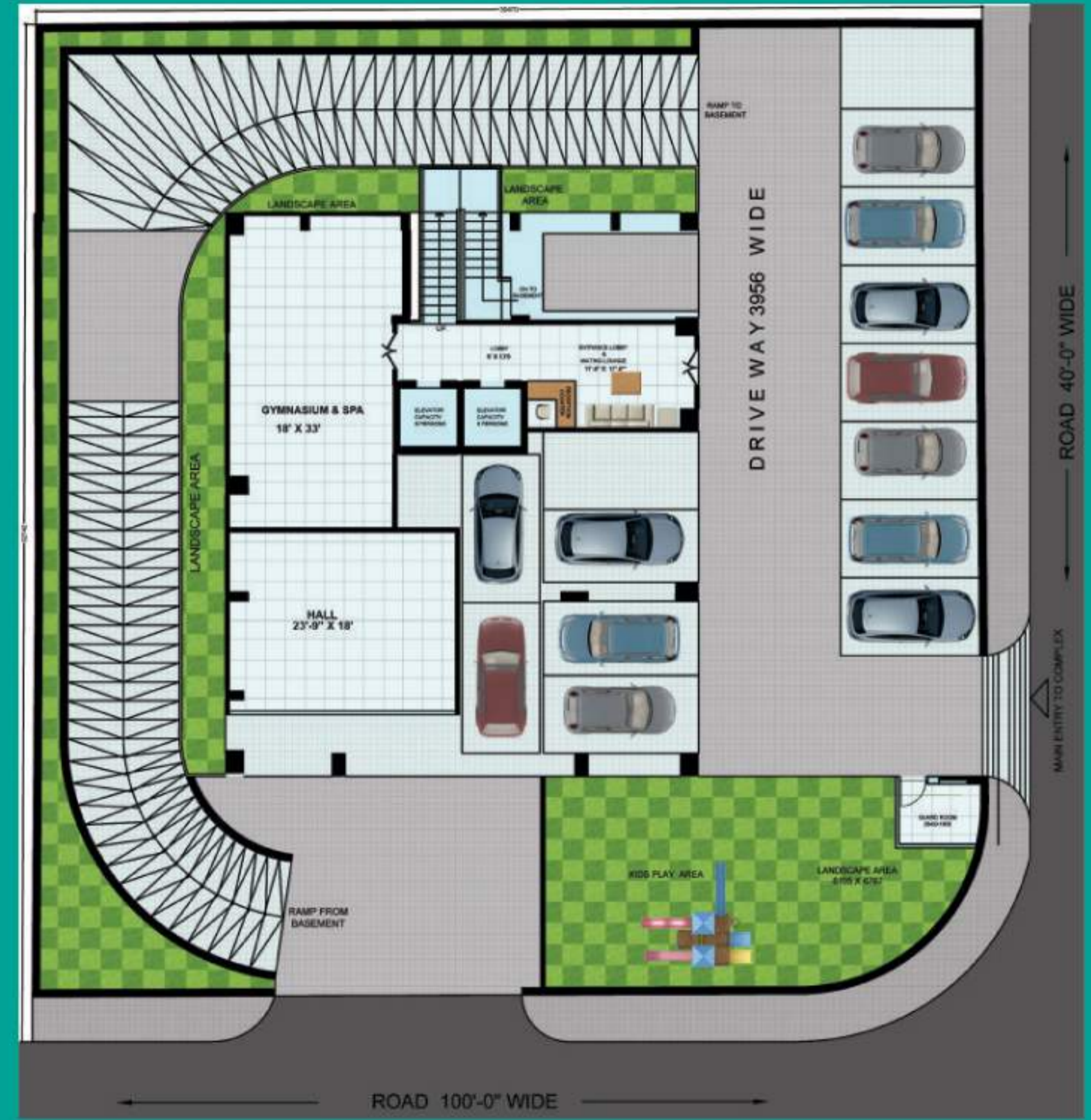
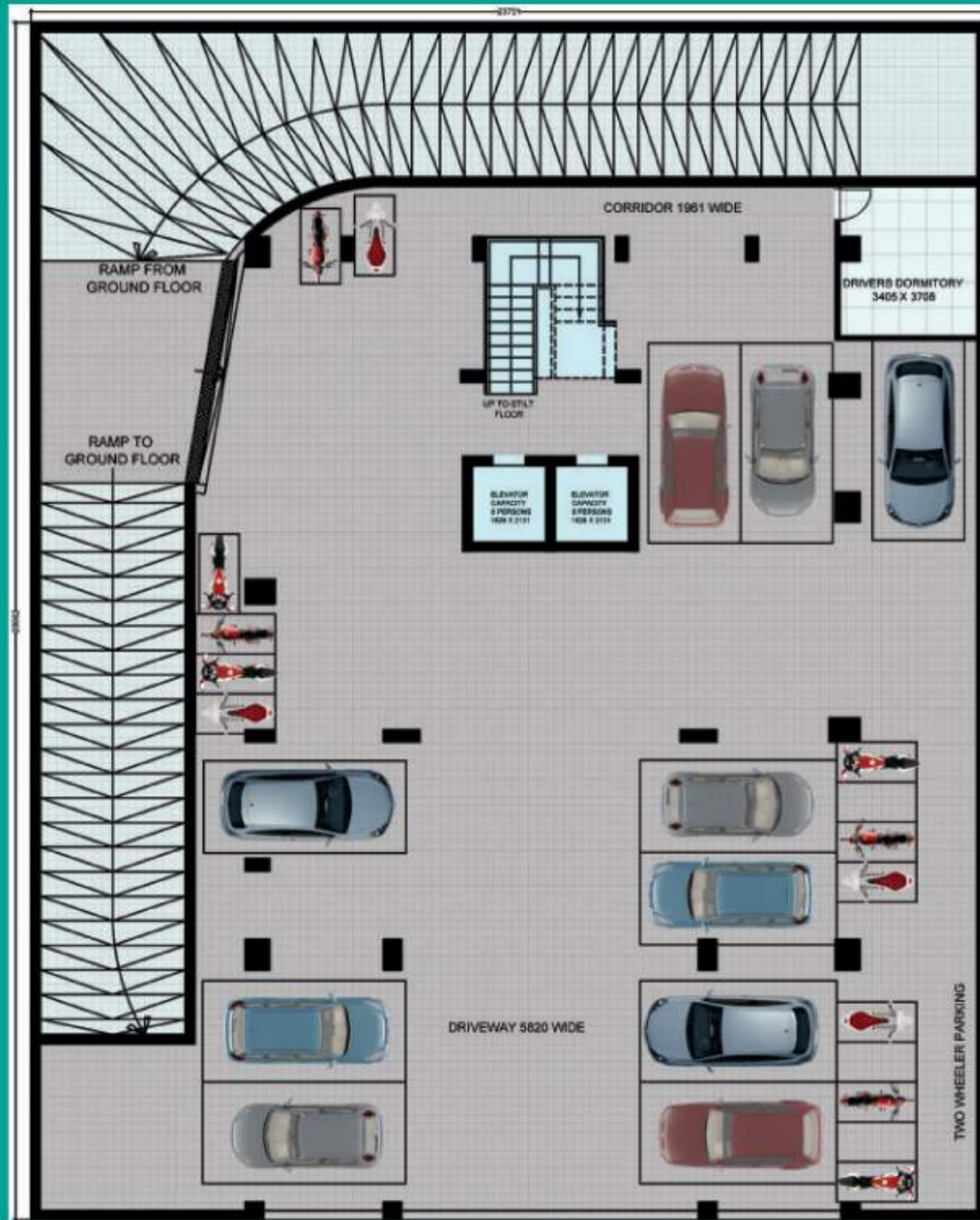

'BUNGALOW 8' SCORES WAY ABOVE, THE IDEAL BUNGALOW OF YOUR STANDARDS.

Surpassing the ideal bungalow of your imagination by quite a distance, Bungalow 8 boasts of the Premium features that have nothing to compare but the apex. Let's detail a few more brownie points that the possession adds up for you:

- It would require a fortune of an investment for owning an individual bungalow on a landmark location as Bungalow 8.
- The ease of maintenance and the convenience is a heavenly gift
- The advantage of height gives you a mesmeric view of the city.
- The bliss of free air and unrestricted sunlight gets added to your everyday life.
- Elite set of neighbours to connect and bind with.
- Better security to let you enjoy life, carefree & unperturbed!

Now, how would you rate Bungalow 8 over an individual bungalow?



Propelled by the energetic vision of young entrepreneurs who abide by the ethics of their predecessors and lead the brand with dynamic contemporary acumen; Ridhiraj Builders has proven itself to be a front runner in the realm of Real Estate Development.

A brand that's focused on evolving the plethora of offerings that the Real Estate sector has to offer in Rajasthan, Ridhiraj Builders strive to create a niche of their own by presenting iconic projects to their distinguished patrons and giving them the residential pleasures that are rarely obtained while choosing any other existing equivalent.

Positioned as a 'Super' Luxury service provider Ridhiraj Builders as a brand provides possessions to the upper crust of the society which have been tastefully designed, developed and created by celebrated experts from the industry.

Right from handpicking the most premium and posh locations to planning of the project and adding unique stand-out features to each project, over the span of time, Ridhiraj Builders have developed an identity of a trendsetting brand, that provides the perfect match to the towering expectations of its affluent and class driven consumers.

OTHER PREMIUM PROJECTS BY THE GROUP



THE PARK CENTRAL
Opposite Central Park,
Tonk Road, Jaipur



ARALYAS
Opposite Pink Square Mall,
Govind Marg, Jaipur



AIR
Opposite Shyam Nagar,
Main Ajmer Road, Jaipur



RIDHIRAJ ENCLAVE
Hanuman Nagar-D,
Vaishali Nagar, Jaipur



RIDHIRAJ RESIDENCY
Vijay Path,
Tilak Nagar, Jaipur



RIDHIRAJ AVENUE
Near Amrapali Circle,
Vaishali Nagar, Jaipur