



PRATYUSHA
DEVELOPERS

Sree Sai
Brindavanam

REJOICE
IN THE LAP OF
NATURE



Sree Sai
Brindavanam



PRATYUSHA DEVELOPERS

Pratyusha Developers is being managed by well experienced structural engineer V. Ravinder Reddy AMIE, M.Tech (stru) who guided many of the builders in Hyderabad through his service to well known projects in the city, like commercial complexes, residential avenues, luxurious apartments etc.

Achieving for the absolute quality and utmost satisfaction of every customer is the motto of Pratyusha Developers. As a civil Engineer V. Ravinder Reddy is having experience of more than thirty years and as builder about 20 years of experience.

Typical Floor Plan



30'0" WIDE ROAD

40'0" WIDE ROAD

Stilt Floor Plan

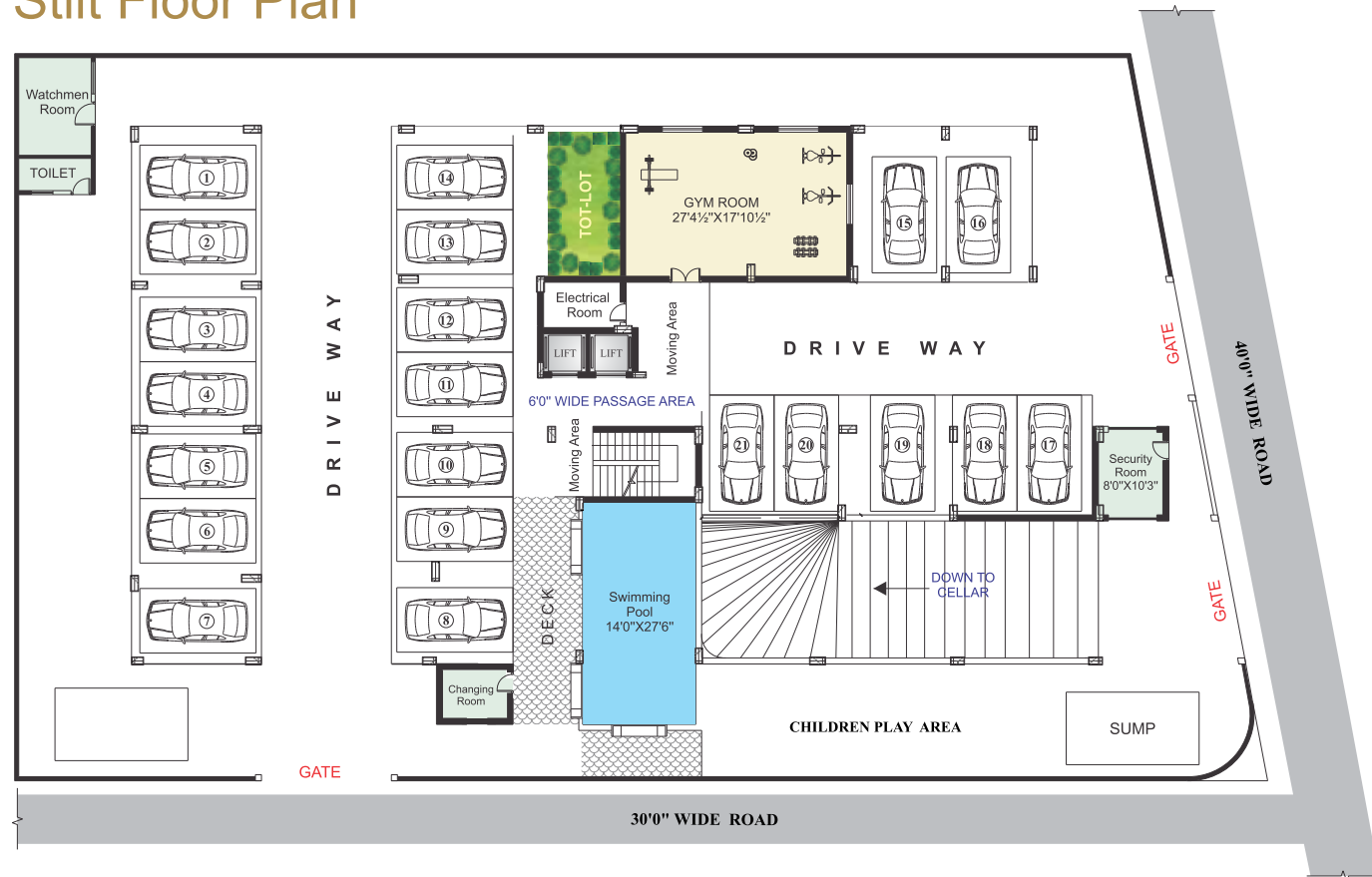

Cellar Parking Plan

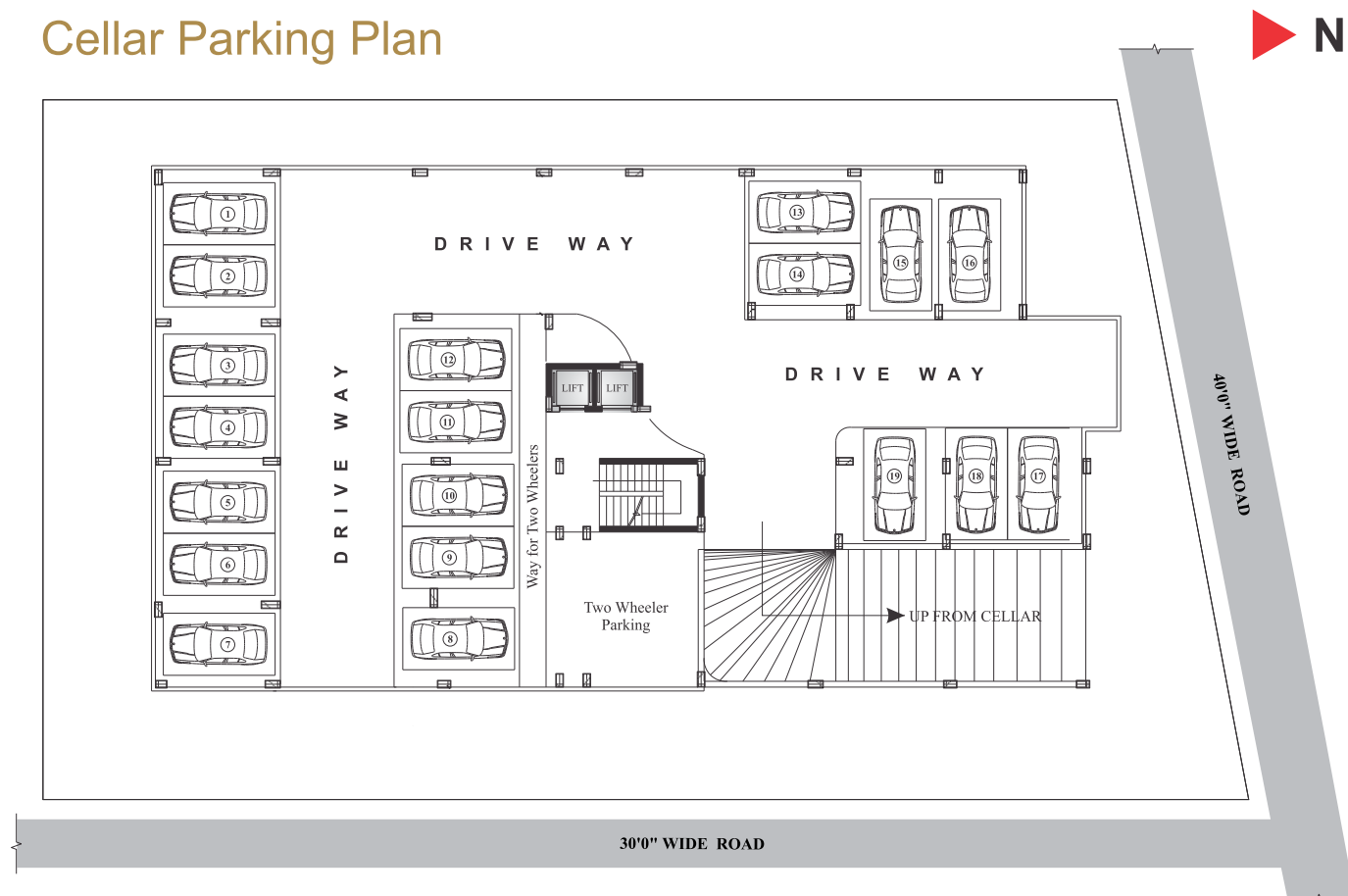

Specifications:

- **FOUNDATION & STRUCTURE** : R.C.C. Framed Structure as per standard specification of national building codes.
- **WALLS** : Clay brick of 4½" and 9" thick/cement bricks of 4" and 8" thick with cement mortar of (1:6) prop. for internal and external walls, and cement plastering of ¾" in C.M. (1:6) & (1:4) prop. with sponge finishing.
- **WINDOWS** : UPVC Sliding windows of 2 track.
- **DOORS** : Teak Wood frame with teak wood shutter for main door and other doors of teak wood frames with laminated shutters.
- **FLOORING** : Vitrified tiles flooring of 2' X 2' size.
- **KITCHEN** : Platform with granite and 2'-0" HT of dadoing with ceramic tiles.
- **TOILETS** : E.W.C./I.W.C. Aquado /Hindware or Equivalent quality in each toilet and 6' 6" height glazed tiles for walls. Anti skid ceramic tiles flooring for toilets and wash (UTY) area.
- **PAINTING** : Birla/Alteck wallcare (luppum) finishing with emulsion for interior and apex or dulux for exterior.
- **ELECTRICAL** : ABB, Havells, Legrand or equivalent make.
- **PLUMBING** : Fittings of standard make.
- **LIFT** : Legend make.
- **GENERATOR** : For common lights and Lift, 6 to 7 points and 3 fan points into the flat.

Location Plan

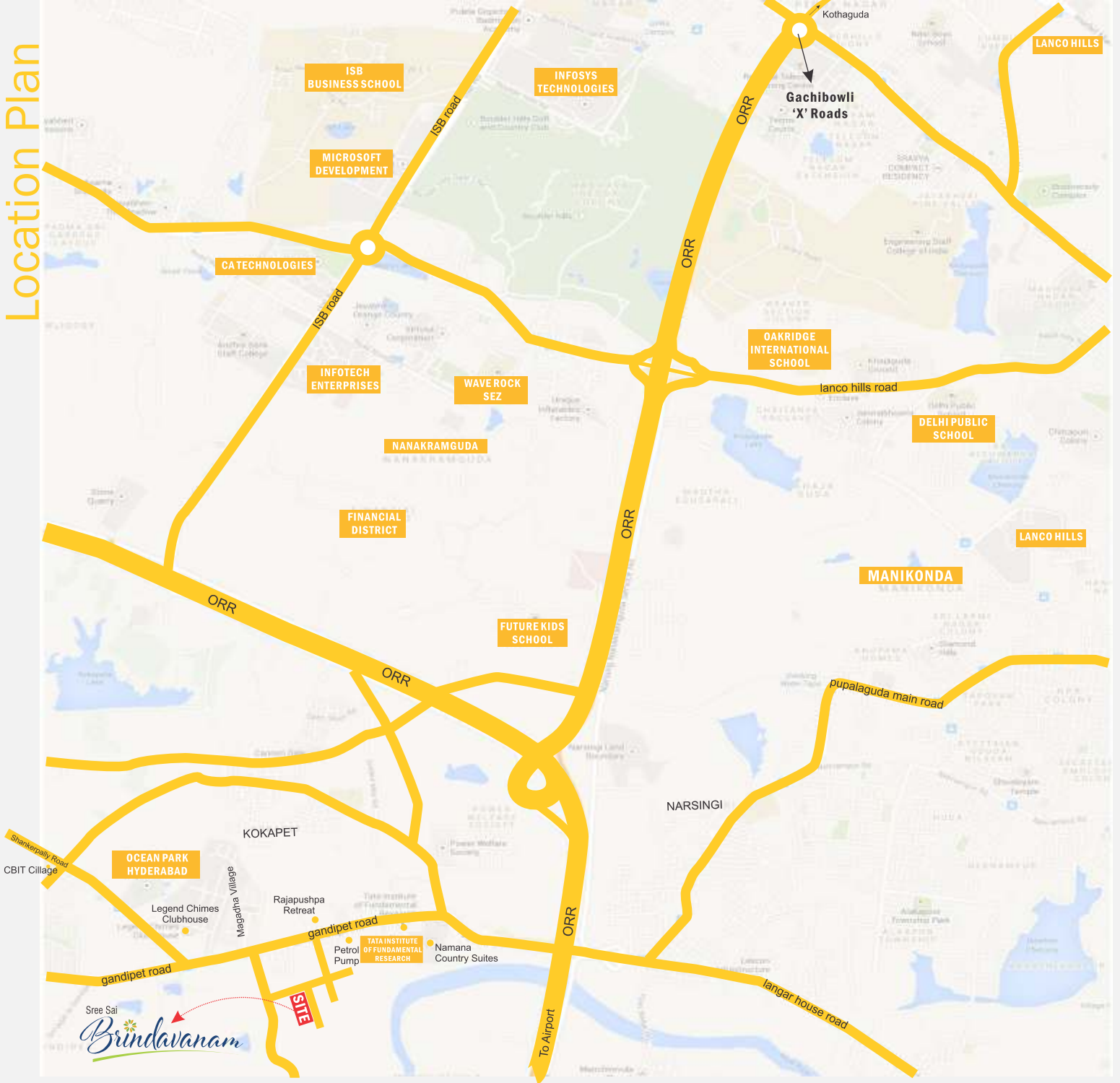

Site Address:
 Plot No. 54, 56 & 58,
 In Sy. No. 159 of Narsinghi Village,
 Rajender Nagar Mandal, R.R. Dist.

Flat No. G1, GVS Towers,
 Indra Park Road, Domalguda,
 Hyderabad.
 Ph: 9391047428

Structural Engineers:
 Anil Kumar B.E. M.Tech. (Stru)

Note : This brochure is only a conceptual presentation of the project and not a legal offering. The promoters reserve the right to alter and make changes in elevation, specifications and plan as deemed fit.