

Location Map
Note: Not To Scale



Ongoing Project



Providence Bliss
Maroli, Mangalore

Completed Projects



Providence Abode - 1
Bejai New Road, Mangalore



Providence Abode - 2
Bejai New Road, Mangalore

Promoters

PROVIDENCE
BUILDERS DEVELOPERS

Bejai New Road, Mangalore - 575 004.
Ph. : +91 0824 4255523, 4266523
Cell : +91 98440 03071, 98451 83832
90082 08823

E-mail : providence.builders@yahoo.com
Web : www.providencemangalore.com

Architects

ARCHI - TECHNICS
Albert Mansion, Sturrock Road,
Falnir, Mangalore
Phone : 0824 2424863, 2424456

Structural Consultants

M/s Planing Systems
Mangalore

Deeds and not words, is what we believe that's the difference between us and others !

PROVIDENCE
Cascade

Luxury Residential Apartments
at Bejai New Road, Mangalore



PROVIDENCE

Cascade

Searching for a comfortable and contemporary lifestyle affordably priced? Within the walls of this highly secure development, **Providence Cascade** offers you a combination of luxury, convenience and value previously unavailable in apartment living. You will find an exciting selection of floor plans, amenities and facilities, which gives **Providence Cascade** a uniquely inviting flavor.

Providence Cascade Located at Bejai New Road, Mangalore, it is also merely 2 minutes drive from City Center, Nearby and seemingly endless recreation, entertainment, shopping and dining offers you a life of exciting convenience just outside your doorstep. The ten-storey structure incorporates all essential amenities, with the entire basement being allotted for parking. With the continuing demand for good houses in the real estate sector, **Providence Cascade** will certainly prove to be a wise investment for you in the future. We believe that there is no such thing as an unimportant detail and our dedication sets the stage for gracious, prompt service.

Virtually everything you could desire is just steps away from your new home at **Providence Cascade**.



Typical Floor Plan

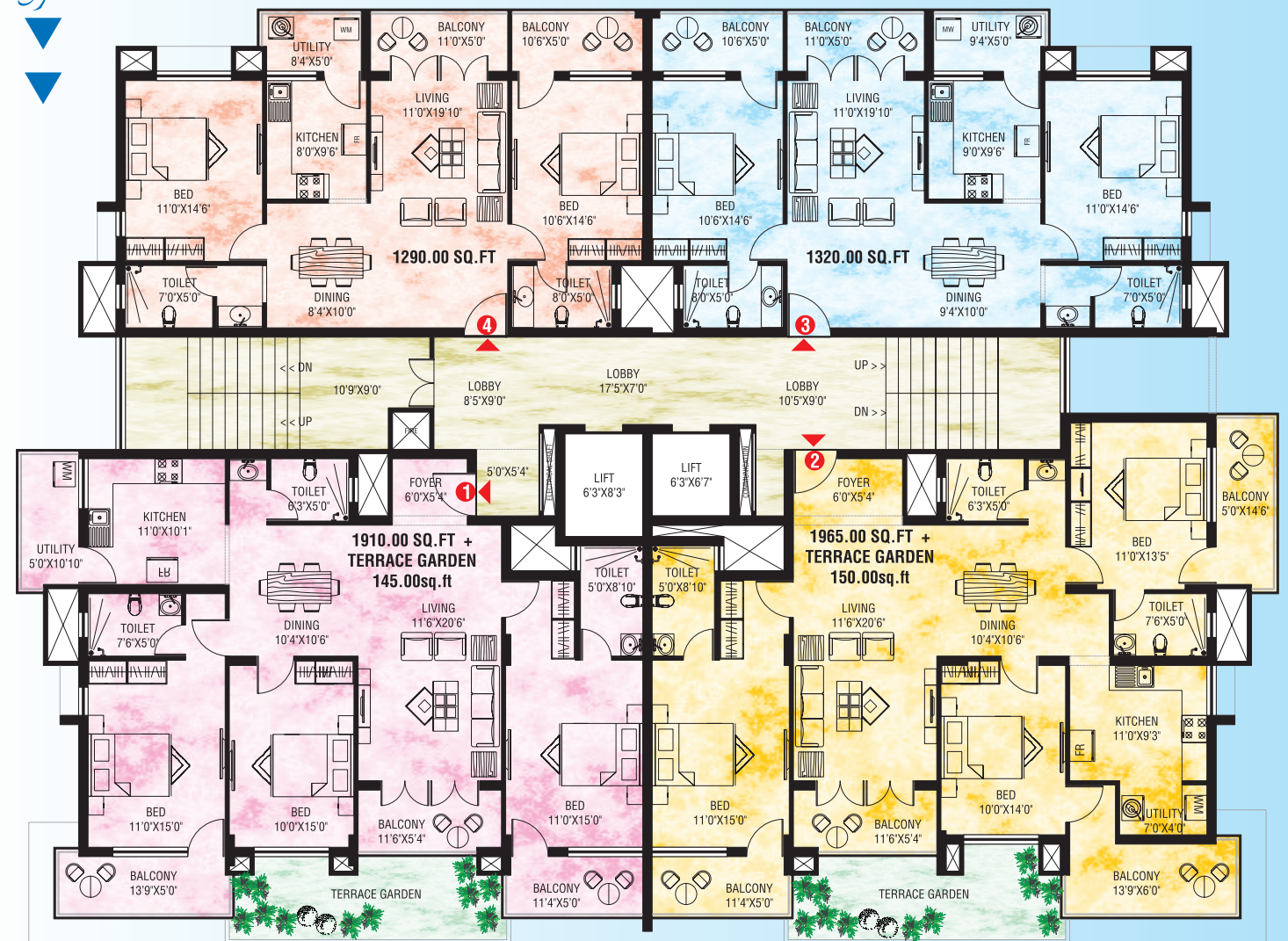

Highlights :

- ❖ Two High Speed Automatic Elevators with standby generator.
- ❖ Generator for common and apartment lighting with sound proof enclosure.
- ❖ Vitrified mirror finish Tiles.
- ❖ Video door phone conference system & Surveillance Monitoring & Recording.
- ❖ Reticulated gas connection.
- ❖ Non addressable fire fighting system.
- ❖ Attractive Melamine polished main entrance door.
- ❖ Car parking in basement floor.
- ❖ Cable T.V. / C.C. T.V. provision.
- ❖ Gymnasium, Children's Play area.
- ❖ Sky Garden.
- ❖ Community Hall.

Specifications :

- ❖ Fully covered R.C.C structure with laterite masonry walls for external and brick masonry for internal.
- ❖ Hardwood door / Window frames with decorative flush door for rooms and fibrotech shutters with granite door frame for toilets & wooden shutters for windows with M.S. grills.
- ❖ 4 K.W. power provided for each apartment with single phase meter.
- ❖ Overhead water tank and under ground sump tank with required pump.
- ❖ Bore well in addition to the Corporation water connection.
- ❖ Concealed electrical wiring with modular electrical switches.

LIVING / DINING :

- ❖ T.V. point, Telephone point.

PAINTING :

- ❖ Interior with superior quality oil bound distemper point on smooth putty finished walls.
- ❖ Exterior walls with superior quality exterior emulsion paint.

BED ROOMS :

- ❖ AC Point Provision.
- ❖ All window opening on the exterior walls of the building for maximum privacy.

KITCHEN :

- ❖ Black Granite platform with stainless steel sink with drain board.
- ❖ C.P. plumbing fittings.
- ❖ Self printed glazed tiles dadoing walls up to 2'0" height.
- ❖ Provision for fixing water purifiers, exhaust fan and two power points.

BATHROOMS / TOILETS :

- ❖ Water proof treatment done for sunken R.C.C slab.
- ❖ Pressure checked plumbing and drainage pipelines to assure total leak proof toilets.
- ❖ Grohe (German Brand) C.P. fittings & Durovit sanitary fittings.
- ❖ Flush valves for commodes.
- ❖ Coloured ceramic tiles (anti skid) for bathroom floor & wall cladding with self printed glazed tiles upto full height.

