

हिरवेगार मन असावे  
निकाईचे छत्र भिकावे  
'सुदत्त संकुल' च्या जगात  
तुझे नि माझे घर वसावे...



MAHARERA REGN. NO.  
P52100018951

निर्मिती  
बांदल-मानकर-बहिरट असोसिएशन

सुदत्त  
संकुल  
एक समृद्ध जीवनशैली

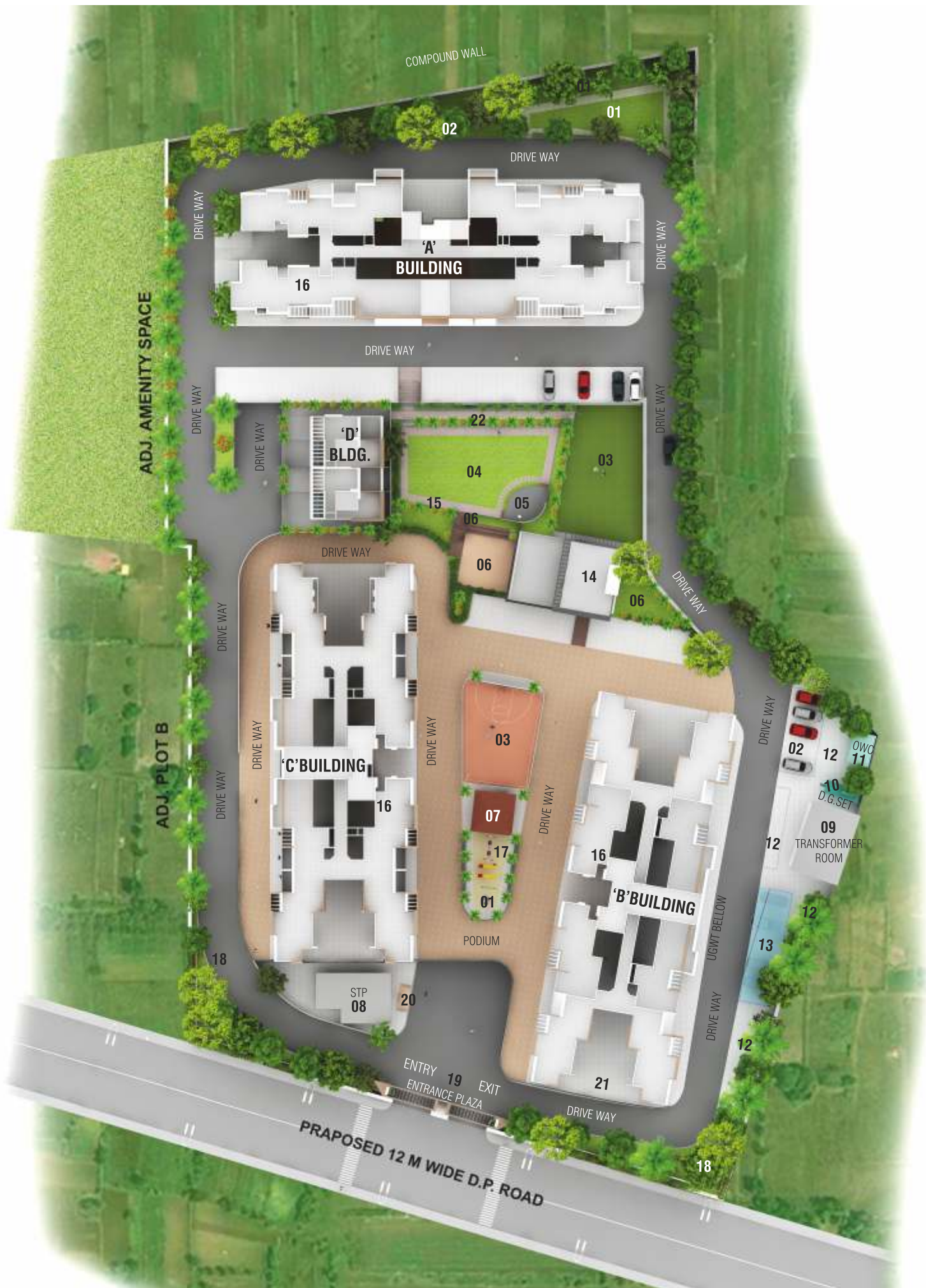

## LEGEND

- 01. KIDS PLAY AREA
- 02. VISITORS PARKING
- 03. MULTI PURPOSE PLAY COURT
- 04, 05 LAWN WITH STAGE
- 06. PAVED AREA
- 07. GAZEBO
- 08. SEWAGE TREATMENT PLAN
- 09. TRANSFORMER ROOM
- 10. GENERATOR
- 11. ORGANIC WASTE CONVERTER
- 12. TWO WHEELER PARKING FOR 'B' BLDG.
- 13. CAR PARKING FOR 'B' BLDG.

- 14. CLUB HOUSE, GYM & INDOOR GAMES
- 15. JOGGING TRACK
- 16. SANITATION FACILITY FOR DRIVERS AT LOWER GROUND FLOOR
- 17. CAR WASHING SPACE AT LOWER GROUND FLOOR
- 18. RAIN WATER HARVESTING CHAMBERS
- 19. SECURITY CABIN AT LOWER GROUND FLOOR
- 20. WAITING AREA AT LOWER GROUND FLOOR
- 21. SOCIETY OFFICE AT LOWER GROUND FLOOR
- 22. AMPHITHEATER

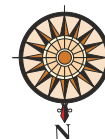

**MASTER LAYOUT**

Life is a gift of nature but beautiful living is the gift of wisdom...

**BMB Construction Company** proudly presents **"Sudatta Sankul B Building"** an exquisite lifestyle creation located at the fastest growing locale of Sinhagad Road.

The creator behind this 'intelligent home' is BMB Const. Co., a name with a string of successful prestigious projects in and around Pune to its credit. BMB Const. Co. is an established estate experts with a passion for value addition and a dynamic, involved team that translates every innovative idea into practical reality. They have extensive experience, creative vision and professional ethics.

Beauty beyond compare...

At **"Sudatta Sankul B Building"**, every home is designed with a feel of your dream-house and has been planned to suit to your needs and joyous life. It is not just a construction but a wise creation and that makes all the difference.

Fresh breeze, pollution free atmosphere, ample sunlight and a picturesque backdrop of lush green forest... with all these surroundings **"Sudatta Sankul B Building"** can be upheld as the most beautiful home around. Aesthetics and utility, at **"Sudatta Sankul B Building"** they go hand in hand.

Sinhagad Road locale offers great value appreciation and a home in **"Sudatta Sankul B Building"** means loads of privileges.



A home you will long to return to...

After a hectic day when you are craving for your cozy nest and embrace of your loved ones, the congested roads and mid way traffic is a frustrating block. **"Sudatta Sankul B Building"** is strategically located to steer clear of all this mess and have a comfortable drive straight home.

Sudatta sankul's proximity to the core city offers you much more on its palette, like malls, multiplexes, educational institutions, driving distance from Deccan and Peth areas and access to Highway.

The locality also promises likeminded neighbourhood and vibrant community living.



## 'B' BUILDING



### Space, to breathe, to dream, to grow...

The project offers contemporary living and a premium lifestyle. Spread over a grandeur **four acre** expanse. This building has best in class specifications. Everything is intelligently designed and smartly executed to deliver a flawless living experience.

“Sudatta Sankul” offer you a mesmerizing, peaceful heaven with wisely selected amenities.

“Sudatta sankul” has a **huge dedicated open space** where you may enjoy your family functions, parties and celebrations in the Multipurpose Community Hall or at Party Lawn with Stage, a Gymnasium which is set to enhance your fitness quotient with all the state-of-the-art equipments, Multi-purpose Sports Court are other highlights that accentuate Sudatta Sankul's genuine yet affordable luxury. With such uncompromising



offerings, you have everything that you had dreamed of for a quality family life. So come along, an enriched lifestyle is not a distant dream, any more.

We have used our experience, vision and expertise to create a beautiful living for you. Now it is your turn to think and choose wisely. Life indeed is a rare gift. Why hesitate in giving it a perfect platform?

Go for it !!

## AMENITIES

- Decorative 'Entrance Plaza' with Security Check and Intercom Facility.
- Two Automatic Lifts
- Partial Generator Back-up for common facilities.
- Fire Fighting system with Refuge Area.
- Solar Water Heating system.
- Rain Water Harvesting.
- Garbage Chute.
- Multipurpose Court.
- Waiting Area
- Multipurpose Hall.
- Gymnasium.
- Game Room including Card, Carom, Chess & Table Tennis.
- Children's Play Area.
- Gazebo.
- Jogging Track
- Amphitheatre
- Lush green Party Lawn with Stage.
- Sanitation facility for drivers, servants and society staff.
- Ample covered car parking.
- Car Wash Area.
- Sewage treatment plant (S.T.P).
- Organic Waste Convertor machine (O.W.C)
- Internal Trimx Concrete roads.

## INTERNAL SPECIFICATIONS

### STRUCTURE

- Earthquake resistant R.C.C. frame structure

### WALLS & CEILING

- All External and Internal walls in 6" thick brick /AAC Block
- External Walls finished with sand faced plaster.
- Internal Walls & Ceiling finished with smooth coating of Gypsum/Neeru.
- Internal Walls exposed to external side finished with tar plaster and gypsum

### FLOORING

- 24" x 24" Vitrified tiles in entire Flat.
- Anti-Skid ceramic tiles for Toilets.
- Ceramic tiles for Open Balcony.

### KITCHEN

- Granite Kitchen platform with Stainless Steel Sink.
- Full height glazed tile dado.
- Exhaust Fan and Provision for Water Purifier.
- Adequate electric points.

### TOILETS

- Full height designer glazed tile dado.
- Concealed plumbing with branded C.P. fittings.
- Concealed Diverters for all Toilets.
- Branded Sanitary fittings.
- Wall Hung Commodes for Master toilet and Floor Mounted Commodes for other toilets.
- Solar water connection only in Master Toilet.
- Provision for Exhaust fan and Gyser.



ALL IMAGES ARE ARTIST IMPRESSION

### UTILITY

- Provision for Washing Machine.
- Glazed tile dado upto Sill level.

### WINDOWS

- Powder coated aluminium sliding windows with mosquito net except toilet and utility windows and safety grills.
- Granite / Marble window Sill.

### DOORS & DOORFRAME

- Elegant Main Door with Premium quality fittings.
- Ply finish doorframes with molding patti for main door & bedroom.
- All Internal flush doors with oil paint and cylindrical knobs.
- French Open able door with mosquito net for open balcony.
- Granite doorframe for toilets.

### ELECTRICALS

- Concealed Electrification.
- Fire-retardant Copper wiring of branded make.
- T.V. and Telephone points in Hall & Master bedroom.
- Provision for Split A.C. in Master bedroom.

### PAINT WALLS

- External walls with Apex & Cement paint.
- Internal walls with Acrylic Oil-Bound distemper.

### POWER BACK-UP

- Provision for Inverter.

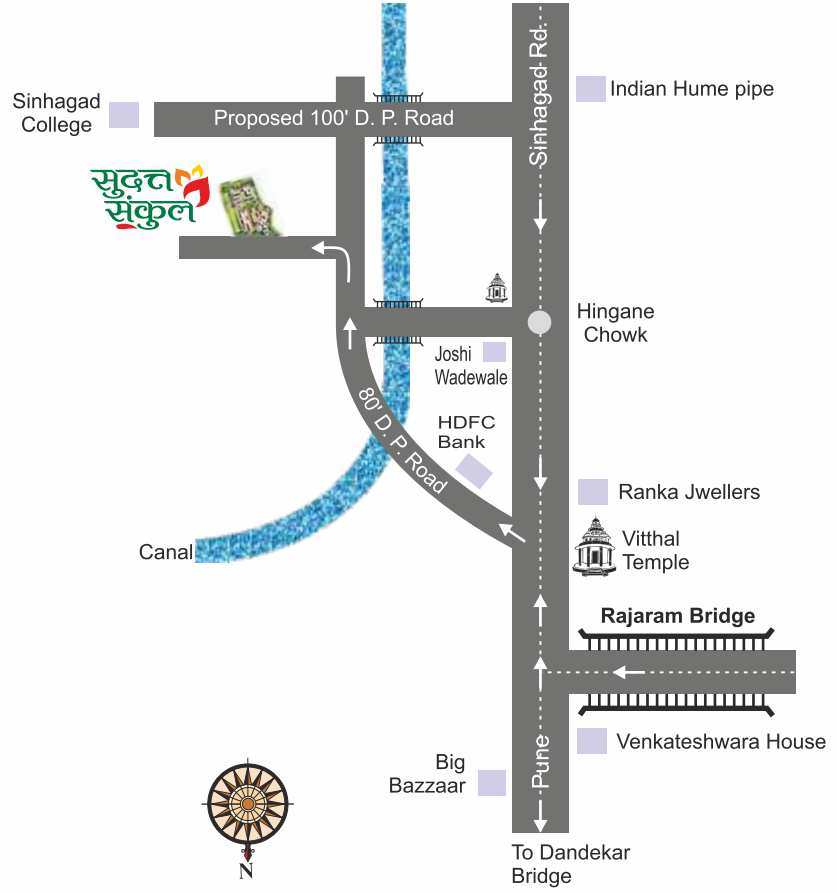

**Site - S. No. 8, Behind Damodar Nagar,  
Canal Road, Hingane (Kh.) Sinhad Road, Pune - 51**

**LOCATION MAP**  
(Not to Scale)

**Contact : 93730 85300 / 93730 85301**  
**Email: [bmbsales@bandalbuilders.com](mailto:bmbsales@bandalbuilders.com)**  
**[www.bandalbuilders.com](http://www.bandalbuilders.com)**

**CREDITS**

**ARCHITECT & LANDSCAPE DESIGNERS**  
Fourth Dimension Architects Pvt. Ltd  
O20 - 41000999

**LEGAL ADVISOR**  
S.R.S. Advocates & Associates  
020-25663494 / 25650373

**RCC CONSULTANT**  
V M Consultants  
O20 - 25657701

**ELECTRICAL & PLUMBING CONSULTANT**  
Kicons Ltd. (Now Part of FDAPL)  
O20 - 41000999

The project has been registered via MahaRERA registration number : P52100018951 and is available on the website <https://maharera.mahaonline.gov.in> under registered projects.



**Association of  
Bandal♦Mankar♦Bahirat**



S. No. 81/1, Bandal Capital, Nr. P. M.T. Depot, Paud Road, Kothrud, Pune - 411038 Ph.: 020-25281710

Note : All visual Photographs used in this brochure are artists impression. All the plans, Drawings, Amenities, Facilities, Layout, etc. Are subject to the approval of the respective authorities & would be changed at the discretion of the developers as and when required.