

**Kalhaar**<sup>®</sup>  
Blues & Greens



GOLF VILLAS

# specifications

- Earthquake resistant load bearing structure with additional Reinforced Cement Concrete slab at plinth level.
- Internally smooth finished plaster and externally double coat plaster with textured paint.
- Vitrified tiles or equivalent flooring in living, dining and foyer / entrance area.
- Wooden flooring in master bedroom.
- Vitrified tiles or equivalent in all other areas.
- Polished kotah stone upto 150 sq. ft. in Kitchen service yard.
- Paver blocks upto 400 sq. ft. in Carport area.
- Flush door shutters and glass shutter windows with wooden frames.
- Individual Pressure pump in each villa.



**OPTION-1**  
GROUND FLOOR

BUILT UP AREA : 191 sq.yds.  
SUPER BUILT UP AREA : 277 sq.yds.





**OPTION-2**  
FIRST FLOOR





OPTION-3  
FIRST FLOOR







**OPTION-4**  
FIRST FLOOR



**OPTION-5**  
GROUND FLOOR

BUILT UP AREA : 384 sq.yds.  
SUPER BUILT UP AREA : 534 sq.yds.



**OPTION-5**  
FIRST FLOOR



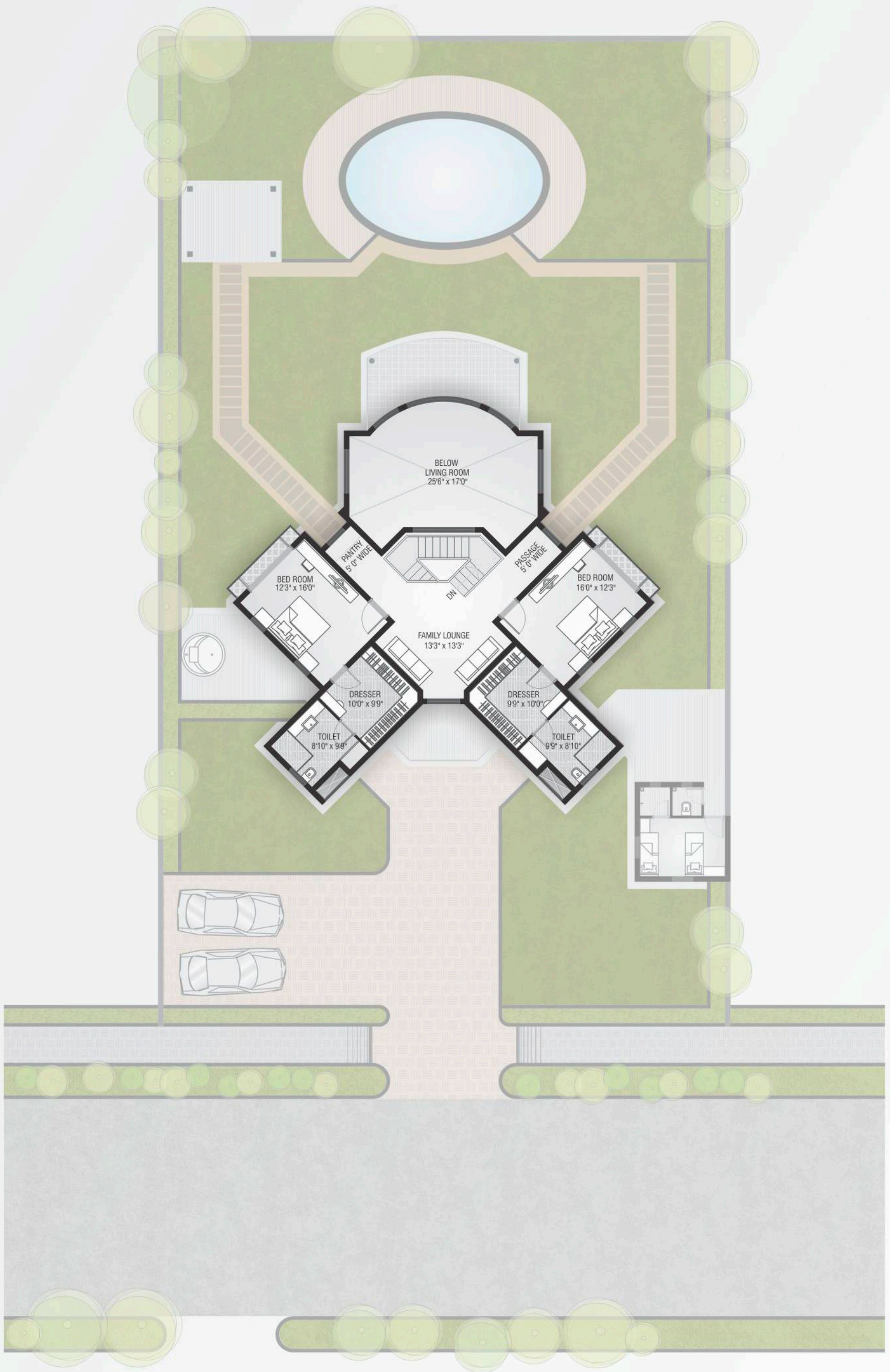

OPTION-6  
FIRST FLOOR





**OPTION-7**  
FIRST FLOOR



**NAVRATNA ORGANISERS & DEVELOPERS PVT. LTD.**

"Kaycrest", Second floor, Opp. Gujarat Gas Co. Ltd., C.G.Road, Ahmedabad - 380006, Gujarat, INDIA.  
 Ph.: (91-79) 26447879 / 26427104 / 32991840 / 32991877 Fax : (91-79) 26564735  
 email : info@navratna.com Web : www.navratna.com

**Notes**

Above specifications are standard. Internal changes will not be allowed.  
 The Developer reserves the right to change / modify the design, area and specifications and all members shall abide by such changes.  
 This Brochure is not to be treated as a legal document.