

GROUND FLOOR PLAN

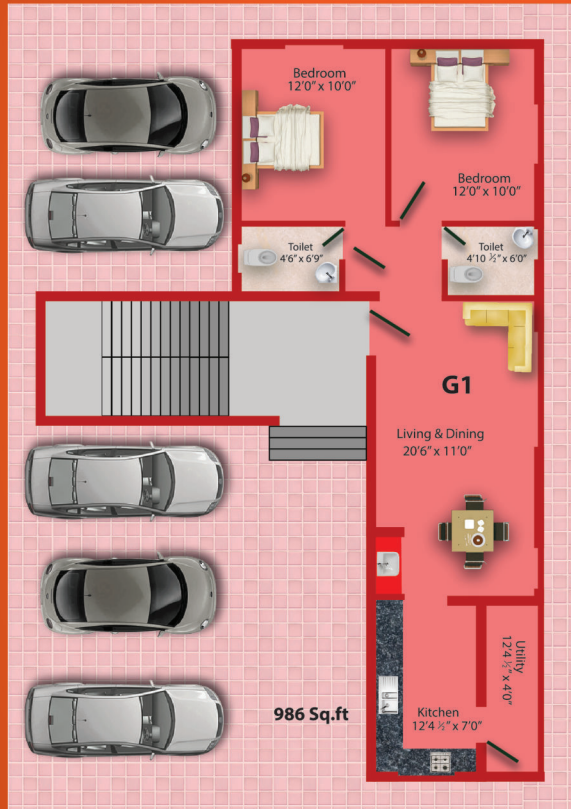

FIRST FLOOR PLAN

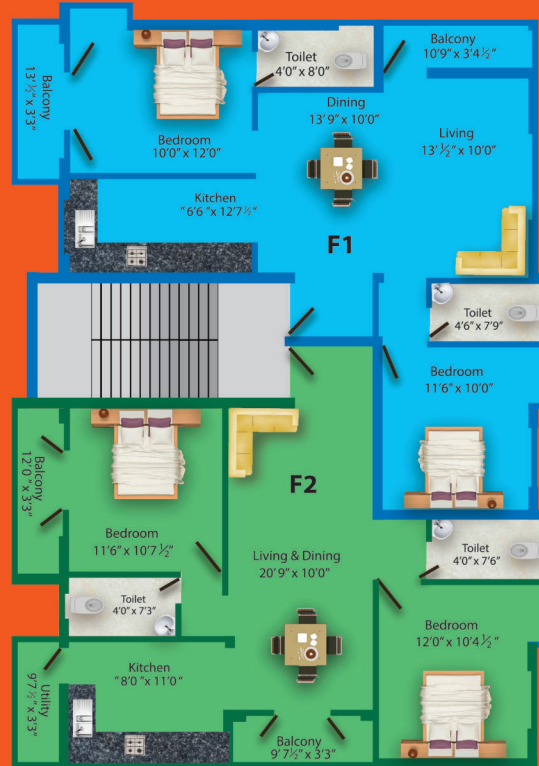

SECOND FLOOR PLAN

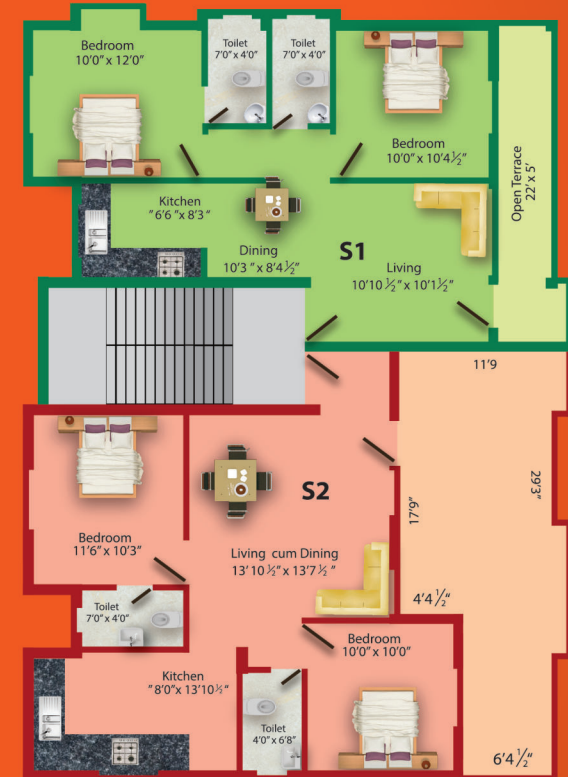

Ground floor

G1 986 sq.ft

1st Floor

F1 1043 sq.ft

F2 1045 sq.ft

2nd Floor

S1 774 sq.ft

S2 874 sq.ft

SPECIFICATIONS

1. Architecturally & Structurally designed flats
2. Loft and cub-boards in Bedroom and Kitchen
3. Rain water harvesting
4. Water proofing & Anti-termite treatment
5. Bore-well with motor pump
6. Compound wall with designed gate
7. Clear title
8. Easy housing loan with tax benefits
9. Covered car parking
10. Safety grills at the main doors & Sit-outs

FLOORING

1. Floors: Vitrified tiles of 24" x 24" size for entire floor
2. Toilet: Glazed tiles for walls upto 7' and anti-skid tiles for flooring
3. Kitchen: Granite top platform with stainless steel sink & glazed tile above platform upto 2' height

PLUMBING

1. EWC with flush tank in attached Toilets
2. IWC in common Toilets
3. Wall mixer taps
4. Wash basin in attached Toilets and Dining

PAINTING

1. Emulsion paint for Interior & Exterior
2. Varnish for main doors
3. Synthetic enamel paint for wooden surface

ELECTRICAL

1. Three phase supply
2. Phase change over switch & 4 pole isolator in main board
3. Cables & modular switches with ISI grade
4. Telephone point in living & Master Bedroom
5. TV point in living & master Bedroom
6. AC point in all Bedrooms
7. Geyser point in all Bathroom
8. Exhaust fan point in Toilet and Kitchen

CARPENTRY

1. Teak wood frames with teak wood solid doors for main doors
2. Designer skin door for Bedroom
3. Polymer coated flush door for Toilets
4. Country wood framed glazed shutters for all shutters

PAYMENT

1. Advance of Rs.2,00,000 on booking of an unit
2. 45% of the sales consideration at the time of registration
3. 15% on completion of foundation work
4. 12.5% on completion of floor slab
5. 12.5% on completion of brick work
6. 10% on completion of plastering and wood work
7. 5% on completion of entire work

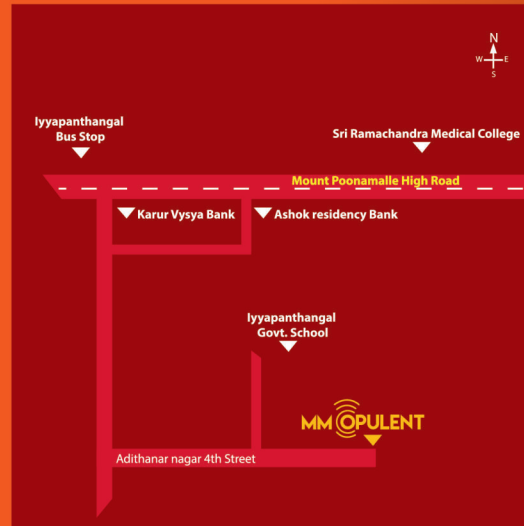

Site Address:
Plot No 3&4, Lakshmi Nagar,
Kumaran Avenue, Iyyapanthagal,
Chennai - 600056



ISO 9001-2008 Certified Company



MS CHARAN™
CREATING VALUES

25
years
of excellence

MM OPULENT
2 Bhk luxury Apartment



Site Address: Plot No 3&4, Lakshmi Nagar, Kumaran Avenue,
Iyyapanthagal, Chennai - 600056

MS CHARAN BUILDERS (P) LTD.

95511 15560 / 99625 55116 / 74011 44777

10, Garden Avenue, Officers Colony Extn.,
Chennai - 600050. Tel.: +91-044-26541027
e-mail: info@mscharanbuilders.com
Website: www.mscharanbuilders.com



ISO 9001-2008 Certified Company



MS CHARAN™
CREATING VALUES

MS Charan Builders (P) Ltd.

95511 15560 / 99625 55116 / 74011 44777

10, Garden Avenue, Officers Colony Extn., Chennai - 600050. Tel.: +91-044-26541027
e-mail: info@mscharanbuilders.com, www.mscharanbuilders.com