

॥ दर्शनम् ॥<sup>®</sup>  
ANTILIA



Home that you  
Dream of...



2 & 3 BHK LUXURIOUS DUPLEXES

GROUND FLOOR



A-TYPE



A1-TYPE



A2-TYPE

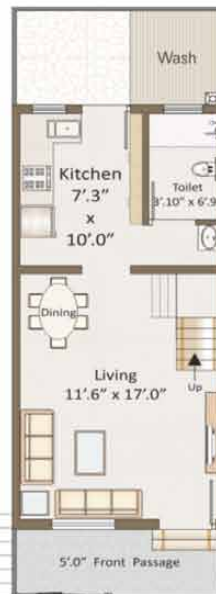

# FIRST FLOOR

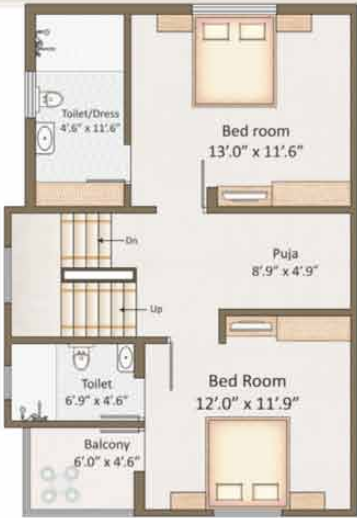

Plot Area : 827.00 sq.ft.  
S.B.A. : 1275.00 sq.ft.



Type your text



Plot Area : 670.00 sq.ft.  
S.B.A. : 1150.00 sq.ft.

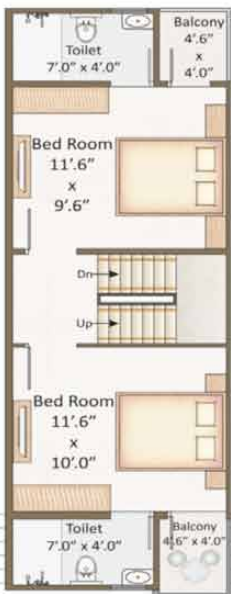

Plot Area : 509.00 sq.ft.  
S.B.A. : 1000.00 sq.ft.



**Mode of Payment :**

- 25% At Booking - 15% Plinth Level - 20% G.F. Slab Level
- 15% F.F. Slab Level - 15% Plaster Level - 10% Flooring Level

**KEY PLAN**



**॥ दर्शनम् ॥<sup>®</sup>**  
**ANTILIA**

**SPECIFICATION**

**Construction :** All RCC & Brick Masonry work as per architect design compound wall with fabricated gate

**Flooring :** Vitrified Flooring, Black Granite kitchen platform with S.S. square sink and glazed tile upto lintel level  
Parking tiles flooring in parking area

**Finishing :**  
Inside : smooth plaster with distemper  
Outside : Sandface plaster with cement paint

**Electrication :** Concealed copper wiring of approved quality with TV., Refrigerator, Geyzer points & A.C. point

**Plumbing :** Hot & Cold plumbing with shower & geyzer point in toilet  
Overhead & Underground water tank

**Doors :** Decorative main door & all other flush doors with wooden frames

**Window :** Fully glazed aluminum window with MS safety bar

**J.M.BUILDERS**

"Darshanam Antilia" Nr. Palms Residency,  
Nr. Vaishnav Park, Opp. M.M.Vora Showroom,  
Soma Talav Char Rasta, Dabholi Road, **Vadodra**. Ph.:+91 6359004848  
Log on at : [www.darshanam.co.in](http://www.darshanam.co.in) - Email at : [info@darshanam.co.in](mailto:info@darshanam.co.in)

**Architect : Disha Architect**

- Garden
- Children Play Area
- Gazebo
- Parent's Sitting
- Basket Ball
- Game only
- Water Body
- Jogging Track
- Water Body
- Jogging Track
- Water Body
- Jogging Track
- Gazebo
- Senior Sitting
- Amphitheatre



\*Gazebo for Get-to-Gather, Yoga, Meditation \* Water Feature with Fountain \*Children Play Area with Sand Pit  
\*Senior Citizen Park\*Jogging Track \*Multipurpose Court \*Large Lush Green Garde \*Main Gate with Security cabin