



# Parijaat

happiness for everyone  
2 BHK beautiful homes





### **Amenities and salient Features**

- Earthquake resistant RCC structure with good quality brickwork for walls.
- External 6" & internal 4" thick brickwork.
- External double coat sponge plaster and internal single coat smooth plaster with neeru finish.
- Vitrified Flooring with skirting.
- Granite Kitchen Platform with stainless steel sink and 4 ft & glazed dado tiles.
- Glazed tiles up to 7 ft. in toilets.
- Main door frame in hard wood and rest in pre-cast panels.
- Main door shall be in laminated flush door, with high quality brass fittings, night latch, magic eye and safety lock. All other doors shall be in oil paint flush door.
- Windows shall have Green marble frames with three track aluminum shutter with mosquito net and safety grill.
- Concealed electrification with TV, Telephone, Geyser points & ISI modular switches.
- Concealed plumbing with high quality of sanitary and bath fittings.
- Lift with battery back-up.
- Aqua guard and Washing machine point will be provided in the kitchen.
- All door, window grills shall be painted with oil paint.
- Externally apartment shall be painted with high quality washable paint and internally with oil bound distemper.
- Terrace will be finished in IPS cement flooring.
- Provision for Name plate installation.
- Parking facility with chequered tiles or concrete paver blocks.
- Rain water harvesting for re- charging of bore wells.
- Municipal water facility.
- Power backup for lift and landing.

# Parijaat

2 BHK beautiful homes





**Parking Floor**  
 Shop Area : 213 sq.ft.

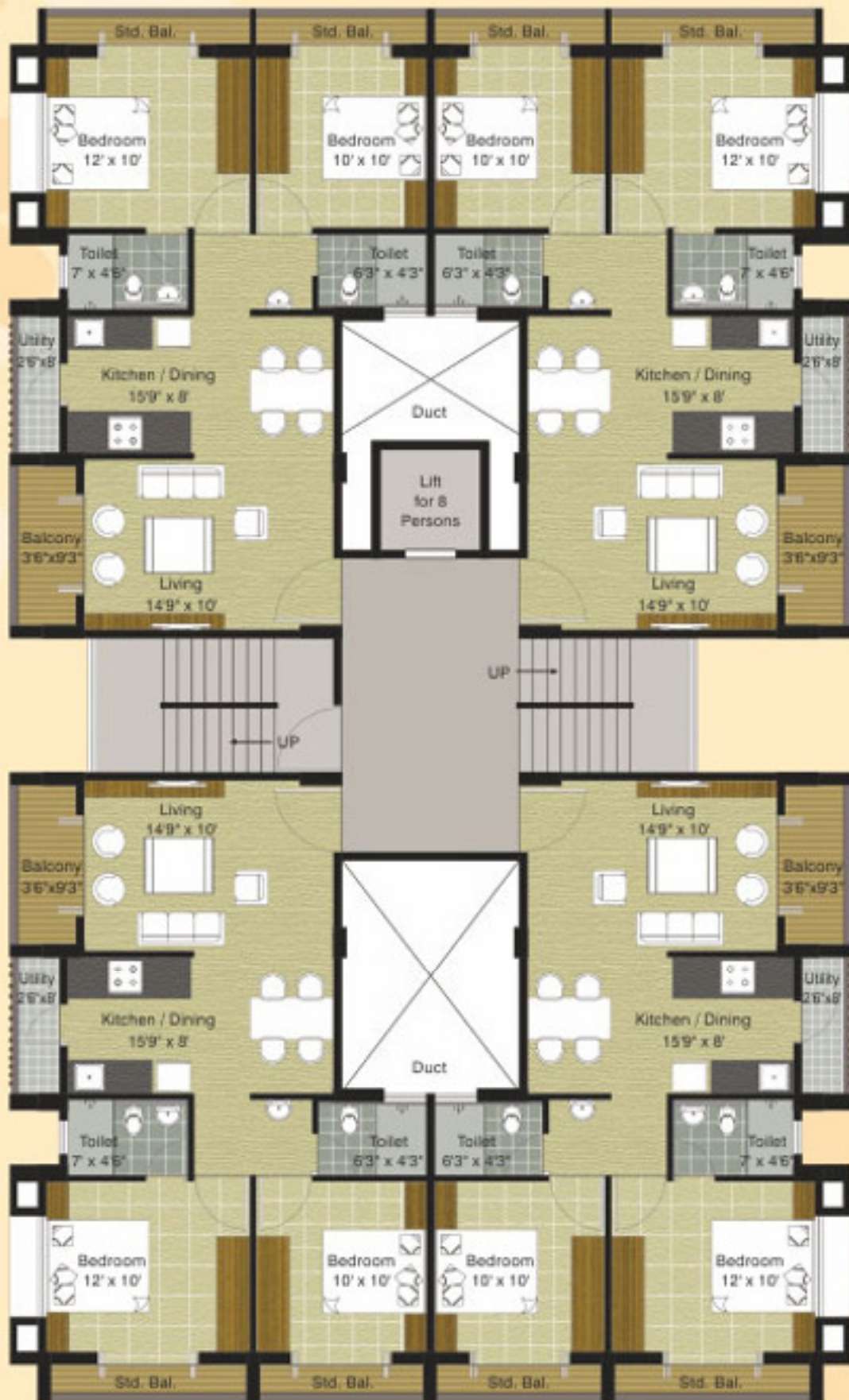

Typical 1st to 6th Floor  
Flat Area : 953 sq.ft.

## Location Plan

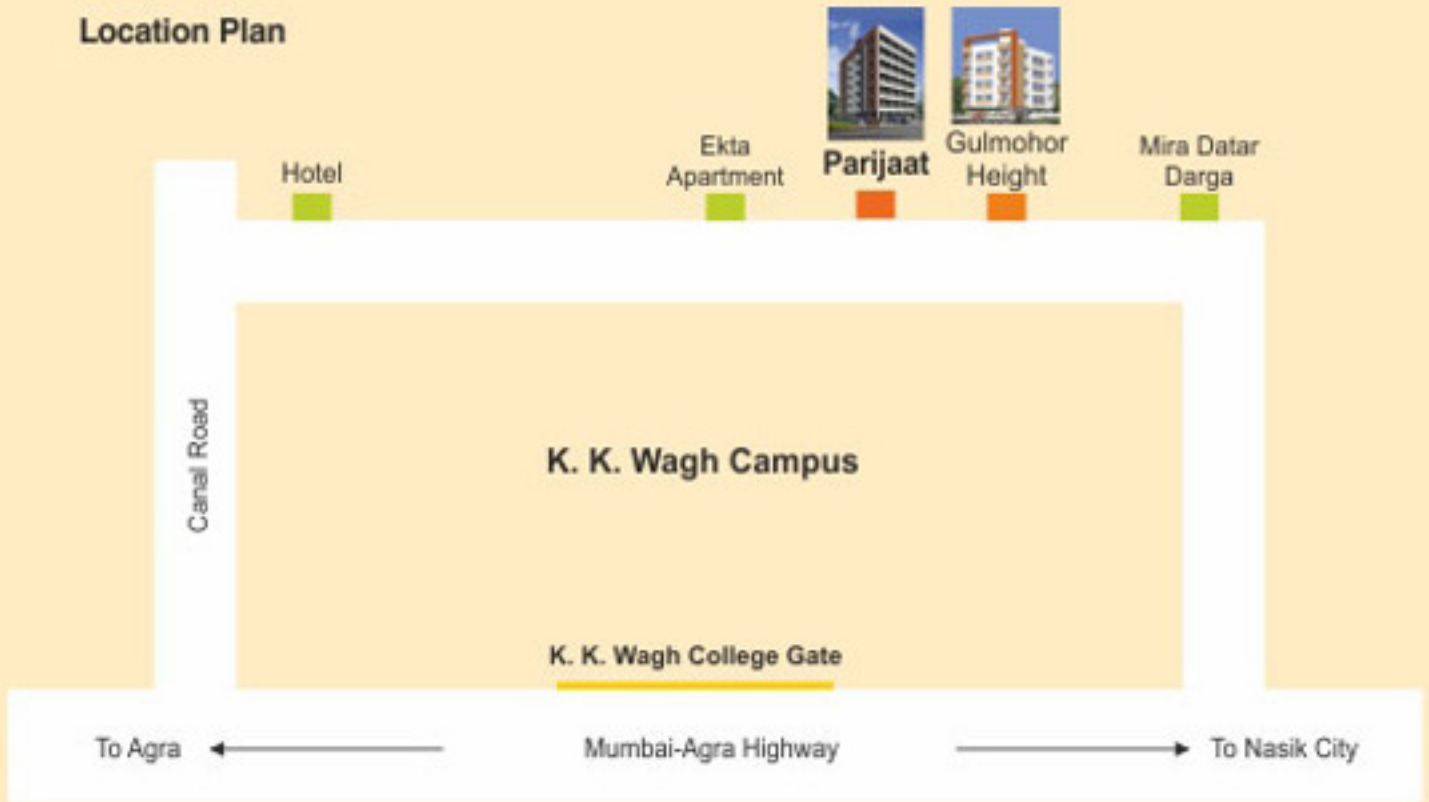

Site : S. No. 279, Plot No. 44, Behind K. K. Wagh College, Near Mira Datar Darga, Nasik.

  
kanaklaxmi developers

"We construct your dreams"

Office Address : 303, Third Floor, Hariprabha Commercial Complex,  
Thatte Nagar, Opp. Neelkamal Marbels, College Road, Nasik.

**For more details, call**

**9823405995, 9225124765**

E-mail : [info@kanaklaxmidewelopers.com](mailto:info@kanaklaxmidewelopers.com), [mohit@kanaklaxmidewelopers.com](mailto:mohit@kanaklaxmidewelopers.com).

Website : [www.kanaklaxmidewelopers.com](http://www.kanaklaxmidewelopers.com)

Architect  
Nitin Kute | Apeksha Kute

RCC Consultant  
Sanjay Ratnaparkhi

Legal Advisor  
Mohan Baxi