

# Life wahi, style naya



Neev  
**BelleVue**  
*Life wahi. Style naya!*

2 & 3 BHK, intelligently-planned homes...  
Malad (E)

## Relationships wahi, romanch naya

Presenting Neev Bellevue. A residential project of 2 BHK apartments and 3 BHK duplex apartments that offers you the lifestyle that you have dreamt of, in the centre of YOUR Universe!

Top-notch amenities. Best specifications. Intelligent planning. Spacious homes. With the same flavour of friendships, celebrations and comfort that you are used to. So that lifestyle bhi great hoga, aur life bhi!

Neev  
**Bellevue**  
*Life wahi. Style naya!*



## Address wahi, andaaz naya

Good-quality life is no more the exclusive privilege of a few locations. Discover it in a neighbourhood that you find familiar. Neev Bellevue is located in a quiet by-lane off Haji Bapu Road in Malad (E).

It is the first project to be developed in an area that is guaranteed to have a completely changed skyline. It's extremely well-connected and surrounded by all the conveniences of modern living. Could you have made a smarter investment?

- International airport – 8 kms
- Domestic airport – 10 kms
- Railway station – 1 km
- Western Express Highway – 3 kms
- Jain Temple – 1 km
- S. V. Road – 3 kms
- Goregaon-Malad Link Road - 2 Kms

### Highlights

#### Internal Amenities

- Decorative cornices in P.O.P for living room, dining and lobby
- 2 high speed elevators with generator back-up
- French windows
- Granite kitchen platform with stainless steel sink
- Concealed plumbing of top-notch quality such as Jaguar

#### External Conveniences

- Well-equipped gymnasium
- Fully-furnished society office
- Ample car parking
- Rainwater harvesting
- Intercom facility with video door phone and CCTV
- Spacious and attractive lobby





# Area wahi, space naya

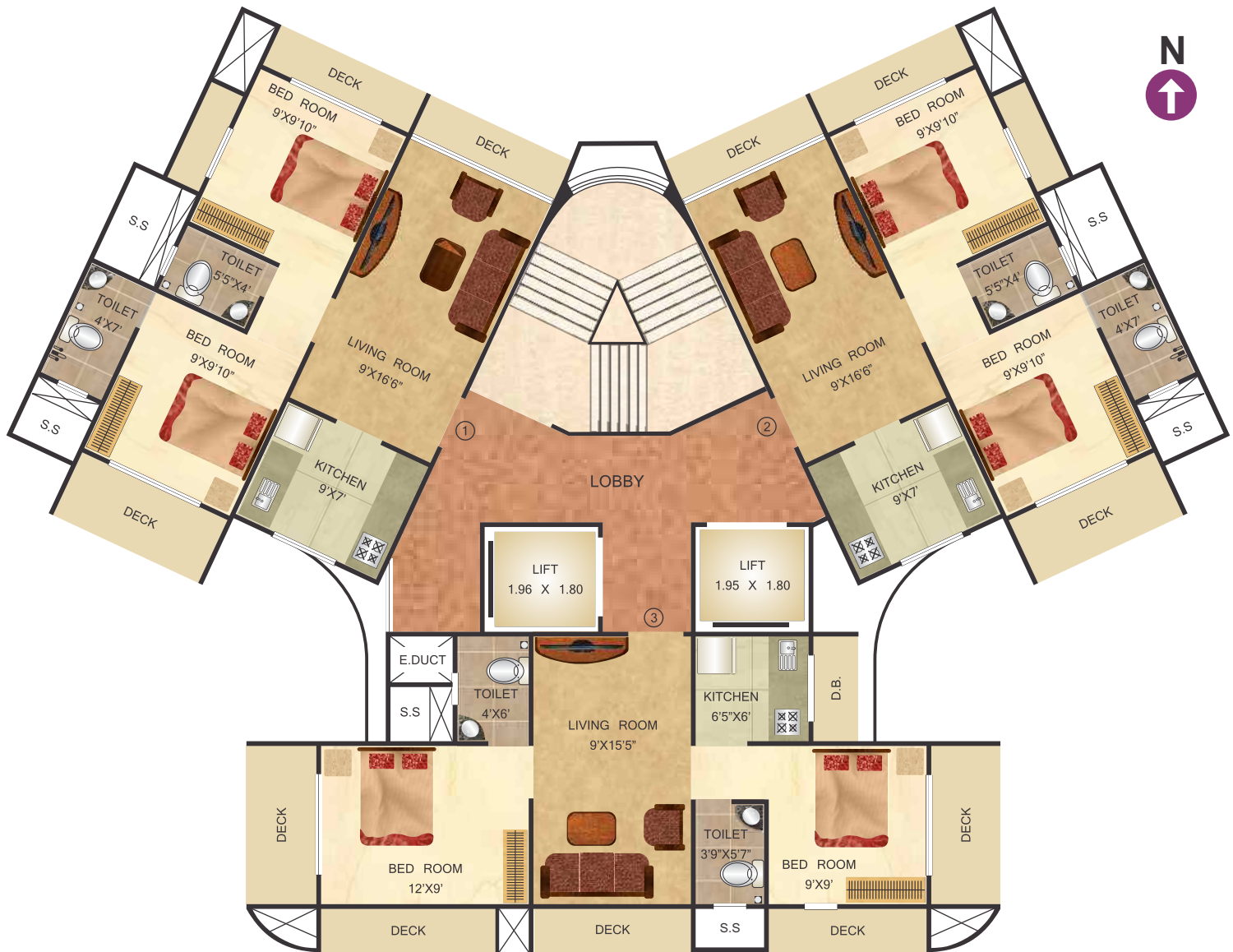

Typical Floor Plan

## Values wahi, vishwas naya

Neev, which means foundation, is the motivating factor that has always animated the Group's corporate philosophy, given shape to the vision of its founding fathers, and a sense of purpose to its current enterprise. That is why, for three decades, the Neev Group has been taking community living to the next level by building and developing high-quality living, working and infraspaces in western and southern India.

The foundation of the remarkable reputation Neev has built constitutes timely delivery, transparent transactions and top-notch services. Besides, the Group is also known for its commitment to sustainable development. Could you have found anyone with better credentials?



## Neighbourhood wahi, impact naya

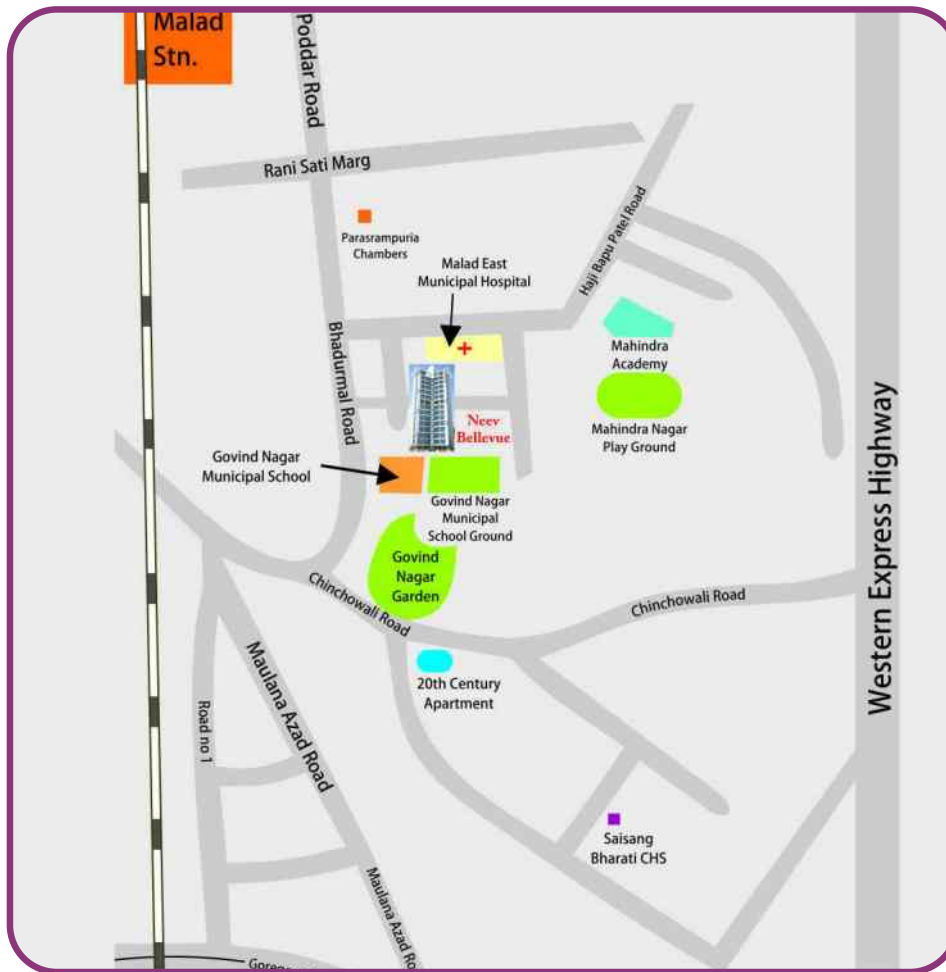

Site: Haji Babu Road, Upper Govindnagar, Malad (East), Mumbai.

Architect - Abhijit Mehta

RCC Consultant - Struct Bombay Consultants

Legal Advisor - Advocate Dharmesh Joshi



Corporate Office:

Neev Group of Companies, Neev Vittoria, Nesbit Road, Next to Mazgaon Sales Tax Office, Mumbai - 400 010.  
Tel: +91 22 61455555 | Fax: +91 22 61455566 | email: [bellevue@neev.co.in](mailto:bellevue@neev.co.in)

Branch Office:

Plot No. 35 Sumati Sadan, Prarthana Samaj Road, Vile Parle (E), Mumbai - 57.

\*Disclaimer - The information in this brochure is indicative of the kind of development that is proposed and it is purely conceptual and not a legal offering. Subject to approval of the concerned authorities, the developers reserve the right to change, alter the layout, plans, specifications, or features without prior notice or obligation.