



PRAJAY

Prajay Engineers Syndicate Ltd.

Corporate office
Plot No. 1091 A, Road No. 41, Near Peddamma Temple
Jubilee Hills, Hyderabad - 500 033.
Phone: +91-40-66222999, Fax: +91-40-66222966
E-mail: sales@prajayengineers.com

This brochure is only a conceptual presentation and not legal offering. The promoters reserve the right to make changes in the elevations, specifications and plans as deemed fit. All route maps are not to scale. All measurements to be converted and read in metric system.

Mark Communications@9000620002



We will make your home stand out



Where dreams come home...

Imagine the deafening blast of pneumatic vehicle horns, or the racket of autorickshaw, or even, the shrill calls of a roadside vendor, and then, we will introduce you to a place where all this will indeed be only part of your imagination.

Prajay Homes Extension Satellite Township, located near Shamirpet, has been conceived as a affordable gated residential enclave of Independent houses that offers a secluded retreat from the hurly burly of the city. Laid out with a special emphasis on openness of space, also adhering to ancient Indian architectural system of Vaastu.

Only 27% of land area is built up with rest being open, thus offering residents the luxury of a home that is surrounded by nature's bounty.

Among all the modern amenities and contemporary facilities that are characteristic of an exclusive enclave like Prajay Homes, what you will appreciate the most, is the fresh, pollution free air and the silence of sanity this beautiful piece of paradise offer.

Expandable Independent Houses



In keeping with our philosophy and the changing life standards, Prajay Homes Extn. Satellite Township has conceived and designed affordable and stylish independent houses, a total of 880 sq.ft in 200 sq. Yds. This expandable houses are specially designed keeping in view family requiring to extend at any stage to built one or two additional floors, for which external staircase is provided. Prajay Homes Extn. Satellite Township is endowed with all the requisite necessities, comforts and luxuries to make day to day living a pleasant experience for the whole family.

Precisely planned for the modern day city dwellers, a pollution free living environment and wide open areas that offer not just luxury of space, but peace of mind as well.

Quality living from the team that cares



Ground floor plan 880 sq.ft

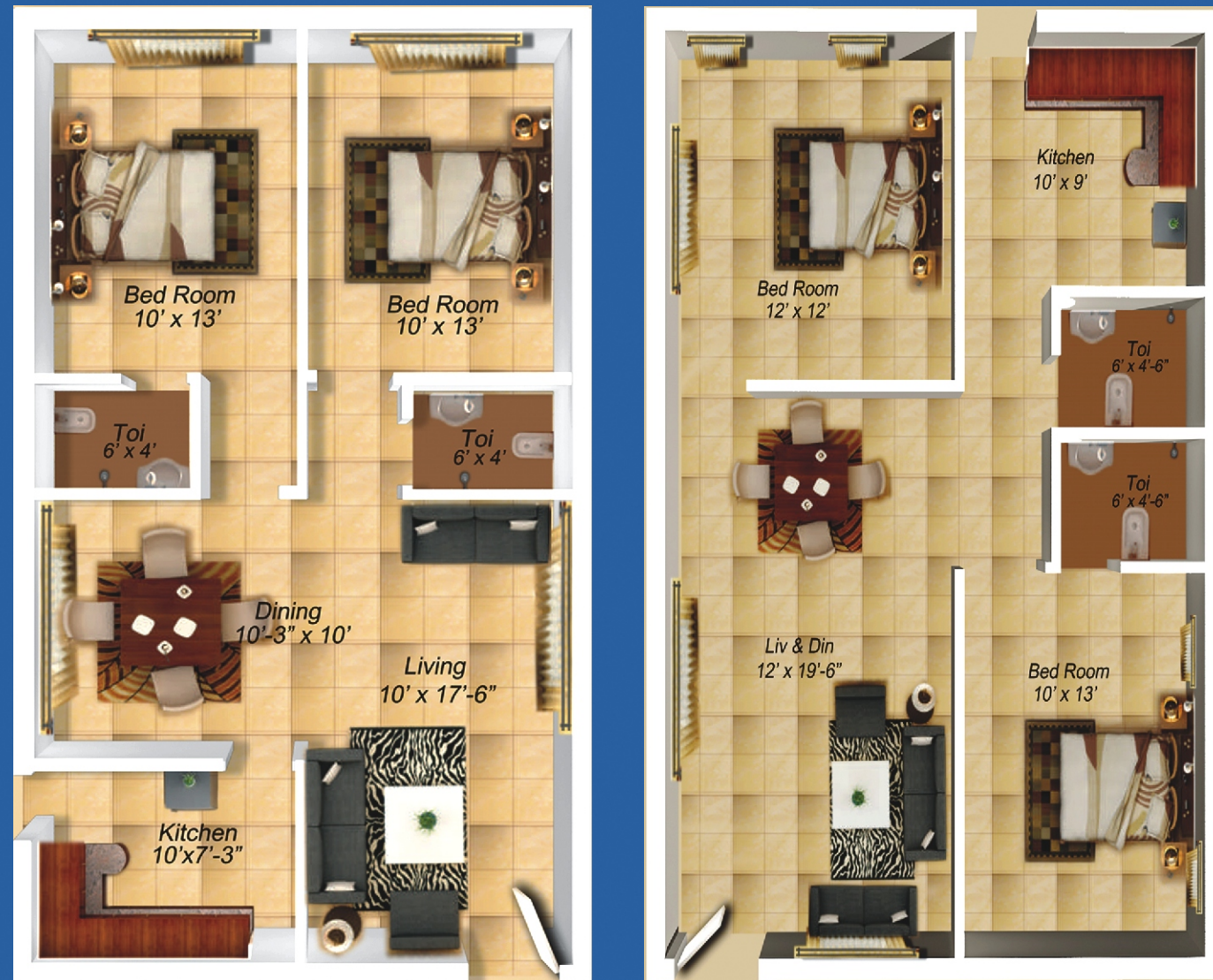

East Facing

West Facing

Forty East Facing Luxury Signature Apartments



Prajay Homes Extn. a Satellite Township, is located at Shamirpet. Glide to the rhythm of nature with one of the classiest yet affordable, of Hyderabad residential properties, the Prajay Homes Extn. Satellite Township, designed for those who believe in the comforting yet spirited vigor of nature, these beautiful homes in Hyderabad, welcome you to serene surroundings' and modern interior designs.

Situated in close proximity to Celebrity Club and having prestigious neighborhood, these unique two bedroom apartments of 885 sft. are being build in Phase II. These flats come equipped with all modern amenities, while the enclave itself boasts of recreational facilities for your comfort.



Layout permit No: 37927/LRS/P4/H/2010
Dated : 31/12/2010



Forty East Facing Luxury Signature Apartments

Site Layout

(Not to Scale)

Prajay Homes Extension Phase - II





2 BHK Floor Plans - 885 sq.ft

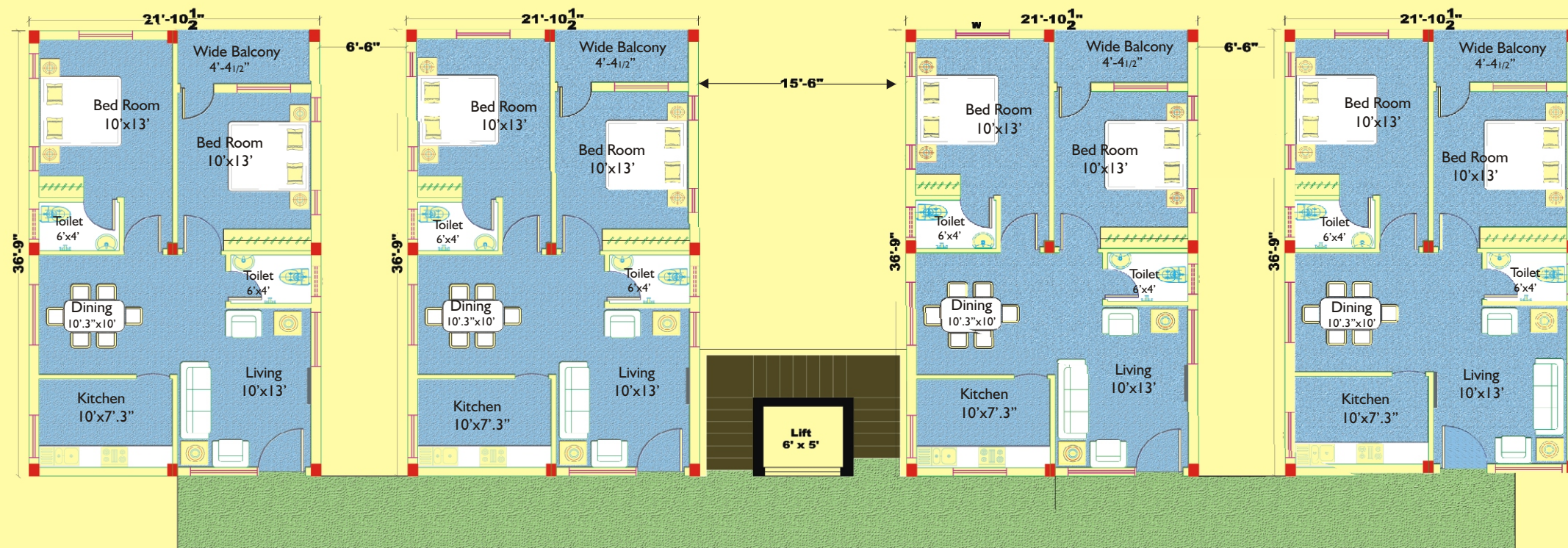

Specifications

Frame work	: RCC Framed Structure
Super Structure	: Table- moulded brick masonry
Doors	: Designer Main Flush Door with Teak veneer as per the Architects drawing. Internal Doors- Flush door with one side Teak veneer, and other side painted.
Windows	: Powder coated aluminum windows/ UPVC windows
Flooring	: Vitrified tile flooring with skirting in living/ dining and all bedrooms. Anti-skid ceramic tile flooring in toilets, balconies & Utility areas, Paver blocks for car parking
Kitchen	: Granite counter with ceramic tile dado up to 2' above the counter and Laminated shutters under it with Stainless steel sink (Single bowl, Single drain), ceramic tile cladding in the wash area.
Wall finishes	: All interior walls with smooth finish and Acrylic emulsion paint over top Brand
Toilets / Baths	: European style WC's, toilet accessories, wash basin of leading brands. Provision for shower panels as per design.
Power	: Concealed copper wiring of standard make. Power plugs in all necessary Areas, electrical fittings & fixtures of well renowned brand.
Communication	: Telephone & Internet points in all bedrooms, living room, family & dining rooms
Cable	: Provisions for cable TV in living room and all bedrooms.
Generator DG back up	: Stand-by power for common amenities.
Water	: Provision for Metro water supply
Common Services	: Power back-up for street lighting, concealed underground cabling for power and communication. Water supply for total township.
Parking	: Separate Car Parking facility provided in the Apartment Blocks.



You deserve the best

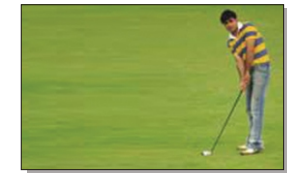

Location – Shamirpet

Prajay Homes Extn. Satellite Township is located in the most sublime setting near Shamirpet, Hyderabad, right next to picturesque lake. The area is fast emerging as a lifestyle destination and is close proximity to Hyderabad's emerging Biotech Hubs and top notch multinational corporations like Zenotech, SP Biotech, ICICI Knowledge Park, Alexandria and convenience of many prestigious Schools, Colleges, Hospitals etc. Besides, Shamirpet offers the much needed peace and tranquility in today's stress-filled life. The extensive landscaping of Prajay Homes Extn. Satellite Township brings you an alluring hues of green, showing the way to live the privileged life in the very lap of Nature.



Move in at Hyderabad's finest address...

Owners entitled for Celebrity Club Memberships*

Now house owners are entitled for free membership at the Celebrity Club, Shamirpet, the one stop facility to help you relax, refresh and rejuvenate yourself thoroughly. It's a comprehensive modernistic get away destination located in tranquil surroundings with loads of greenery. This apart, a great range of indoor as well as outdoor leisure pursuits can be accessed here.

* Conditions Apply