

Builders & Promoters

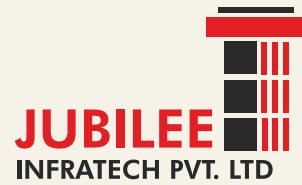

2-1-740, Flat No.10, Manohar Apts. O.U. Main Road,  
Vidyanaagar, Hyderabad-44. Ph: 27673127,  
Mobile: 98487 45528, 98480 45527.

[www.jubileeinfra.com](http://www.jubileeinfra.com)

Designed by FhMV : +91-924652471 [www.fhmv.org](http://www.fhmv.org)



A nighttime photograph of the Cyber Grande complex in Hyderabad, India. The image shows several modern buildings, including a prominent circular structure with a glass dome, illuminated against a dark blue twilight sky. The lights from the buildings and streetlights are reflected in the calm water of a lake in the foreground. The overall scene is vibrant and modern.

*Jubilee*  
**Cyber Grande**

## *Homes with a view*

Fine living has many aspects. Of course, the foremost is your love for good things in life. Then everything else springs from where you live! Homes that offer you exclusivity, class, convenience and luxury that stretch beyond your imagination. Together they add a whole new dimension to life – happiness, beyond description.

Cyber Grande are 3 BHK homes where all the above finest elements are blended to offer you living, elevated to a higher sphere. These homes are intended for today's highfliers who carry an air of confidence and an aura of supremacy. Naturally, their homes have to be in the hottest spot of the city. And they are - at Madhapur, overlooking Durgam Cheruvu! Standing in the middle of the most sizzling location of the city, these five story apartments combine ultra-modern architecture with uber-chic designing concepts and prudent planning.

Get ready for the romance of Cyber Grande





▲ Courtyard View

## Bordering beauty and business

Cyber Grande has a beauty spot right in front of its nose – Lake Durgam Cheruvu – a heaven for tourists and youth who have a smile on their lips and a song in their heart.

The 63 acres of tranquil blue waters framed by 2500 mn. years old sheets of solid rock, is a geographical marvel. At Cyber Grande, this live picture post card is yours forever, if you are lucky enough to grab an apartment in the higher floors. In

any case, you are next to the most picturesque spot in the city. And, the project is in the IT hub surrounded by high-end residences and close to Cyber Towers, Raheja Mind Space, NIFT, Inorbit Mall and many other prominent land marks.



# Layout Plan

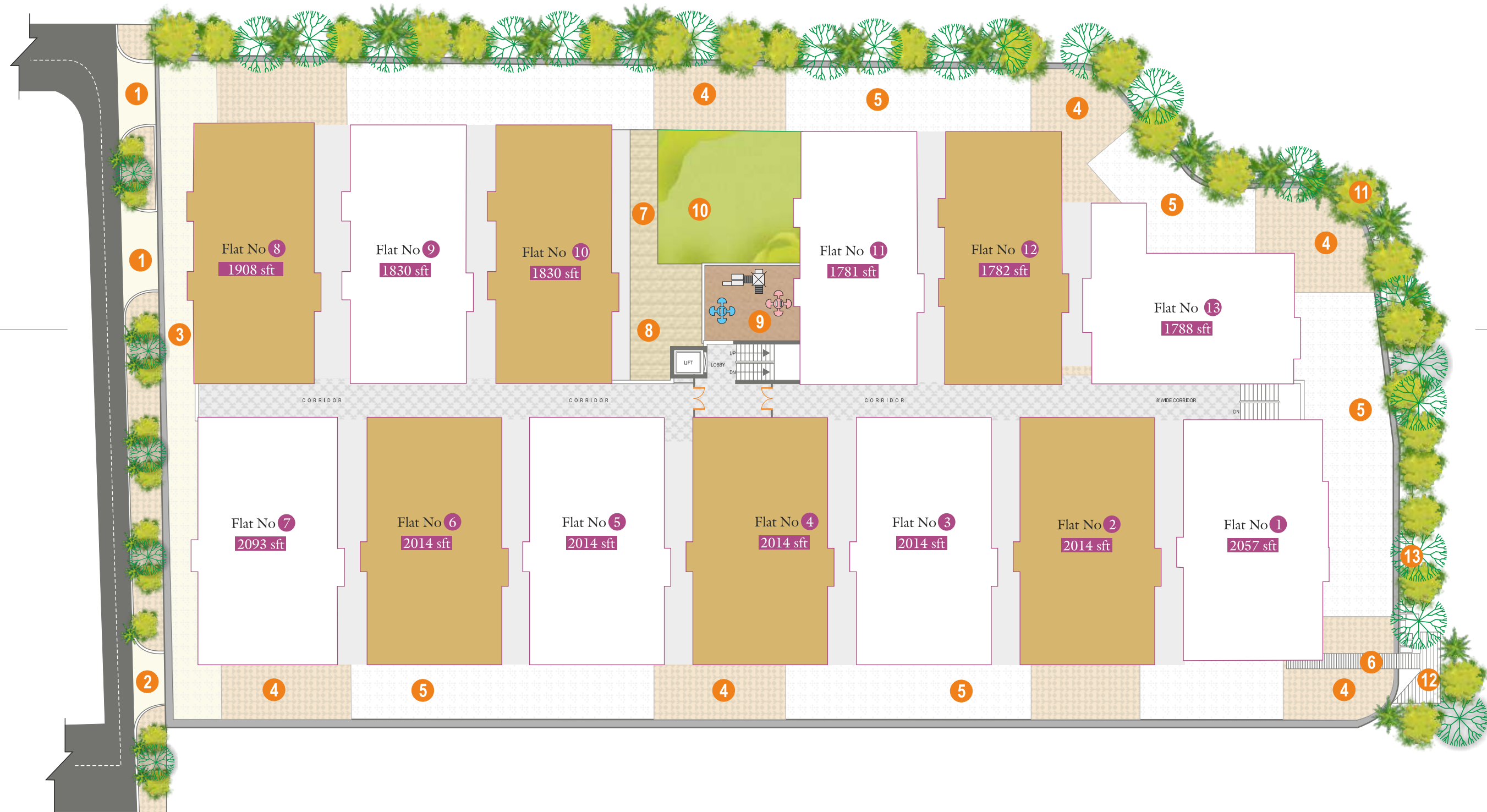

## Legend

1. ENTRY

2. EXIT

3. COMBI PAVERS

4. TERRACOTTA PAVERS

5. V.D.F FLOORING

6. TERRACOTTA TILE BAND

7. OPEN SPACE ENTRANCE

8. SEATING DECK

9. CHILDREN'S PLAY AREA

10. LAWN

11. SCREEN WALL

12. GRID PLANTATION

13. STEPPING STONE

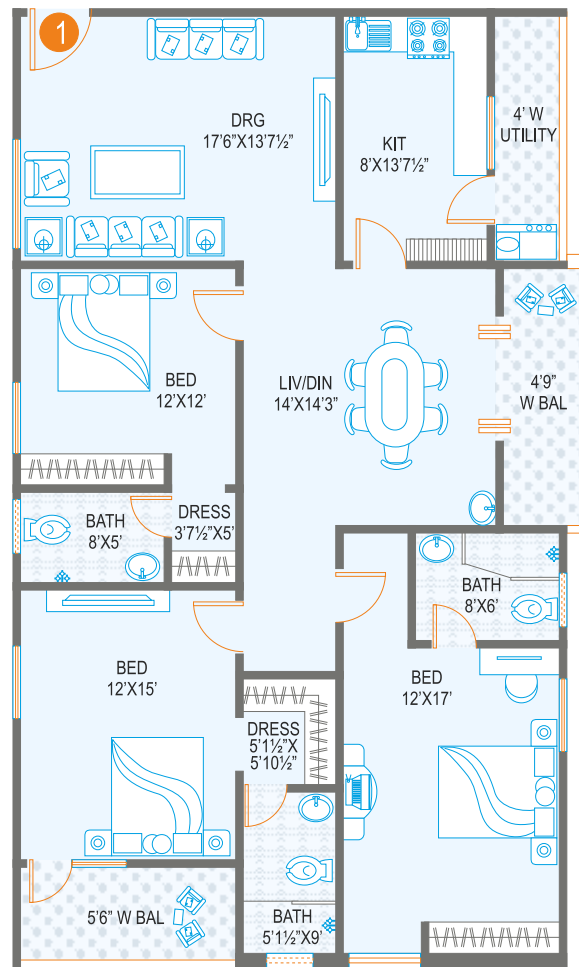

Flat No. 1  
Area 2057 sft

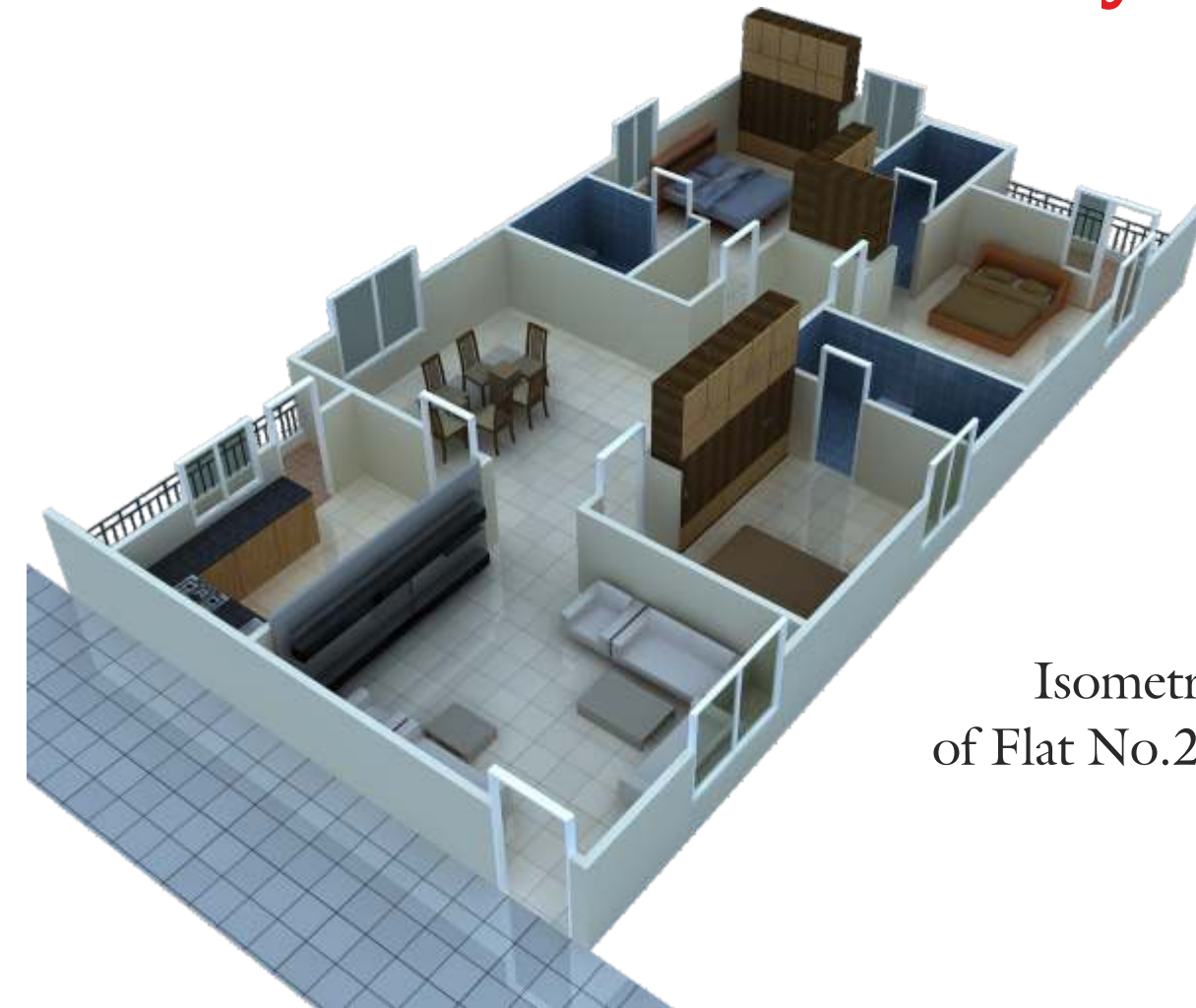
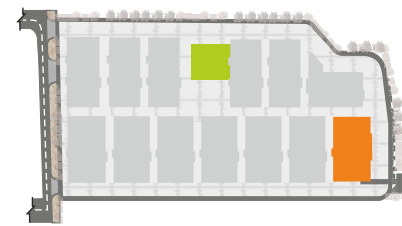

Isometric View  
of Flat No.2, 3, 4, 5 & 6



Isometric View  
of Flat No.1

Flat No. 2, 3, 4, 5 & 6  
Area 2014 sft

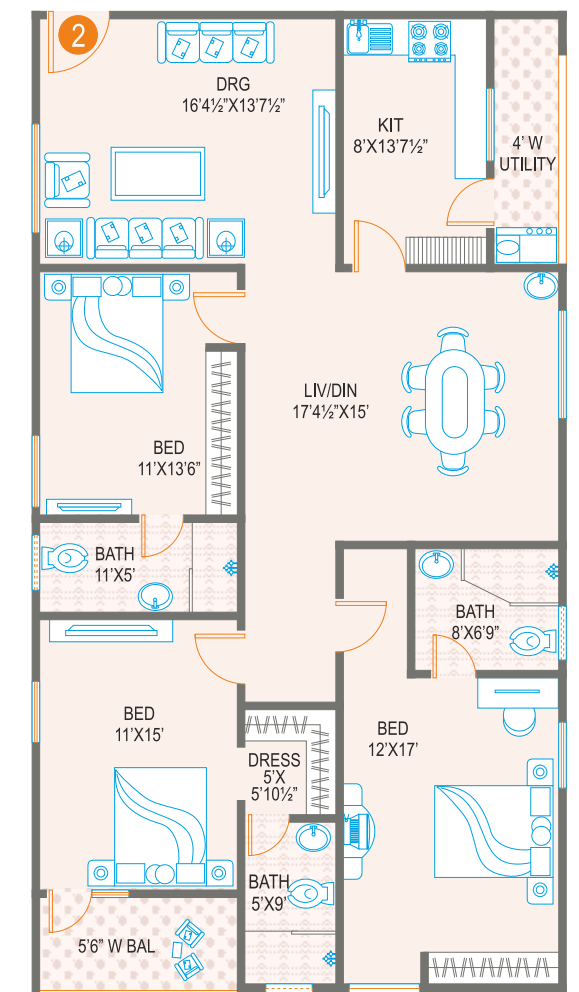
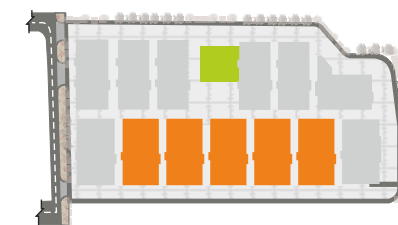

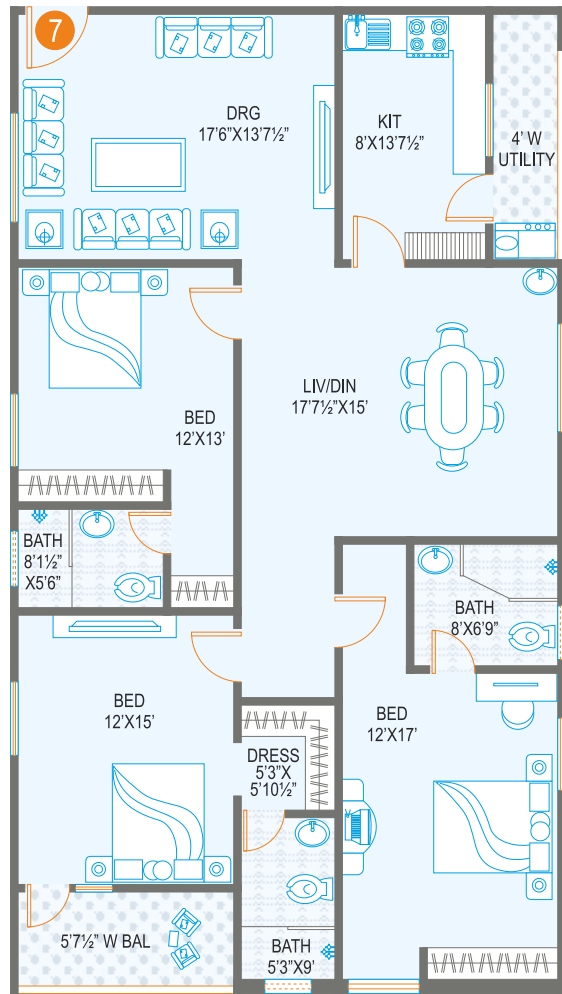

Flat No. 7  
Area 2093 sft

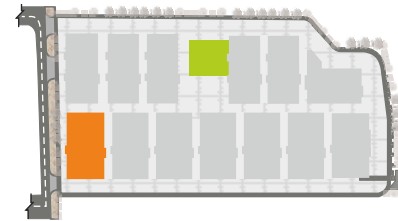

Isometric View  
of Flat No. 8



Isometric View  
of Flat No. 7

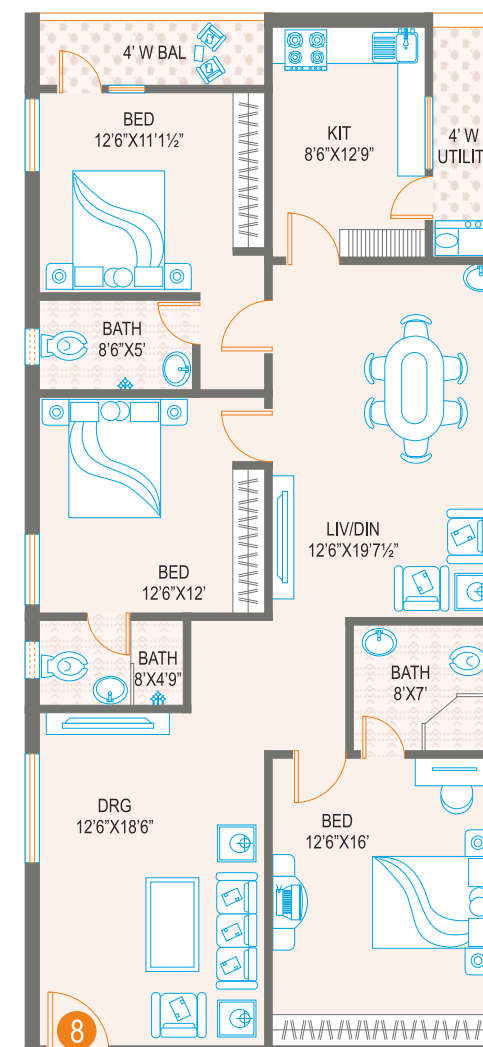

Flat No. 8  
Area 1908 sft

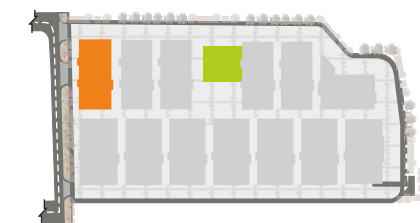

Isometric View  
of Flat No. 9 & 10

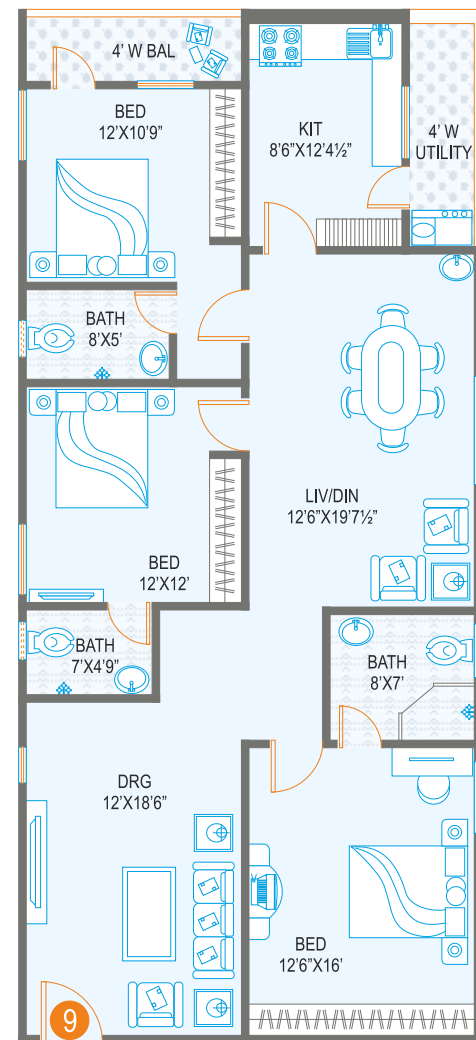
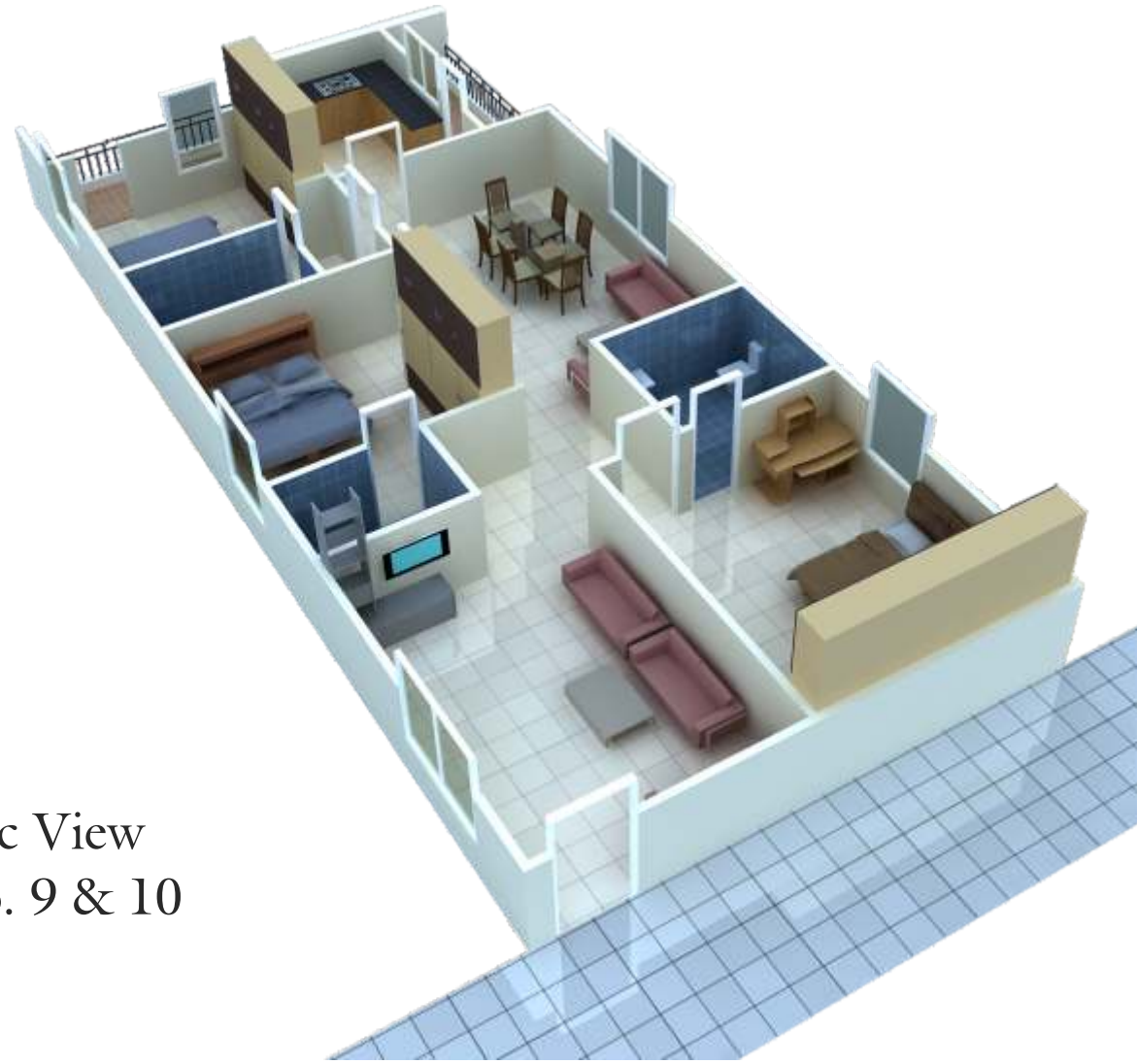

Flat No. 9 & 10  
Area 1830 sft

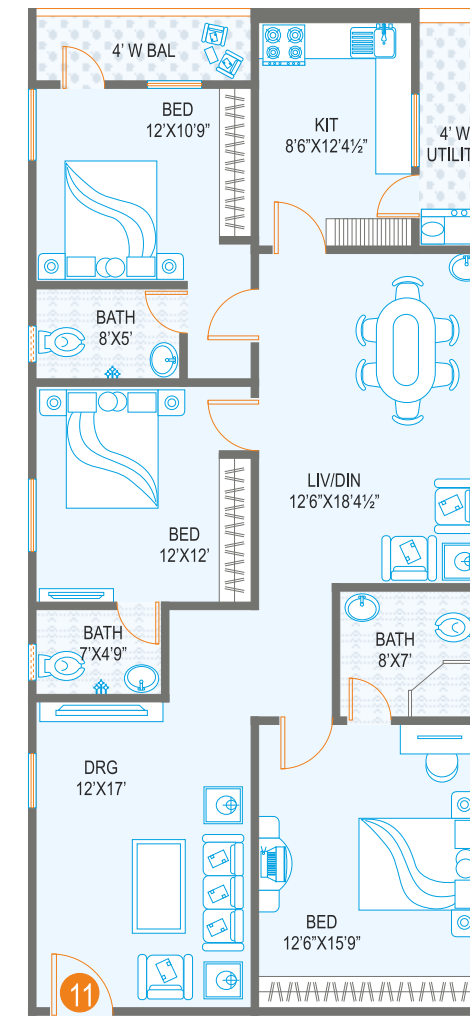
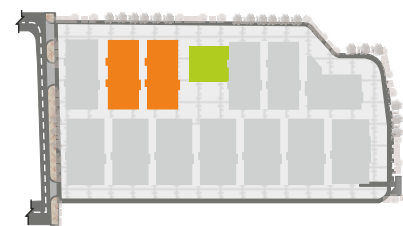

Flat No. 11  
Area 1781 sft

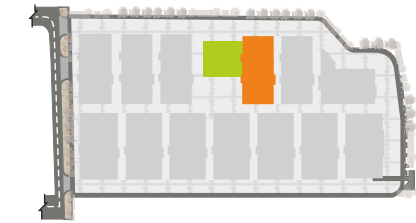

Isometric View  
of Flat No. 11

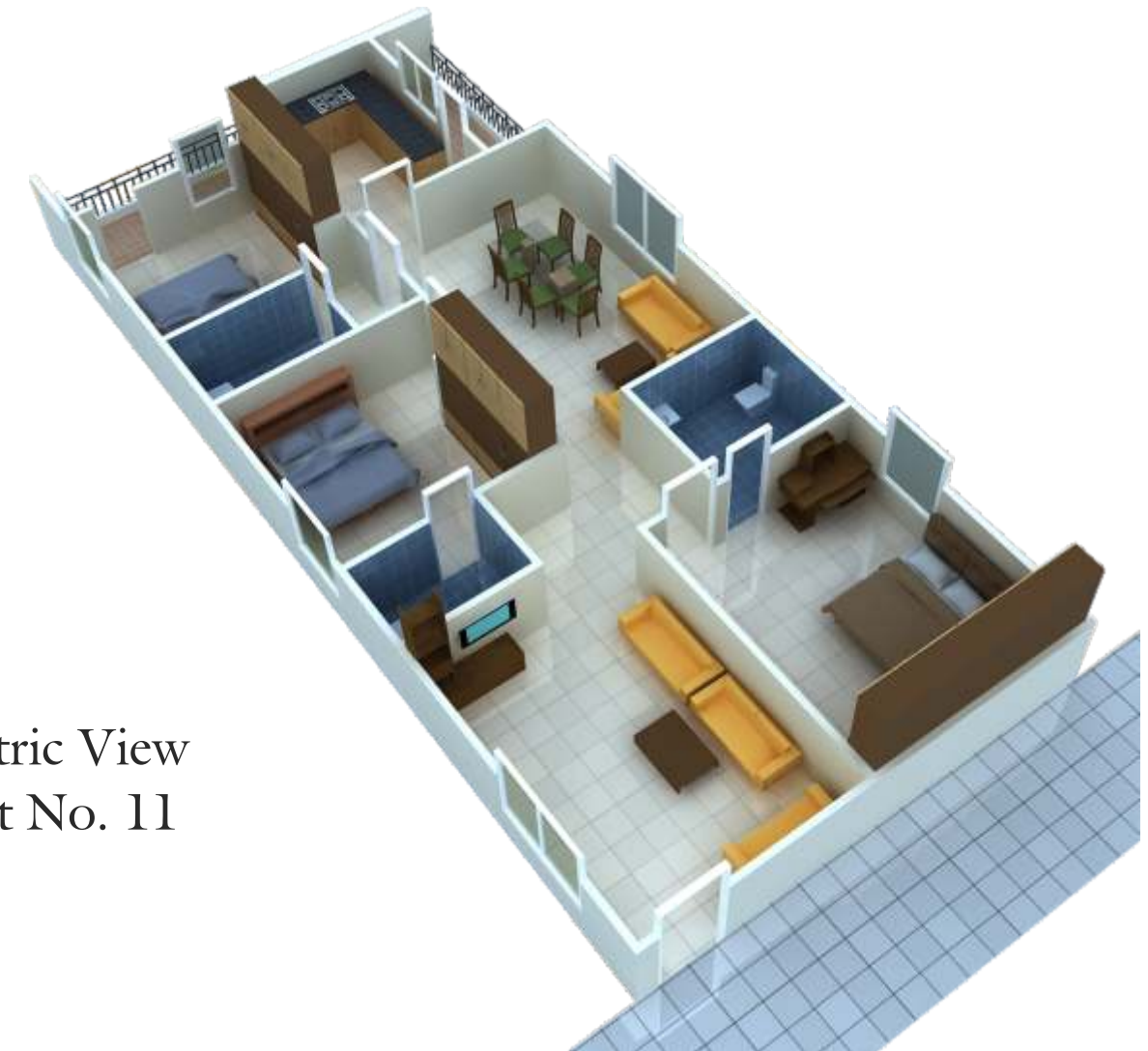



Flat No. 13  
Area 1788 sft

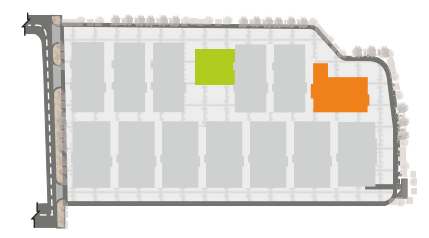
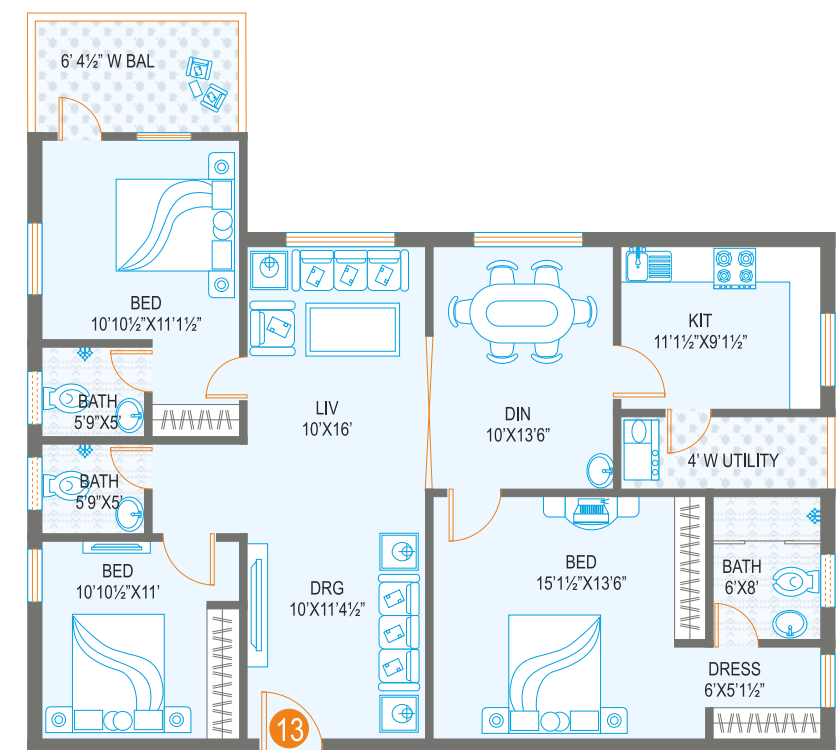

Isometric View  
of Flat No. 12

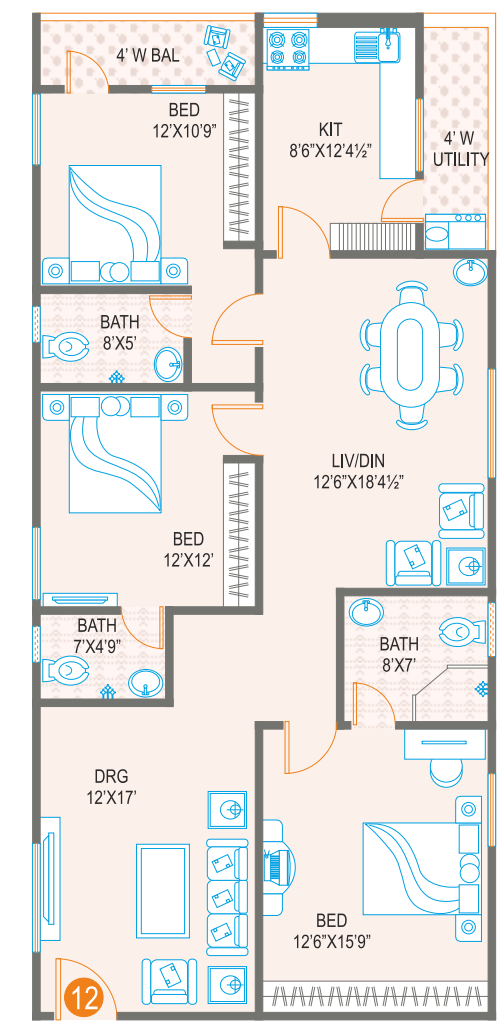
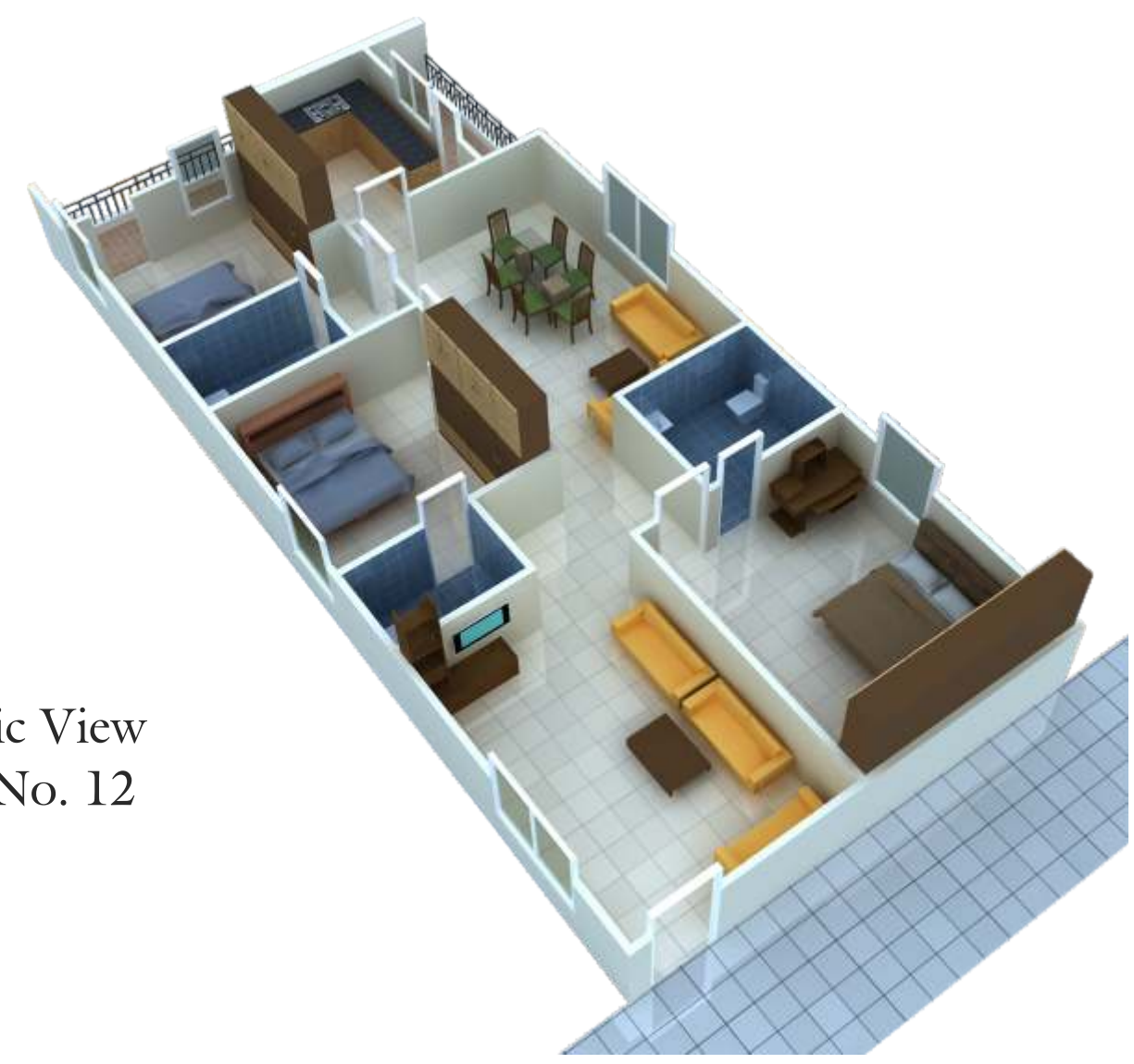

Flat No. 12  
Area 1782 sft

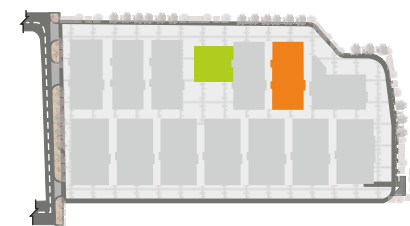

Isometric View  
of Flat No. 13

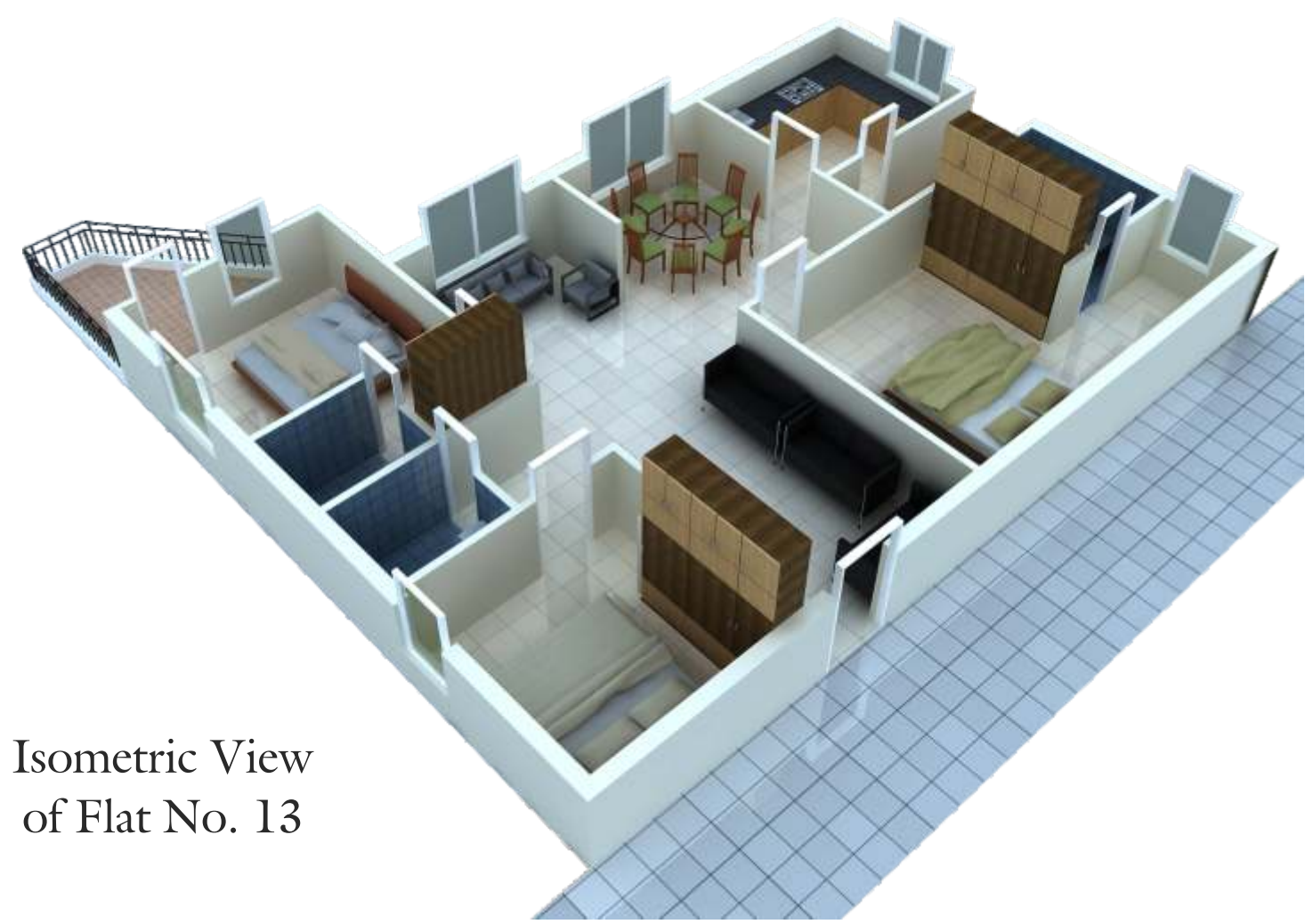

# Specifications

<b>Structure</b>	: R.C.C framed structure with table moulded bricks in cement mortar.
<b>Wall Finishes</b> <b>Internal Walls / Ceiling</b>	: Surfaces Luppam / putty of JK Wall putty or equivalent make and painted with acrylic emulsion of premium brand like Nippon or equivalent. Designer False ceiling in all five floors corridors.
<b>External Walls</b>	: Painted with combination of textured/Smooth finish, with premium brand like Nippon or equivalent
<b>Flooring</b>	: Vitrified tiles flooring in Drawing / Living / Dining / Children & Guest Bedrooms/ Kitchen. Laminated wooden flooring in Master bedroom. Antiskid Ceramic tiles for Utility Flooring and & ceramic tile dado up to 3 feet in utility area. Antiskid Ceramic tiles Flooring & Concept based tile dadoing up to door height in all Bathrooms. Granite/Vitrified flooring in common corridors areas, lift lobby & grand entrance lobby.
<b>Doors and Windows</b> <b>Main Door</b>	: Teak Wood door frame and shutter with melamine polish on both sides. Brass / SS hardware of superior brands like Dorset / Godrej or equivalent.
<b>Internal Doors</b>	: Teak Wood door frame with moulded flush shutters with enamel paint. Cylindrical, Brass / SS finish locks of superior brands like Dorset / Godrej or equivalent for all internal doors.
<b>Windows</b>	: Teak wood frame and teak paneled shutters with security Grills.
<b>Kitchen</b>	: Granite Platform with Stainless Steel Sink. Both Municipal & Bore water connections. Glazed Ceramic tiles dado up to 2' ft. above kitchen Platform. Provision for Aquaguard point..
<b>Electrical Installations</b>	: Concealed copper wiring with Flame Retardant Low Smoke (FRLS), PVC insulated wires of superior range like Finolex or equivalent. Modular Switches of superior brands like Legrand / Schneider or equivalent. Separate Miniature Circuit Breaker (MCB's) will be provided for light & power circuits at main distribution box within each flat. 3 phase supply for each flat with individual meter boards. Power points for Air Conditioners in all bedrooms.
<b>Sanitary and Plumbing</b> <b>Sanitary fittings</b>	: Ceramic Ware of premium brands of Parryware / Kohler or equivalent in all bathrooms. CP fittings of premium brand like Jaquar/ESS ESS or equivalent, in all bathrooms and Kitchen. GI / CPVC Water supply piping of superior quality of Tata / Zenith PVC piping of Sudhakar / Prince make for sanitary and rain water piping.
<b>Toilets</b>	: Hot and Cold water Wall Mixer with Shower in all bathrooms. Provision for Geysers in all bathrooms.
<b>Back-Up Generator</b>	: DG set of Kirloskar or equivalent make with Acoustic insulation. Minimum of 15 light/fan points will have back up power on DG Set.
<b>Telephone / Data Connections</b>	: TV outlets in all Bedrooms and Family Room Telephone Point in Master Bedroom and Drawing Room. Internet Point in Master & Children's Bedroom.
<b>External Hand Railing</b>	: Stainless Steel / MS powder coated railing for Staircase and Balconies.
<b>Lifts</b>	: 3 lifts of superior range like KONE / OTIS or equivalent will be provided . Granite/Italian Marble Cladding at Ground floor level, on the lift front wall. Granite/Vitrified Tile Cladding at other floor levels, on the lift front wall.
<b>Intercom facility</b>	: Intercom Facility from each Apartment to Security Room and to other Apartments. Individual Video Door phones will be provide for each Flat

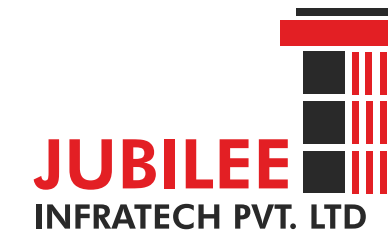

## Masterpieces in making

'Jubilee' – the name - over the last ten years, has become synonymous with quality, commitment and customer satisfaction, in the field of realty. The group with their innovative efforts and ingenious planning, has created a glorious array of architectural landmarks that eloquently reflect their passion for perfection. The group in the last ten years, has been growing in stature and reputation, offering clients aesthetic homes with modern amenities and elevated lifestyles, at affordable prices. Jubilee Cyber Grande is another glowing example, which demonstrates their expertise and dedication to their avowed values.



Jubilee Surya - Telephone Colony



Jubilee Meadows - Alkapuri



Jubilee Heavens - Green Hills Colony



Jubilee Homes - Telephone Colony



Jubilee Heights - Alkapuri



Jubilee Orchids - SBI Officers Colony