

imagine a meticulously crafted symphony.

---











Span Group is a partnership between the Gujarat group of companies and the Rajendra Group of companies, which has been around for three decades. With a firm foothold in the realty sector, the group has fostered many development, redevelopment and renovation projects.

The entity is made up of like-minded people who share a common vision and goal - that of being a name to reckon with in the realty industry. The key personnel manning the helm of the firm have at their disposal perhaps the most important thing of all - vast and varied expertise and experience.

Having garnered much acclaim through their fondness for quality, choice of location and timely completion, the group looks to the future with a strong sense of achievement. Come experience the difference.





Also the name of a breathtakingly beautiful city in Spain, Valencia is a derivation of the Latin word '**Valentia**' which means strength or valour. Suffice it to say that Span Valencia is a well-balanced combination of beauty and strength. While it features everything a home should and then some, the address (Mira Road, near GCC Club) brings also along with it a certain stature and grace. Loaded with formidable features, amenities and an enviable façade, it is sure to make you proud to call it home.







# 3,5,7,9 FLOOR PLAN

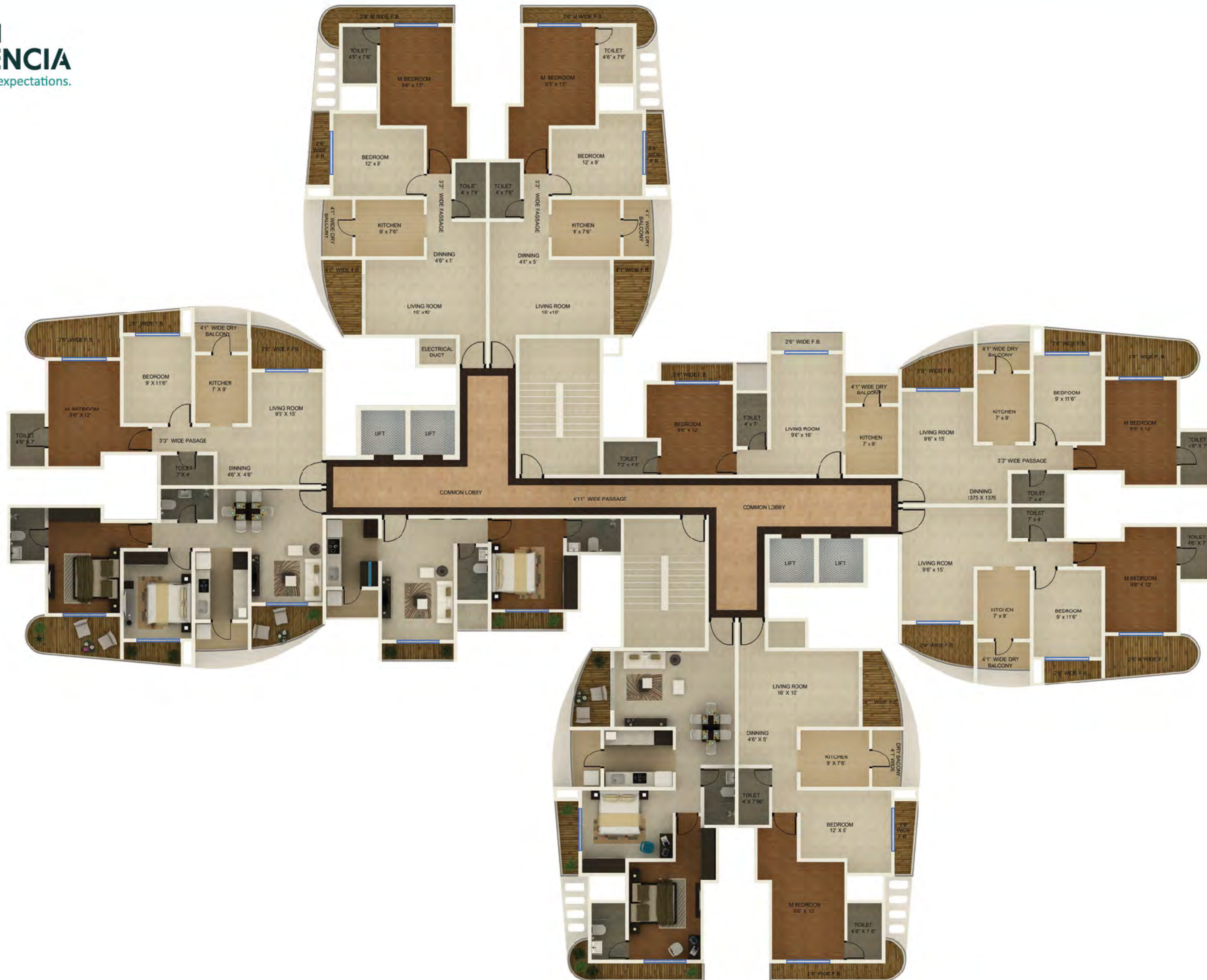





# 2,4,6,8 FLOOR PLAN

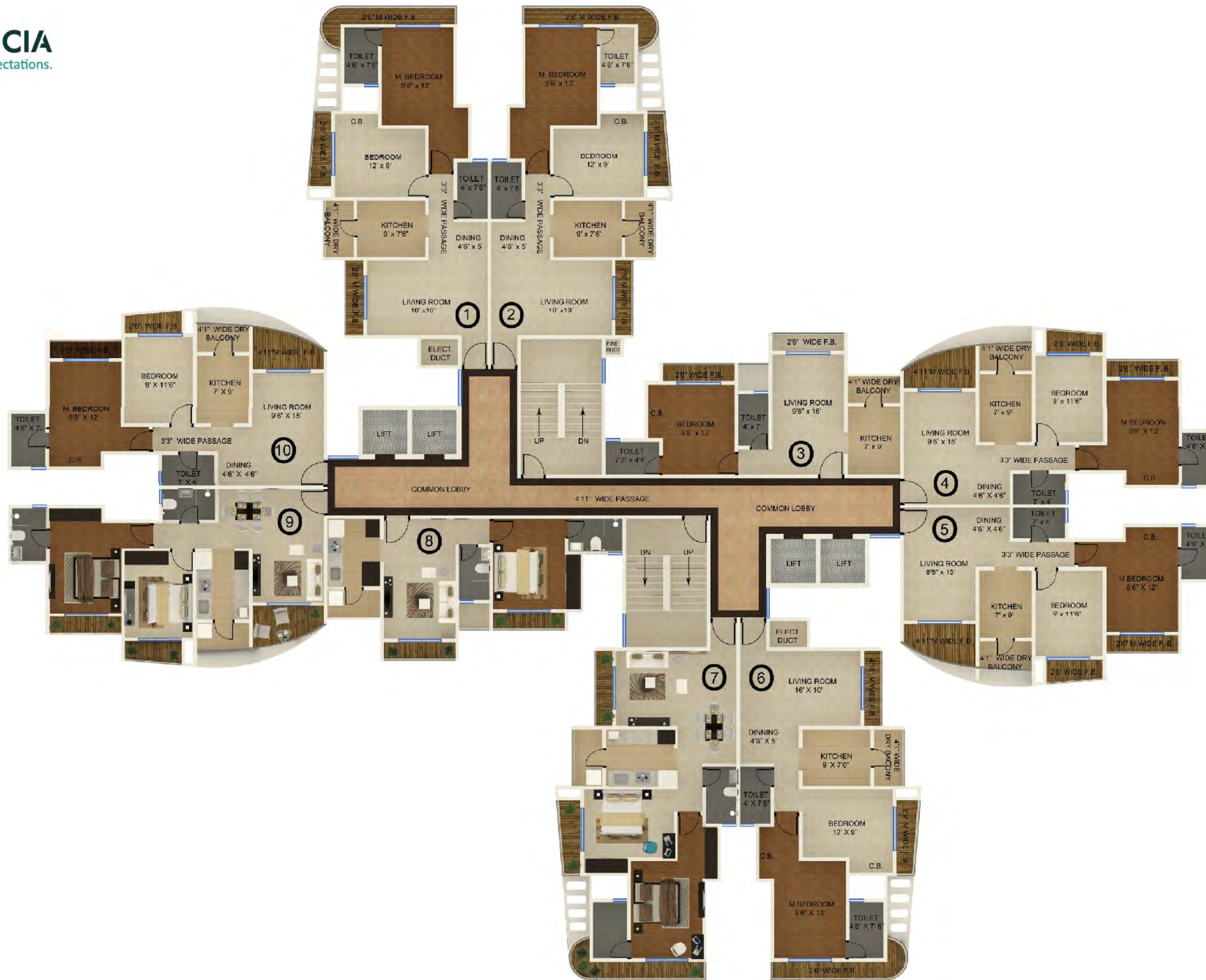





## STRUCTURAL & INTERNAL FACILITIES

- | A palatial entrance lobby, finished in Italian marble with exclusive fittings
- | High-speed automatic elevators of reputed make
- | A well decorated elevator lobby
- | Fire fighting equipment
- | Solar water heater
- | Rain water harvesting plant



## AMENITIES

- | High quality vitrified tiles throughout the apartment
- | High quality sanitary and C.P fittings in the bathroom
- | French windows with granite/marble sill
- | Designer false ceiling in living room
- | A modular, well-furnished kitchen with a granite table top
- | Bathrooms finished in designer tiles and fittings
- | Acrylic paint on the exterior walls & oil-bound acrylic paint / texture paint on internal walls
- | Telephone & T.V. points in each room







**Legal Advisor :** S.P Singh | Mob : 98217 10565

**Municipal Architect :** Bharat Kumar Patel, Andheri (East), Mumbai | Mob : 98690 76073

**Design Architects :** Architect Rushikesh H., Andheri (East), Mumbai | Tel: +91-22-28379441 / 66753330

**Site Address**

S.No. 459/B, Adjacent to Akruiti  
Gardenia, Poonam Garden,  
Mira Road (East), Dist. Thane  
Mob : +91- 9167255482

502, Inizio, Cardinal Gracious Road, Opp. P&G Plaza, Chakala,  
Andheri (East), Mumbai 400 099.

Tel : +91-22-6179 6179 | Fax : +91-22-6179 6180 | Mob : +91-91672 55482  
E-mail : info@spangroup.co | sales@spangroup.co  
Website : www.spangroup.co

Ground Floor, Bhaupadman Apt.,  
Indralok Phase III, Bhayandar (East),  
Thane 401105

