

1180 sqft
dream
apartments

LEGACY
ARISTON 



LEGACY
ARISTON 

The essence of affordable fine living. 45% built up area, with 55% landscaping



Witness your dream turning into reality.

Location

Just 15 Kms from Windsor Manor Hotel, 4 Kms from Yelahanka Police Station and 19.5 Kms from the International Airport. 2.5 Kms from Proposed Peripheral Ring Road.

Accessibility

Proximal to excellent schools such as VidyaShilp Academy, Delhi Public School, Nagarjuna Vidyaniketan, Sheshadripuram School, Aditi, Poorna Prajna and BMS College of Engineering. Close to shopping destinations such as Food World, Esteem Mall, Sahakarnagar and Yelahanka Shopping Districts. Northside Hospital and Columbia Asia Hospital in the vicinity.

Modern

Vitrified tiles, Shower Enclosures, Swimming Pool, Gym, Generator Back-up, Wi-fi Capability and much more.

Security

Round the clock security personnel to keep unwanted visitors away

Greenery

Buildings occupy only 45% of land area with remainder 55% as open spaces for landscaping

Privacy

No windows or balconies face each other, a feature rare to find in apartment buildings today.

Design

All spaces within the apartment are designed to have abundance of natural light and ventilation, thereby conserving energy.

Vaastu compliant

To optimize the flow of energy, long-standing principles of Vaastu Shastra have been strictly followed for designing Ariston.

In addition, you will enjoy the benefits of a multi-facility clubhouse, which includes amenities such as a well-equipped gym, swimming pool, party terrace, children's play area and much more... Legacy Ariston truly brings to you the essence of fine living with unmatched value.



Amenities : best of luxury

Swimming pool	: Enjoy a leisurely swim
Gymnasium	: Stay fit with state-of-the-art gym
Meditation area	: Get away from all the stress
Party terrace	: Celebrate in style
Children's play area	: Designed for fun times
Park with gazebo	: Socialize with neighbors
24-hour generator back-up	: 1kva for each apartment
Wi-fi capability	: Mix work and pleasure
Water treatment plant	: Drink pure soft water
Sewage treatment plant	: To conserve water
Rain water harvesting	: To preserve underground water table

Specifications : finest quality

COMMON AREAS

Flooring	: Contemporary granite flooring in lobby
Elevators	: 6 passenger capacity
Covered parking	: In basement with separate washing & battery-operated car charging bays
Restrooms & bathrooms for staff	: Provision for drivers, security guards, servants and garden maintenance staff

INFRASTRUCTURE

Structure	: RCC framed structure
Walls	: Concrete block masonry
Flooring	: Vitrified tiles
Main doors	: Hard wood frame with polished designer shutters
Internal doors	: Hard wood frame with painted designer shutters
Balcony doors & windows	: Aluminium sliding 3-track with mosquito shutter

BATHROOMS

Aesthetically designed washrooms	: With elegant sanitary-ware and CP fittings
Flooring	: Anti-skid tiles
Shower enclosures	: Demarcates wet & dry areas
Exhaust fans	: Keep bathrooms fresh
Vanity counter	: In master bathrooms

KITCHENS & UTILITY

Granite working platform	: With 2' tiling above the counter
Sinks	: Single bowl sinks with drain board
Centralised gas connection	: Saves the trouble of procuring cylinders
Clothes Drying Area	: Out of sight separate space for your domestic needs with washing machine point

ELECTRICAL

Electrical points	: Ample points with modular switches
Tv & telephone	: Wiring for DTH & telephone points provided in the apartment



BLOCK PLAN

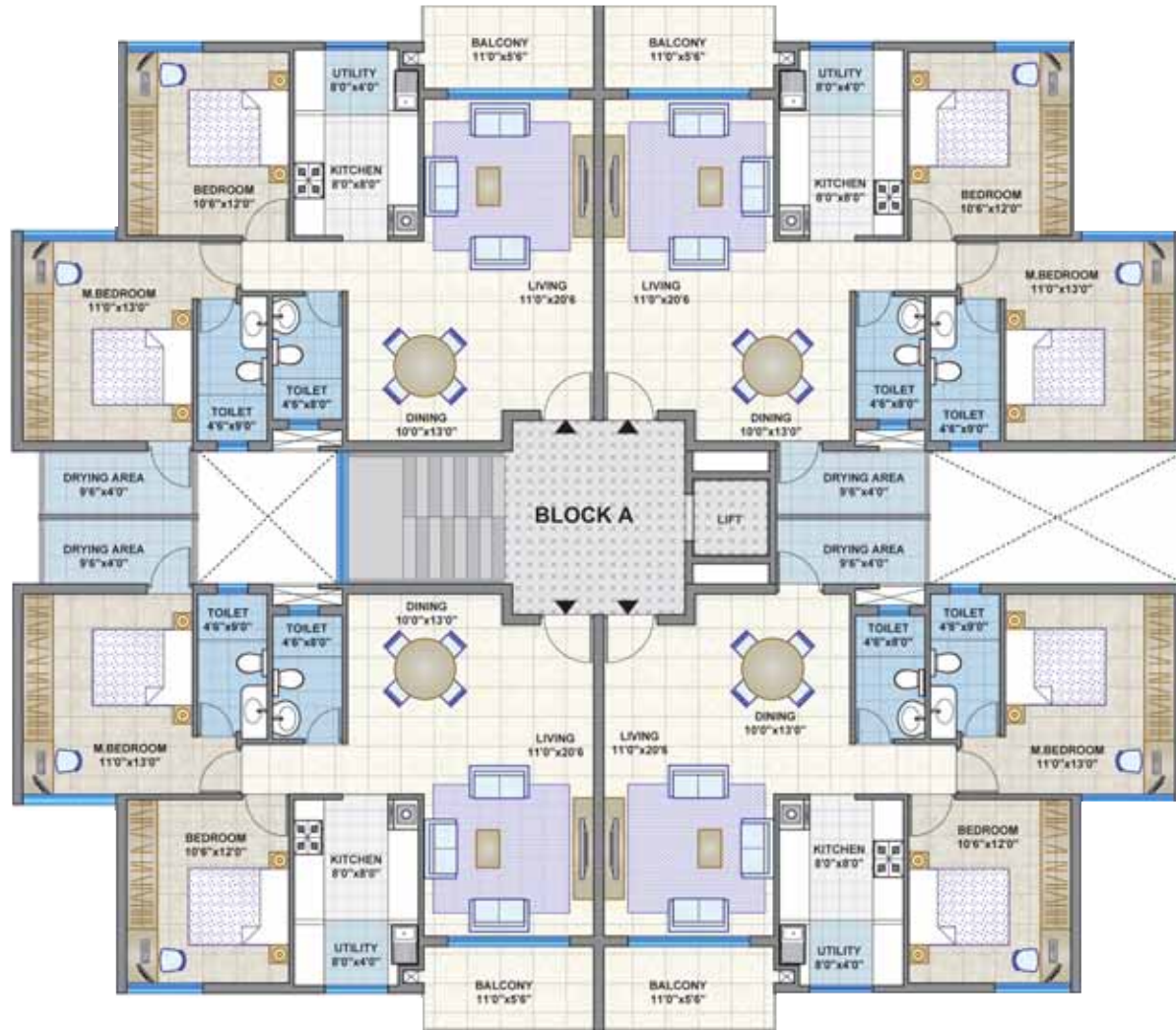

KEY PLAN

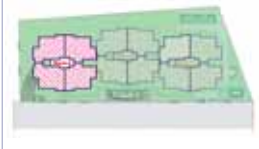

UNIT PLAN
SBA 1180 sqft



KEY PLAN

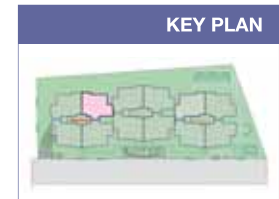

LOCATION MAP



The Legacy that promises to live on...

Legacy Group was founded by experts in the construction business. It is a company whose strengths lie in identifying the right people and the right opportunities. Our focus, determination, combined knowledge and skills have helped mould and nurture the company. Drawing from our own experiences we have sought to ideate, create and design properties that understand the requirements of its occupants. Our projects, Legacy Casero and Legacy Dimora are both testaments to this.

Perfectionists by nature, we at Legacy Group believe in quality living. Our buildings are designed for fulfilling your requirements, meeting your needs and offering you the best there is in construction. We aim to do this with all our projects and that too, always with a sense of flair, style and unforgettable luxury.





LEGACY GROUP

50/710, Cunningham Road, Bangalore 560 052, Phone +91 80 4151 6200,
Mobile +91 98865 43330, Telefax +91 80 4150 9196, www.legacygroup.in



In Association With

CHITRAKUT™
BUILDERS & DEVELOPERS



This brochure is conceptual in nature and is by no means a legal offering. The promoters reserve the right to change, remove or add any specifications or plans mentioned herein.