

GOLDEN RAIN AVENUE - (PHASE - VIII)

PLAN SHOWING THE LAYOUT OF HOUSE SITE IN SURVEY Nos. 182 / 3A, 6 AND 181 / 1,3,4.

NATTARASANPATTU VILLAGE, KUNRATHUR UNION,
SRIPERUMBUDUR TALUK, KANCHEEPURAM DISTRICT

PANCHAYAT APPROVED NO: 5 / 2013

SINGAPERUMAL KOIL TO CHERPANANCHERY, PADAPPAI

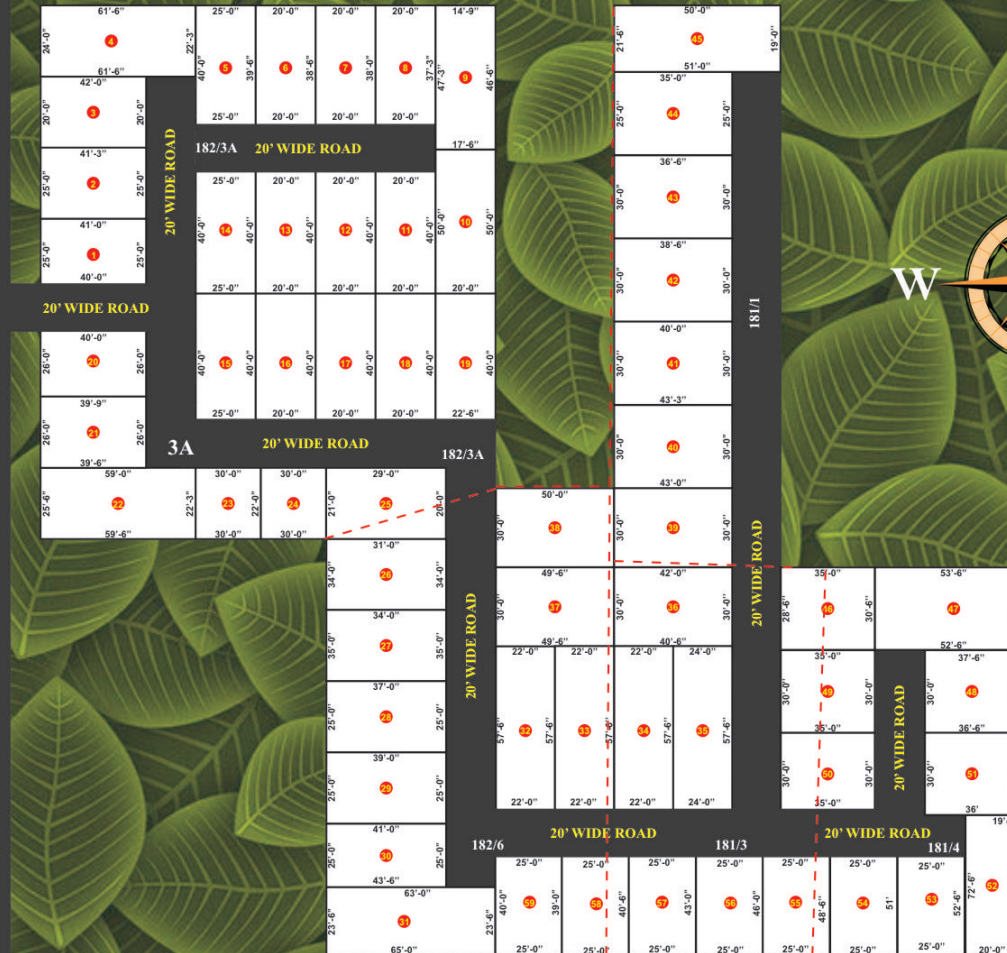

AREA STATEMENT

Plot No.	Survey No	Extent	Plot No.	Survey No	Extent
1	182/3A	1001	31	182/6	1504
2	182/3A	1028	32	182/6	1253
3	182/3A	833	33	182/6 & 181/3	1265
4	182/3A	1422	34	181/3	1265
5	182/3A	983	35	181/3	1368
6	182/3A	780	36	181/3	1238
7	182/3A	765	37	182/6	1485
8	182/3A	752	38	182/6	1493
9	182/3A	756	39	181/1 & 181/3	1275
10	182/3A	938	40	181/1	1294
11	182/3A	800	41	181/1	1249
12	182/3A	800	42	181/1	1178
13	182/3A	800	43	181/1	1125
14	182/3A	988	44	181/1	894
15	182/3A	988	45	181/1	1023
16	182/3A	800	46	181/3 & 181/4	1032
17	182/3A	800	47	181/4	1656
18	182/3A	800	48	181/4	1110
19	182/3A	850	49	181/3 & 181/4	1050
20	182/3A	1024	50	181/3 & 181/4	1038
21	182/3A	1030	51	181/4	1075
22	182/3A	1414	52	181/4	1446
23	182/3A	664	53	181/4	1294
24	182/3A	645	54	181/4	1244
25	182/3A & 182/6	603	55	181/3 & 181/4	1181
26	182/6	1105	56	181/3	1112
27	182/6	1243	57	181/3	1050
28	182/6	950	58	181/3 & 182/6	994
29	182/6	1000	59	182/6	976
30	182/6	1053			

Orakadam Junction

SINGAPERUMAL KOIL ——— **SRIPERUMBUDUR**

SINGAPERUMAL KOIL TO CHERAPANANCHERY

Padappa

Vandalur

TAMBARAM TO MANNIVAKKAM

G.S.T.Road ——— **Tambaram**

Shiram Gateway SEZ

Tambaram

ABS MORE TRUST. MORE VALUE. MORE SMILE.

ABS ESTATES

No.20, Sivashanmugam Street, West Tambaram, Chennai - 600 045.
 Ph : 222 666 77, 222 665 03 / 4 / 5 / 6
 E-mail : enquiry@absestates.com, Web : www.absestates.com

Golden Rain Avenue Phase - VIII

PADAPPAI @ NATTARASANPATTU



SALIENT FEATURES:

- Clear Title
- Ready to Construct
- 1 Km from Villa Gio Housing Project
- 1.5 km HIET College of Engineering.
- 4 km from Vandalur To Walajabad, 6 Lane Highway & Tata Crescent Lake view Apts
- 5 km from Hirco Palace Garden.
- 10 Mins drive from Proposed South Bus Terminus (Vandalur)
- 15 Minutes drive From Tambaram Bus Terminus & Railway Station.
- Very close to Krishna Engg College & Dhanish Ahmed Engineering College.
- Sweet water at 20 feet.
- Gated community layout.
- 24 x 7 Security Service.
- 5 Years free Layout Maintenance.