



Prestigious Living for the
prestigious you...





Welcome to a prestigious living at Green Island, an elegant housing project from LOHARUKA. A housing where you can feel the sweet freshness of nature, get the aroma of rain washed earth and enjoy luxurious living with all modern amenities. The project has been designed keeping in mind of natural light, air cross-ventilation and security.

Located at Rajarhat area with 5 blocks of Multi-storied building, the project comprises 2 & 3 BHK apartments along with a well planned gated community. Green Island has well connectivity from City Centre II, Saltlake Sector V, VIP Road, Kolkata Airport.

Come, indulge into an exotic lifestyle at affordable pricing...

Nearest Landmarks & Distances :

Six Lane Expressway	5 Minutes
City Centre II	5 Minutes
VIP Road	8 Minutes
Sector V	15 Minutes
Upcoming Metro Station	5 Minutes
Kolkata Airport	10 Minutes

Five Blocks of Multistoried Building **Well decorated Gated Community** **2 / 3 BHK Apartments**

Site : Partha Nagari, Lalkuthi, P.O. : R. Gopalpur, Rajarhat Road, Kolkata - 700136



GREEN ISLAND FLOOR PLAN

MUNICIPAL ROAD

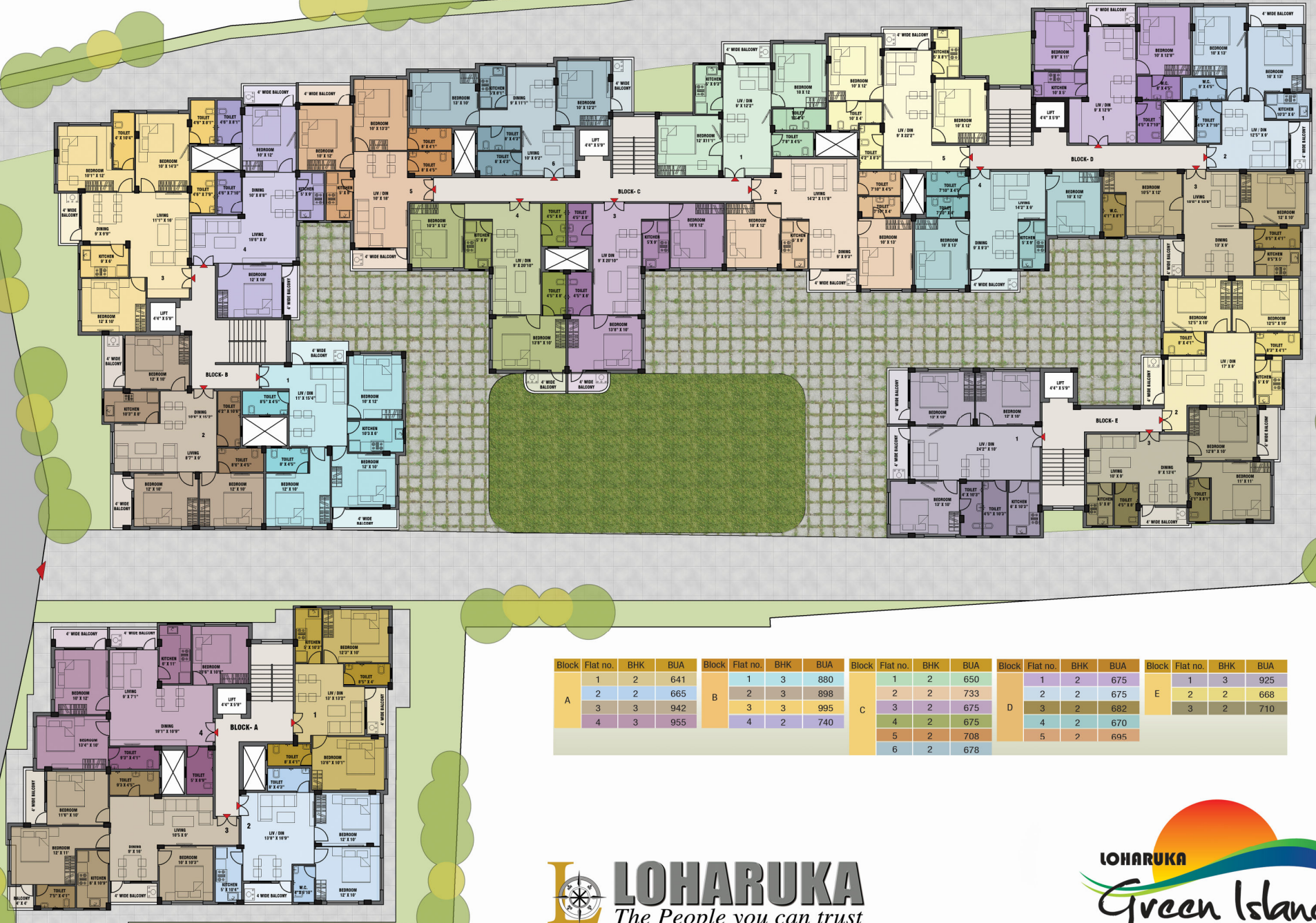

Block	Flat no.	BHK	BUA	Block	Flat no.	BHK	BUA	Block	Flat no.	BHK	BUA	Block	Flat no.	BHK	BUA	Block	Flat no.	BHK	BUA
A	1	2	641	B	1	3	880	C	1	2	650	D	1	2	675	E	1	3	925
	2	2	665		2	3	898		2	2	733		2	2	675		2	2	668
	3	3	942		3	3	995		3	2	675		3	2	682		3	2	710
	4	3	955		4	2	740		4	2	675		4	2	670				
									5	2	708		5	2	695				
									6	2	678								

SPECIFICATION :

Structure :	RCC framed construction.
Internal walls :	Cement plastering overlaid with smooth, impervious Plaster-of-Paris/Putty.
Doors :	Wooden door frame with 32mm thick flush door.
Windows :	Sliding Aluminum windows with large panes and grills.
Flooring :	Vitrified tile flooring in all bedrooms, living/dinning room and common areas.
Kitchen :	Floor vitrified/ceramic tiles, counter tops granite with steel sink, dados ceramic tiles up to a height of two feet from the granite top.
Toilet :	Floor ceramic tile flooring, dados ceramic tiles up to six feet.
Sanitary ware :	White, high quality porcelain fittings. Chromium plated fittings of Jaquar or equivalent. Geyser points in all bathrooms and one washing machine point in balcony.
Electrical :	Superior quality concealed wiring with the modular switches and miniature circuit breakers. AC Point in all bedrooms and one A.C. point in living room. TV point in Living room and master bedroom.
Exterior :	Latest weather proof non-fading exterior finish.



FACILITIES :

- Fully Automatic Lift in each block
- A. C. Community Hall
- Intercom network
- 24*7 Power Back-up
- CCTV Security for compound wall
- Central Garden
- Fire Fighting Facility
- Iron Removal Water Filtration Plant





LOHARUKA is one of the leading real estate companies, with a proven track record of more than 25 years and by constructing numerous residential projects.

LOHARUKA has its own customer base that has shown a huge belief in the brand and due to their support today we have reached to the place we dreamed of. LOHARUKA is engaged in providing homes to the endless families, who aspire for their dream home becoming a reality one day, along with modern lifestyle amenities. LOHARUKA has completed several landmark projects in Kolkata and Pune, and currently lined up with significant projects in different part of Kolkata, Pune and Bengaluru.



Green Heights(Rajarhat, Kolkata)



Urban Greens(Rajarhat,Kolkata)



Freshia(Rajarhat,Kolkata)



Green Oasis(Kaikhali, Kolkata)



Green Chinar(Newtown,Kolkata)



Green Enclave(Rajarhat,Kolkata)



Green City(Handewadi,Pune)



Little Earth(Kiwale,Pune),



Solaris(Banerghatta Main Road,Bengaluru)

Anisha Builders & Developers Pvt. Ltd.

Loharuka Niket, DC-9/28, Sashtri Bagan, Deshbandhu Nagar,
VIP Road, Kolkata – 700059, West Bengal

For Sales Contact: +91 9874984488 | +91 9836002288

Email: marketing@loharukagroup.com | Website: www.loharukagroup.com

Architect : Monojit Das & Associates

Disclaimer: This brochure is only a conceptual presentation and not a legal offering. The images, designs, layouts, and sizes of the flats and the details of facilities & amenities as shown here are tentative and are subject to change at the sole discretion of developer without any reference.