



ITNOA

*Apartment*

FAIZABAD ROAD



# Company Profile

**Max Infra Ventures Pvt. Ltd.** is a well-recognized name in Lucknow's real estate business, started its operations in late 2017. It has grown exponentially setting benchmark for quality standard innovating in style and technology that captured the attention of its judicious customers. Max Infra Ventures is not only delivering quality projects and but also providing a better quality of life and environment to its customers.

**Company's motto is simple -**

"Excellent customer care with highest customer satisfaction."

## Vision

Company's vision is to make the world a better place to live in, to transform and uplift the quality of living and life style of each and every individual and to contribute significantly into the development of real estate....!

**Level up your live! Invest with Max Infra Ventures !**

# Specifications

## Structure:

Structure designed for the highest Seismic considerations for zone as stipulated by the code and better safety.

## Foundation:

Reinforced concrete footings and column with raft.

## Living/ Dining Room & All Bedrooms

**Flooring/skirting:** Good Quality / Vitrified Tiles of Rang

**Wall Finishes:** Acrylic Emulsion on POP punning

**Ceiling:** Oil Bound Distemper

## Toilets

**Flooring:** Ceramic Tiles

**Wall Finishes:** Ceramic Wall Tiles up to Dado level (approximately 2100 mm). Oil Bound Distemper.

**Ceiling Finishes:** Oil Bound Distemper

**Sanitary ware:** Good Quality

## Kitchen

**Flooring/Skirting:** Vitrified Tiles/Ceramic Tiles/Marble Stone

**Wall Finishes:** Oil Bound Distemper on the walls

**Ceiling:** Oil Bound Distemper on plaster provision for installation of geysers.

**Counter:** Granite top with sink.

## External Wall Finishes

### External Wall

**Finishes:** External grade anti fungal/anti algal paint from reputed makes and brands

## Staircase

**Flooring:** Polished Indian Stone/Indian Marble / Granite on treads, risers and landings

**Railing:** Painted M.S. handrails and Dalustrades

**Wall Finishes:** Oil Bound Distemper on plaster

## Common Passage

**Flooring:** Vitrified Tile.

**Wall Finishes:** White Wash/ Oil Bound Distemper on plaster.

**Ceiling Finisher:** White Wash/ Oil Bound Distemper on plaster.

## Doors and Windows

**Main Entrance Door:** Painted hardwood frame door with flush door.

**Internal Doors:** Painted/Polished Flush Door with Door Skin.

**Hardware:** Locks, Handles and knobs.

**Windows and External Glazing:** powder coated Aluminium frame/ Frame windows with clean glass.

## Electrical Wiring and Installations

**Fixtures and Fittings:** IS compliant switches/sockets, distribution

boxes and circuit breakers from standard makes and brands.

**Wiring:** IS compliant copper wiring in concealed conduits.

Adequate provision for light points.

**Plumbing with standard:** ISI compliant CPVC water supply pipes with standards valves & accessories. ISI compliant PVC waste pipes & traps.

**Note:** visual representations shown in this brochure are purely conceptual, Building plans, Specifications, Layout plans Etc are tentative & subject to variation & modification by the company or the competent authorities sanctioning plans.





# Features

- ❁ Vastu & Well ventilated layouts
- ❁ Efficient space planning
- ❁ Modern specification
- ❁ CCTV enabled security system
- ❁ 24hr water supply & power backup
- ❁ Ample parking space

## SITE -

FAIZABAD ROAD, KISAN PATH, ANANDI WATER PARK,  
NEAR BBD UNIVERSITY, LUCKNOW

# UNIT - 1, 2, 3, 4, 5 & 6

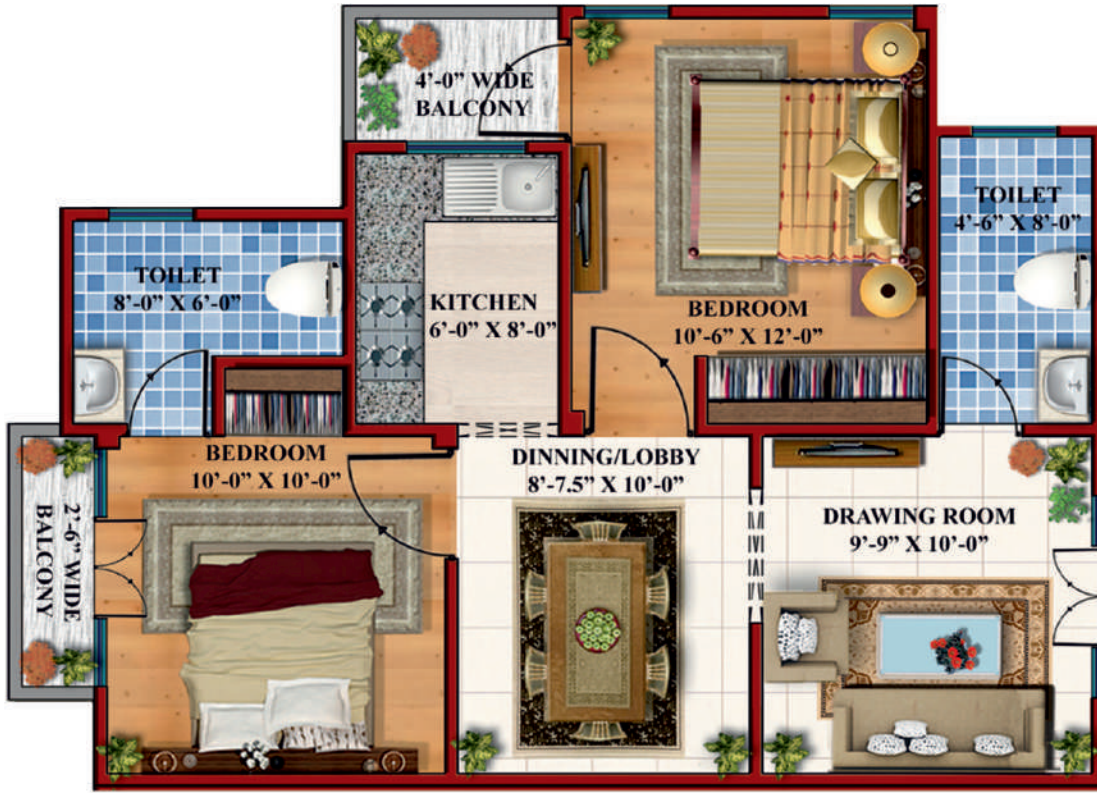

Covered Area- 655.28 sq.ft.  
Super Area - 830 Sq.ft.

# UNIT - 7, 8 & 9



Covered Area- 487.10 sq.ft.  
Super Area - 570 Sq.ft.

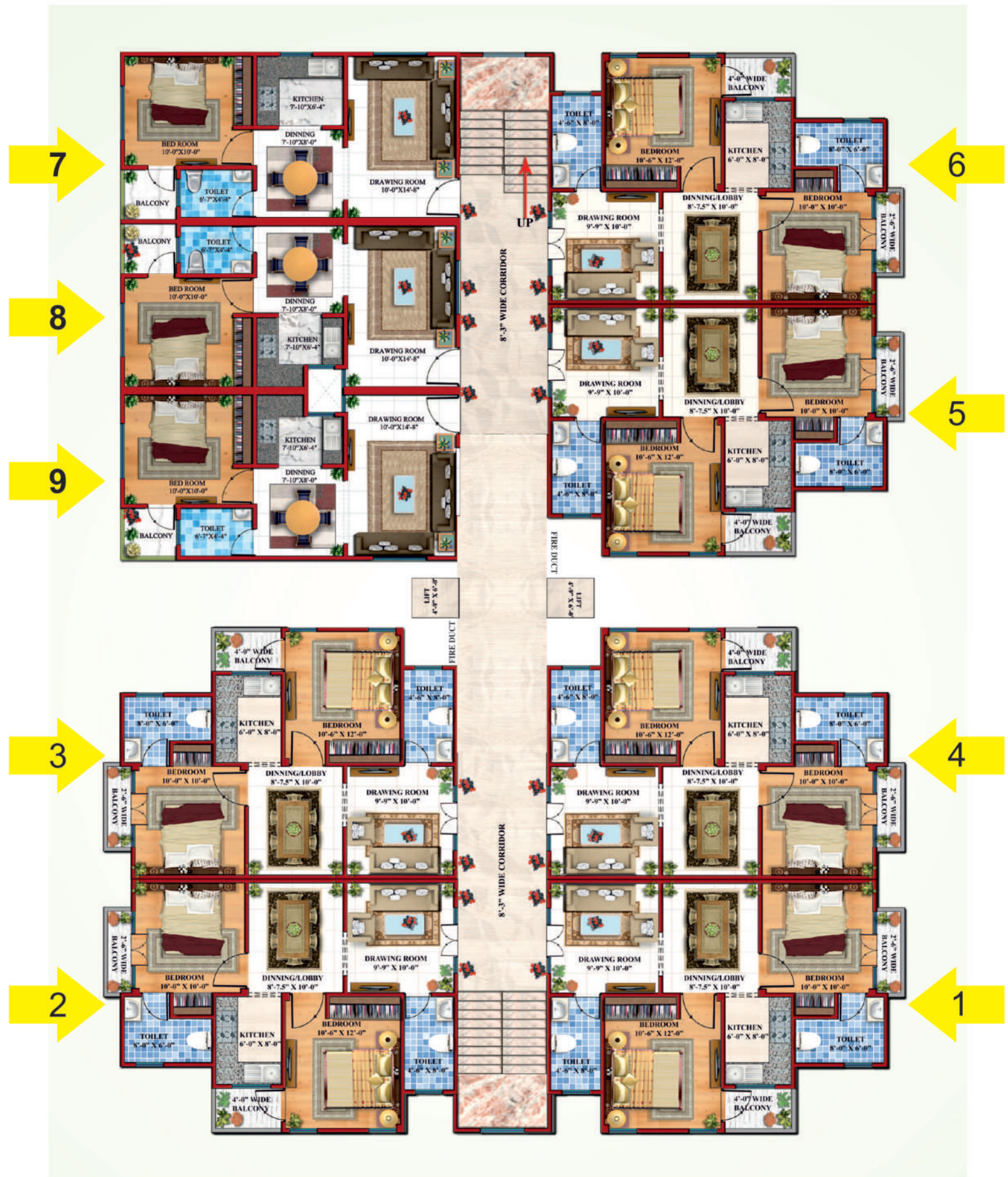

**TYPICAL FLOOR PLAN**

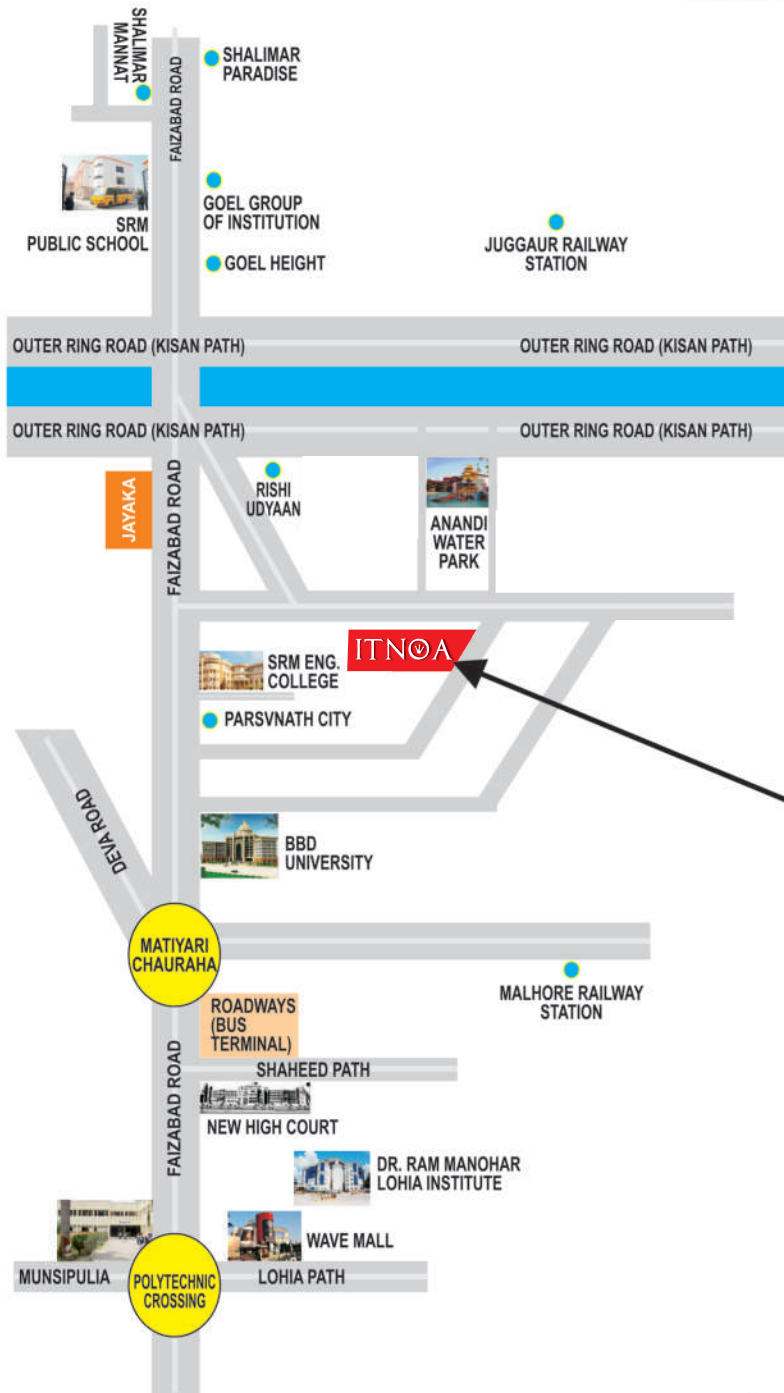

### KEY POINTS

- ✿ Proposed 150 meter wide Kisaan Path is walking distance from our project
- ✿ 9 km from Polytechnic
- ✿ 8 km from second hi-tech terminal Gomti Nagar
- ✿ 7 km from New High court
- ✿ 6 km from New roadways terminal besides Shaheedpath
- ✿ 16 km from Hazratganj



# ITNOA



☎ 0522-4309524

🌐 [www.maxinfraventures.com](http://www.maxinfraventures.com) | ✉ [info@maxinfraventures.com](mailto:info@maxinfraventures.com)

📍 2/545, Vikalp Khand, Gomti Nagar, Infront Of Kathauta Jheel, Lucknow U.P. - 226010