



Change your Address to Change your World

## A panorama of sights, sounds and scents

Welcome to a world which is luxurious, resplendent and lavishly deluxe. A world which pampers your senses and assures complete peace of mind. An address which ensconces you in lush, manicured green-scapes. Welcome to all this and any other luxury your mind can conceive. Imagine if all this could become a reality. Well! It just did. With Hazratganj Residency, your wildest dreams are set to become a concrete reality.





## Scale the Heights of Luxury

Welcome to a world which is luxurious, resplendent and lavishly deluxe. A world which pampers your senses and assures complete peace of mind. An address which ensconces you in lush, manicured green-scapes. Welcome to all this and any other luxury your mind can conceive. Imagine if all this could become a reality. Well! It just did. With Hazratganj Residency, your wildest dreams are set to become a concrete reality.





## Sprawling Panoramas of Green Living

Hazratganj Residency embodies an enchanted royal lifestyle and combines it with the best nature has to offer, in terms of unspoiled, serene surroundings. It is truly emerald oasis, blessed with densely wooded foliage and enveloped by rolling acres. In fact, these truly green homes provide the residents, an inspiring view of nature. There is an assortment of florid parks, scent gardens, tree-line walk-ways and a separate green elder's sitting area. The children's play area and party pavilion also reflect the green theme.





## A Bird's Eye View of Your World

Hazratganj Residency is a place where the Earth's green promise is replenished and your experience is peaceful and mellow. It is created with a special concern for you future generations and the environment which you will pass on, as your legacy. The architectural efficiency minimizes the need for artificial lighting while the lighting provided is energy efficient. In fact, Hazratganj Residency is a home where your children learn to be responsible and inculcate a healthy value for their surroundings.





# A Blossom of Eloquent Design Grammar

The moment you step into your Hazratganj Residency Home, the lifestyle of luxuries begins. Every single nook & cranny echoes the themes of unprecedented privileges and rewrites the rules by reinventing elegance. The impact is a stunning medley of space utilization and aesthetic expressions, which defy the ordinary. In fact, the interiors are shaped to shape your lifestyle with select keynotes of splendor and grandeur.



# A Wave of Exclusive Living

The delightfully large Club and Swimming Pool is the perfect option to revive your spirits and fitness quotient with family and friends. A round of games at the sport courts here, is the perfect way to unwind at the end of a hectic day. Picturesque surroundings, a charged ambience, along with a host of leisure and sporting activities ensure fitness and relaxation for you and the whole family.

- Health club with Gym
- Aerobics Hall
- Sport Courts
- Yoga and Meditation Room
- Steam & Sauna
- Squash Court
- Tennis Court
- Basketball
- Children's play area
- Swimming Pool





## Your Safety is our Concern

Cutting edge security solutions mark your Hazratganj Residency home. A team of security professionals with hands on experience for safety management will man all entry and exit points, round the clock. Hi-tech CCTV monitoring will help manage your exacting demands and concern for the safety of your loved ones. No expense has been spared to ensure that all residents receive unmatched peace of mind, when it comes to their safety and the wellbeing of their family.





Location Map

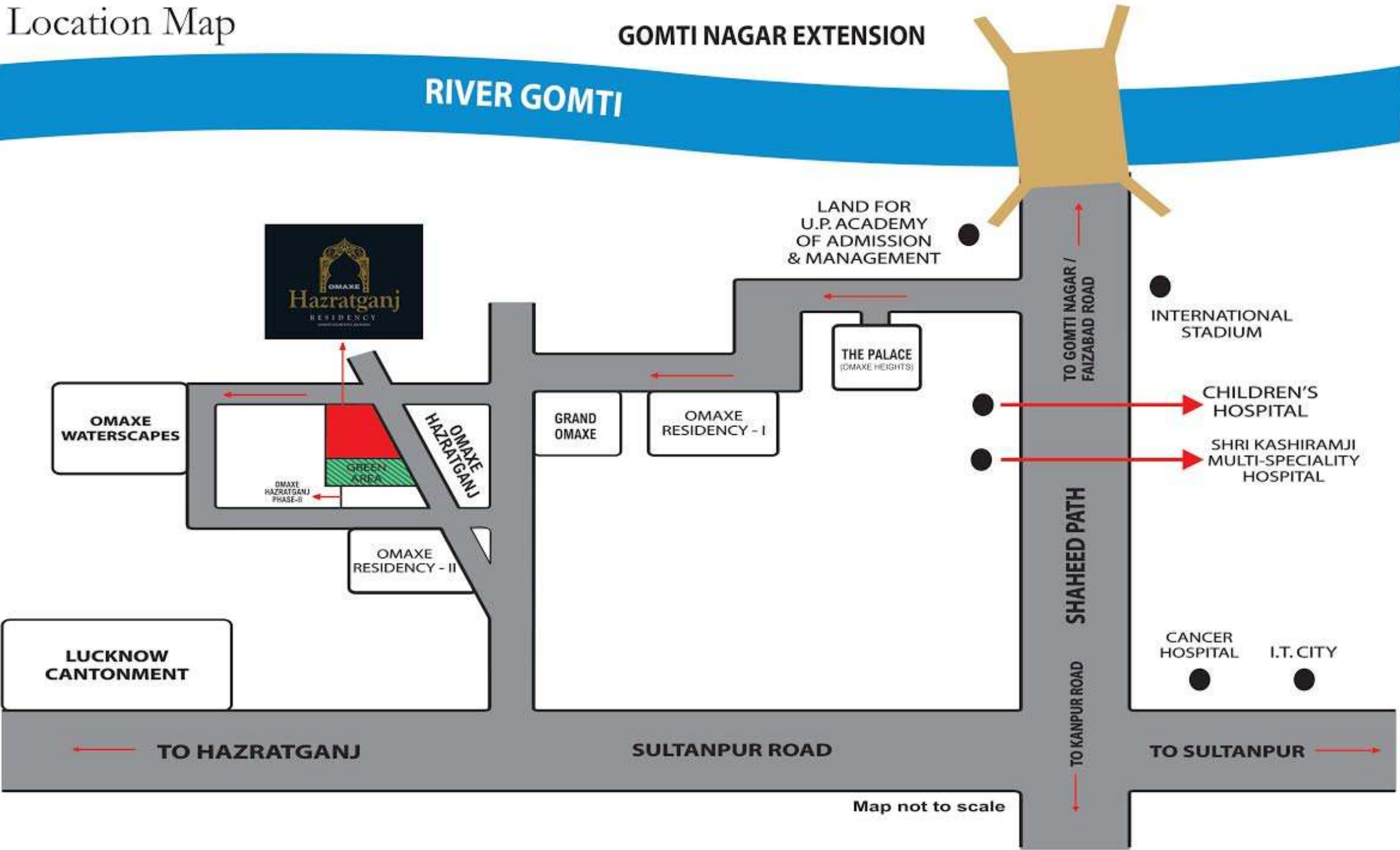

A singular address with world class amenities

The amenities at Hazratganj Residency deliver a rich quality of life in and around the periphery of the group housing complex. You are near to important shopping and business hubs in terms of access, connectivity, facilities, etc. The complex puts you within easy reach of elite schools and medical establishments, and growing needs of your family have been amply catered to.

- RIGHT ON THE EXPRESS HIGHWAY, AMAR SHAHEED PATH AND SULTANPUR ROAD
- LOCATED IN GOMTI NAGAR EXTENSION, LUCKNOW'S NEW DEVELOPMENT HUB
- ADJACENT TO NOTIFIED GREEN AREA OF OVER 100 ACRES
- OPPOSITE PROPOSED INTERNATIONAL CRICKET STADIUM CUM SPORTS COMPLEX
- IN CLOSE PROXIMITY TO PROPOSED WORLD-CLASS CONVENTION CENTRE
- PROPOSED POLICE HEADQUARTERS, DANCE ACADEMY, HOSPITALS, INSTITUTIONS AND PUBLIC FACILITIES AS IDENTIFIED BY LDA IN NEAR VICINITY

Gomti Nagar Extension is home to high-end premium Residential Projects, Malls, IT parks, Commercial Property, SEZs, Universities, Business Centers, Multiplexes, Clubs, Banks, Food Courts, Entertainment Centers and Financial Institutions



CLUSTER PLANS

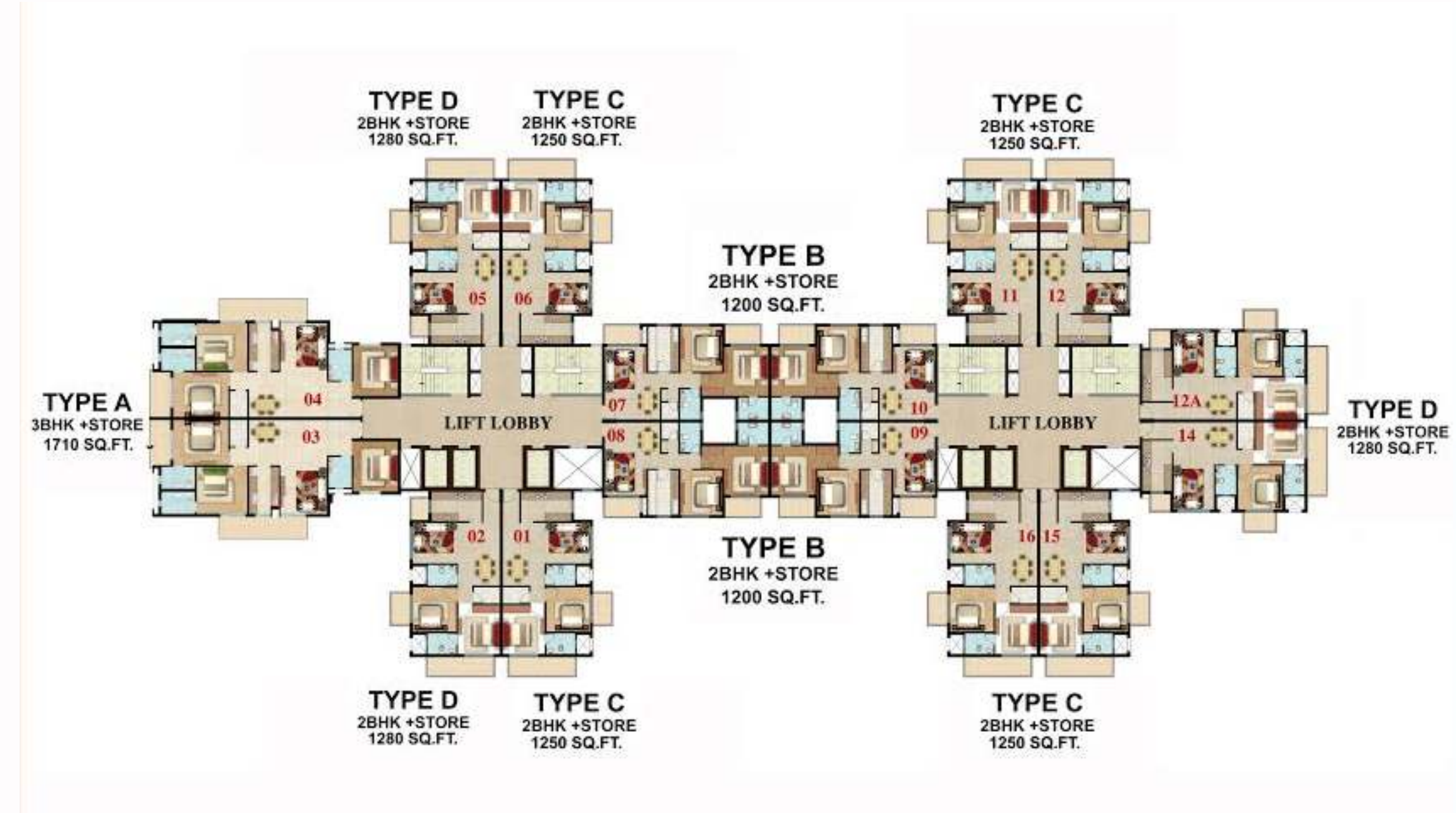

TYPICAL CLUSTER PLAN (3rd to 18th Floor)

SITE PLAN





FLOOR PLANS



1 BHK+STORE (TYPE-E)  
900 SQ.FT



2 BHK+STORE (TYPE-B)  
1200 SQ.FT



FLOOR PLANS



2 BHK+STORE (TYPE-C)  
1250 SQ.FT



2 BHK+STORE (TYPE-D)  
1280 SQ.FT





3 BHK+STORE (TYPE-A)  
1710 SQ.FT

# SPECIFICATIONS

## GENERAL

Earthquake resistant structure designed by highly experienced Structural Engineers

## SUPER STRUCTURE

R.C.C. Sheer Wall structure with columns, R.C.C. slabs & beams with brick wall partitions in between designed by IIT Engineers(AS per IS Code)

## FLOORING

Vitrified Tiles in Drawing/Dining/Bedrooms. Laminated wooden flooring in Master Bedroom . Anti-skid ceramic tiles in kitchen, toilet & balcony. Marble stone flooring in corridor, lift, lobby and staircase

## DOOR & WINDOWS

External doors & windows made of UPVC/ Power Coated Aluminum. Internal doors in Hardwood frames with laminate doors. Entrance door - Teakwood finish decorative door

## KITCHEN

Granite top working platform with chrome finish sanitary. Stainless steel sink . Ceramic glazed tiles 2" above working platform with chrome finish sanitary wares

## EXTERNAL FINISH/LIFT

Modern and elegant outer finish with high quality paint/stone with plaster & decorative Lobby/Entrance Lobby wood/tiles up to 7 feet and texture paint

## EXTERNAL FACADE

Exterior with superior paint finish

## TOILETS

Provision for hot & cold water system. Glazed tiles in pleasing colours on walls upto door level. European W.c.s washbasins & cisterns in light shade of standard brands. Chrome plated fittings of standard make

## INSIDE WALL FINISHING

Inside walls with POP punning and one concept wall in bed room, acrylic emulsion paint

## ELECTRICALS

All copper wiring in P.V.C. concealed conduit . Adequate modular switch/socket for light and power points as well as telephone & TV outlets with protective M.C.Bs

## WATER SUPPLY

Underground and overhead water tanks with pumps for uninterrupted supply of water

## INTERCOM FACILITY

Provision of intercom facility in each flat

## PNG GAS PIPELINE

Provision of gas pipeline infrastructure





Omaxe Ltd. stands for high-end luxury living which is one-of-its-kind. Its unmatched perfection and evolved aesthetics comes with thoughtfulness of luxury and open green spaces. Omaxe is India’s leading real estate developer with a footprint in 30 cities and a spread of 90 million square feet across 9 states. Omaxe specializes in ultra luxurious housing projects for royal lifestyles, transforming visions to reality.

our presence across India

8 STATES | 30 CITIES

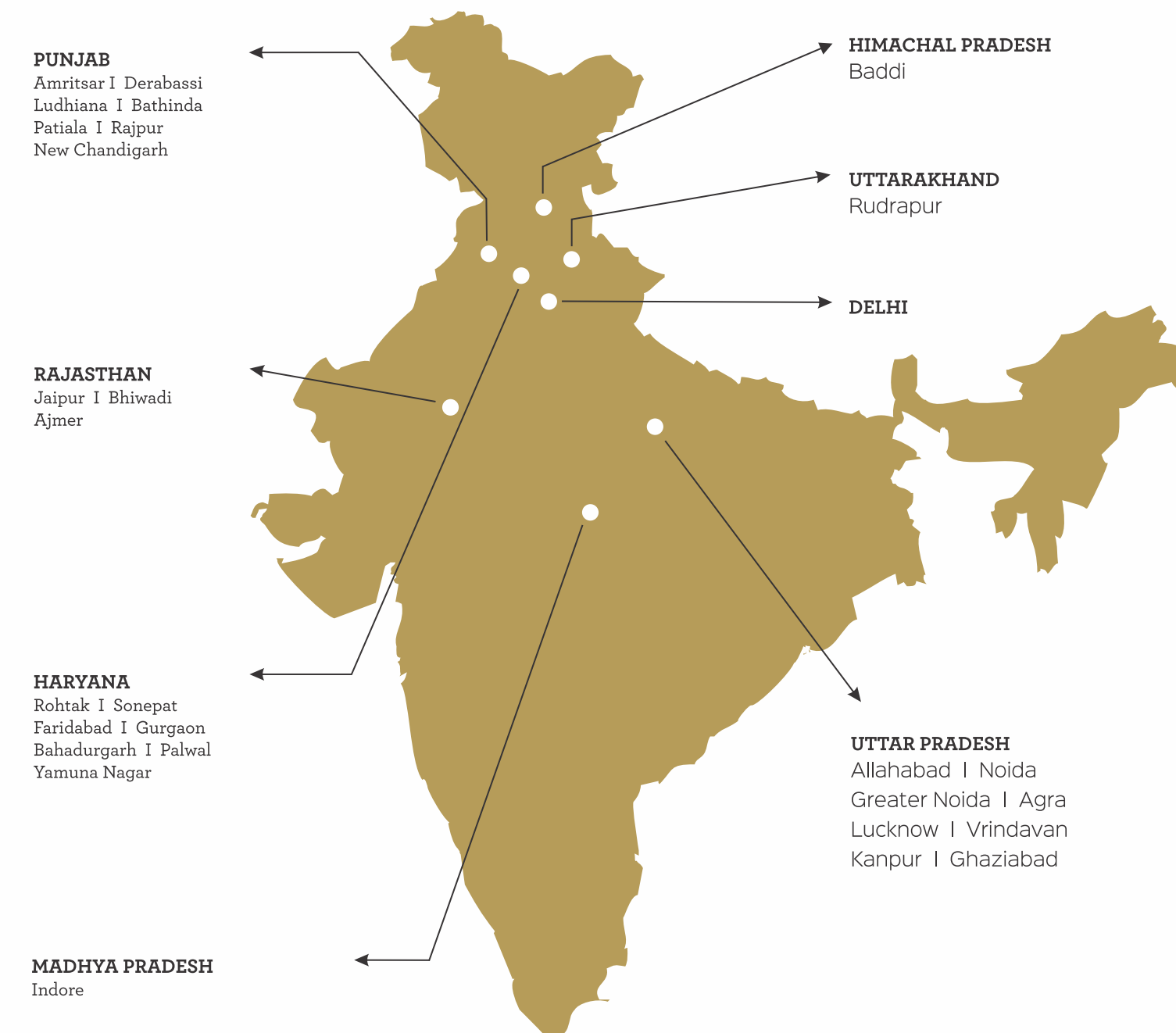





**OMAXE LTD.**

SITE ADDRESS: Omaxe Hazratganj Residency, Sec-7 Gomti Nagar Extension, Amar Shaeed Path, Lucknow-226002  
REGIONAL OFFICE ADDRESS: Cyber Tower, Second Floor, TC - 34/V2, Vibhuti Khand, Gomti Nagar, Lucknow, UtterPradesh - 226010  
CORPORATE ADDRESS: 10, L.S.C. Kalkaji, New Delhi - 110019 | [website:www.omaxe.com](http://website:www.omaxe.com)