



PANCHSHEEL
GREENS-II अच्छा
लगता है!

2/3 BR Apts. Gr. Noida (West)

अपने परिवार को एक अच्छी जीवनशैली देना.

Spread over in 26 acres approx., Panchsheel Greens II is a place filled with amenities and conveniences with best-planned infrastructure. As per experts Gr. Noida-W (Noida Extn.) is the future of NCR and Greens II is situated in a prime location of Sector 16, Greater Noida West, where metro station (proposed) at 1km distance. Reputed schools within 05 kms. periphery.



**OCCUPANCY CERTIFICATE
RECEIVED FOR 13 TOWERS
A-1 to A-6 & B-1 To B-7**



Actual Image

PROJECT HIGHLIGHTS:

- 2 State-of-the-art 3 Storied Magnificent AC Club of approx.23000 sq.ft. (2136.77 Sq. mtr.) each.
- 6 (Six) Banquet halls with Banquet Lawns for your all celebrations.
- 2 Adult swimming pools • 2 Kids' swimming pools
- Recreational facilities such as gymnasium, Carrom /chess room, Indoor & Outdoor play area for kids, Steam Bath, Aerobics/Yoga room etc.
- 4 levels of shopping convenience - "Panchsheel Green Mart" .
- Proximity to all major infrastructures like proposed metro, schools, colleges, shopping centres, government offices, private offices and entertainment centers.

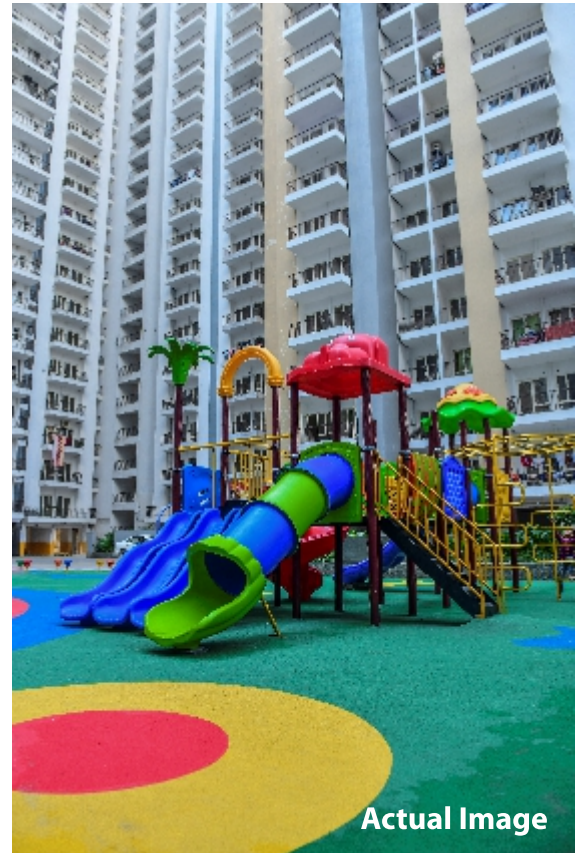



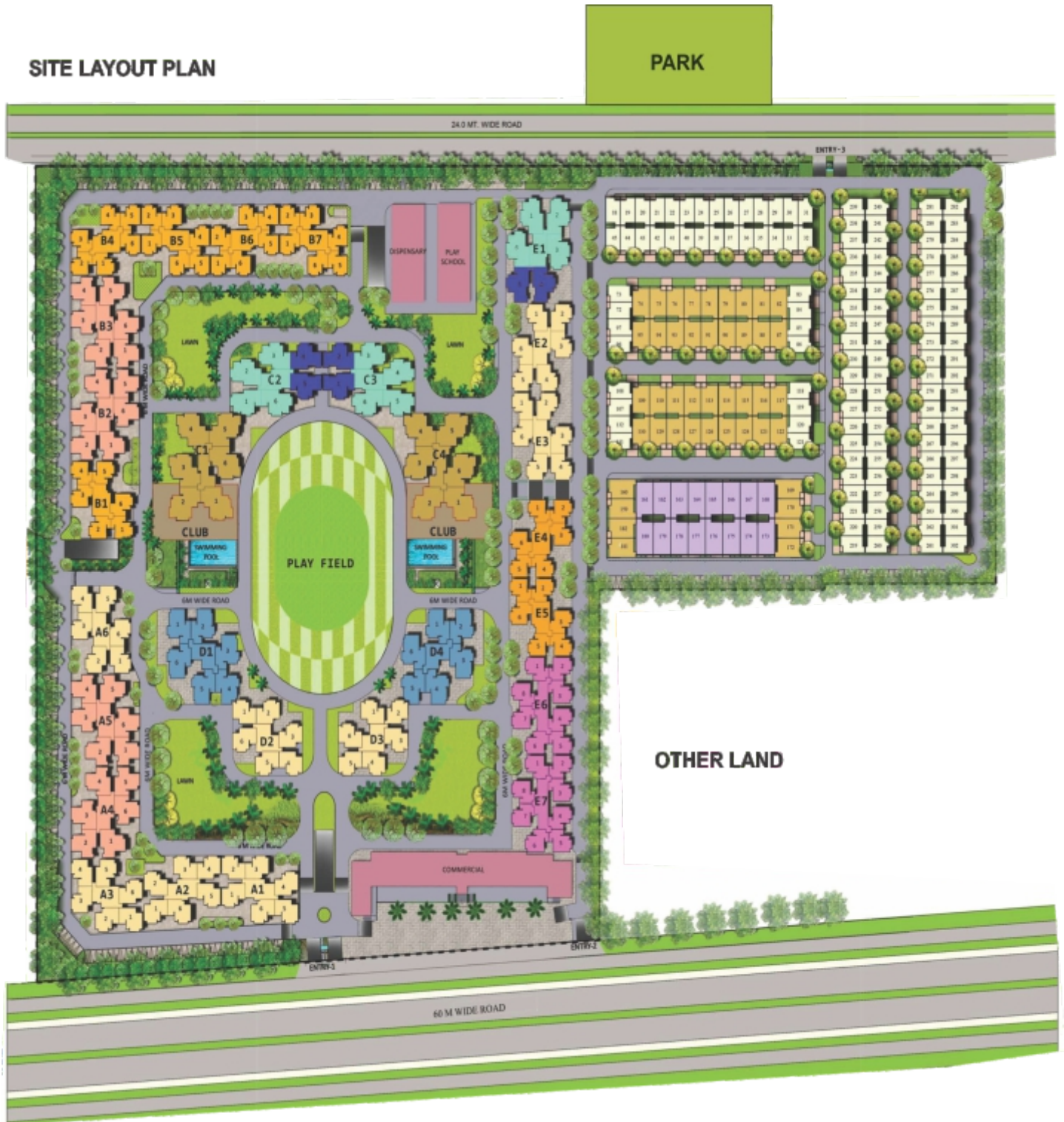





SITE LAYOUT PLAN





EXPERIENCE THE PLEASURE OF CONVENIENCE

Panchsheel Greens-II is the place filled with amenities and conveniences. Buying a home here will not just mean a shelter to live but a complete living pleasure. With world-class facilities and amenities so close by, there would never be a need to stretch out in search of more happiness.

Apart from these matchless features, the homes here offer an option of 2 and 3 bedroom apartments at the strategic location of Sector-16, Greater Noida (West). So, come and live close to happiness.

 MIG - I (915 sq.ft.)	 HIG - I (1510 sq.ft.)
 MIG - II (1105 sq.ft.)	 HIG - IA (1480 sq.ft.)
 MIG - III (1350 sq.ft.)	 HIG - II (1485 sq.ft.)
 MIG - IV (1060 sq.ft.)	 SUPER HIG - (1820 sq. ft.)

VILLA

 TYPE -A (90 sq.yd.)
 TYPE -B (120 sq.yd.)
 TYPE -C (142 sq.yd.)



RERA Regn. Nos. of Project : Phase - I, UPRERAPRJ8547 | Phase - II, UPRERAPRJ8574 | Phase - III, UPRERAPRJ8584
Phase - IV, UPRERAPRJ8592 | Phase - V, UPRERAPRJ8595
For details visit RERA website : www.up-rera.in



MIG - I / 2BHK
AREA : 915 SQ. FT.

- 2 Bedrooms
- Drawing
- Dining
- Kitchen
- 2 Toilets
- 3 Balconies

Area	Sq. Ft.	Sq. Mt.
Salable	915.00	85.00
Built-up	727.08	67.54
Carpet	572.65	53.20



BLOCK
B1, B4, B5, B6,
B7, E4, E5

FLOOR PLAN



MIG - IV / 2BHK
AREA : 1060 SQ. FT.

- 2 Bedrooms
- Drawing
- Dining
- Kitchen
- 2 Toilets
- 3 Balconies

Area	Sq. Ft.	Sq. Mt.
Salable	1060.00	98.48
Built-up	770.99	71.62
Carpet	609.13	56.59

BLOCK
E6, E7

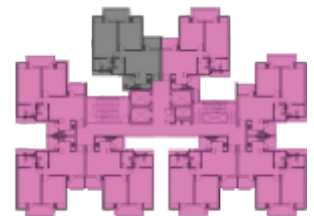



MIG - II / 2BHK
AREA : 1105 SQ. FT.

- 2 Bedrooms
- Drawing
- Dining
- Kitchen
- 2 Toilets
- 3 Balconies

Area	Sq. Ft.	Sq. Mt.
Salable	1105.00	102.66
Built-up	881.78	81.91
Carpet	697.08	64.76

↑
ENTRY



BLOCK
A1, A2, A3, A6,
D2, D3, E2, E3

FLOOR PLAN



MIG - III / 2BHK+STUDY
AREA : 1350 SQ. FT.

- 2 Bedrooms
- Drawing
- Dining
- Study
- Kitchen
- 2 Toilets
- 4 Balconies

Area	Sq. Ft.	Sq. Mt.
Salable	1350.00	125.42
Built-up	1031.18	95.79
Carpet	839.59	78.00

↑
ENTRY

BLOCK
A4, A5, B2, B3





HIG - IA / 3BHK
AREA : 1480 SQ. FT.

- 3 Bedrooms
- Drawing
- Dining
- Kitchen
- 2 Toilets
- 4 Balconies

Area	Sq. Ft.	Sq. Mt.
Salable	1480.00	137.50
Built-up	1196.98	111.20
Carpet	957.35	88.94



BLOCK
C2, C3, E1

FLOOR PLAN



MIG - II / 2BHK
AREA : 1485 SQ. FT.

- 3 Bedrooms
- Drawing
- Dining
- Kitchen
- 2 Toilets
- 4 Balconies

Area	Sq. Ft.	Sq. Mt.
Salable	1485.00	137.96
Built-up	1183.41	109.94
Carpet	900.30	83.64

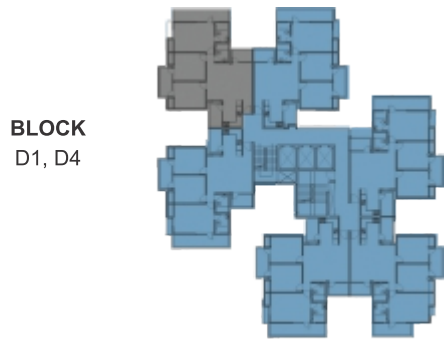

Disclaimer: Visual representation of images and elevation shown in this brochure are purely conceptual. All plans, specifications, layouts etc. are tentative and subject to variations and modifications by the company or the competent authorities and company does not bear any legal consequences for it. The areas are approx. 1 sq. mt. = 10.764 sq.ft. (10.764 sq.ft. = 1.0 sq.mt. = 10⁶ sq.mm.) we are RERA compliant



HIG - I / 3 BHK
AREA : 1510 SQ. FT.

- 3 Bedrooms
- Drawing
- Dining
- Kitchen
- 2 Toilets
- 4 Balconies

Area	Sq. Ft.	Sq. Mt.
Salable	1510.00	140.28
Built-up	1218.14	113.16
Carpets	980.39	91.08



BLOCK
C2, C3, E1

FLOOR PLAN



SUPER HIGH - 3 BHK + SERV. RM.
AREA : 1820 SQ. FT.

- 3 Bedrooms
- Drawing
- Dining
- Kitchen
- 3 Toilets
- 4 Balconies
- Servant room with toilet

Area	Sq. Ft.	Sq. Mt.
Salable	1820.00	169.08
Built-up	1436.66	133.46
Carpet	1163.70	108.11





Entrance Artistic View

SPECIFICATIONS FOR AN AESTHETIC LIFESTYLE

Structure: Earthquake resistant RCC frame structure certified by IIT, Roorkee

External Finish : Combination of long-lasting paint.

DRAWING & DINING ROOM

Floor : Vitrified Tiles

Walls/Ceiling : Plastered and painted with pleasing shades of O.B.D

KITCHEN

Floor: Vitrified tiles.

Walls/Ceiling: Plastered and painted with pleasing shades of O.B.D.

Platform: Pre-polished granite platform with stainless steel sink.

Ceramic Glazed tiles up to 2 ft. height above counter.

MASTER BEDROOM

Floor: Vitrified tiles.

Walls/Ceiling: Plastered and painted with pleasing shades of O.B.D.

OTHER BEDROOMS

Floor : Vitrified Tiles.

Walls : Plastered and painted with pleasing shades of O.B.D.

SERVANT ROOM

Floor: Vitrified tiles.

Walls/Ceiling: Plastered and painted with pleasing shades of O.B.D

BALCONIES

Floor : Anti-skid Tiles.

TOILETS

Floor: Anti-skid Tiles. Walls: Ceramic Tiles up to door level. Fittings & Fixtures: All taps Chrome plated ISI Mark, Washbasin, W.C. in all toilets. Provision for hot & cold water.

DOORS & WINDOWS

Entrance Door : Decorative Flush door with Seasoned hardwood frame. Internal Doors : Flush door. External Doors & Windows: Glazed powder coated aluminium.

STAIRCASE

Floor: Marble flooring

Walls/Ceiling: Plastered and painted with pleasing shades of O.B.D.

ELECTRICAL

Wiring : ISI Copper concealed wires in all Bedrooms/Drawing/Dining, Toilets & Kitchen.

Switches/Sockets : Modular in all Bedrooms, Drawing/Dining, Toilets & Kitchen. Intercom/TV : Intercom facility & provision for DTH connection.

LIFT LOBBY

Floor : Vitrified Tiles.

Walls : Plastered and painted with pleasing shades of O.B.D.

Elevators : 3 high speed elevators in each tower.

Panchsheel Group. Building Future.

World-class residential & commercial projects in Noida, Greater Noida, Vaishali & Ghaziabad

Nearly 3 decades
of strong standing

7000 + Possessions
Given Till Date

Thousands of
Satisfied Customers

Over 10,000 apartments
under construction

Delivered Projects



Actual View

Phase-1 delivered

PANCHSHEEL
H4NISHA

2/3 BR Homes Sec-1, Gr. Noida (W)

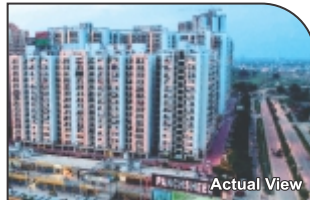

Actual View

PANCHSHEEL
Greens

2/3 BR Apts. Gr. Noida (West)

Plot No. GH-01A, Sector 16B, Gr. Noida (W)



Actual View

PANCHSHEEL
Greenaria

Premium Retail Spaces at G. Noida (West)

Plot No. GH-01A, Sector 16B, Gr. Noida (W)



Actual View

PANCHSHEEL
Wellington

At crossings of road No. 24, Ghaziabad
2/3 BEDROOM APARTMENTS

Crossings Republik, Ghaziabad



Actual View

PANCHSHEEL
PRIMROSE

2/3 BR Apts. Opp. GovindPuram, Anaaj Mandi, GZB.



Actual View

PANCHSHEEL
Well Bazaar

At Wellington, Crossings Republik, Ghaziabad



Actual View

PANCHSHEEL
SQUARE

SHOPS OFFICE SPACES FOOD COURT

Crossings Republik, Ghaziabad

Ongoing Projects



Actual View

PANCHSHEEL
PRIME 390

LOW-RISE FLOORS AT PANCHSHEEL PRIMROSE, GZB.

Low-rise (G+4 Storied) 3 BHK apartments
with 8ft. wide verandah

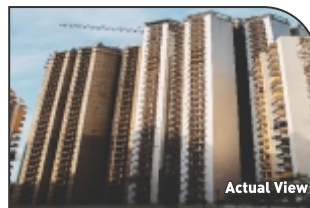

Actual View

PANCHSHEEL
PINNACLE

Live above everything else

Plot No. GH-01A, Sector 16B, Gr. Noida (W)
High-rise apartments

Aluminium shuttering used for better construction Quality.



Actual View

PANCHSHEEL
पंच

The name is the address

2/3 BR HOMES Sec-75, Noida

Aluminium shuttering used for better construction Quality.



Actual View

PANCHSHEEL
Pebbles

Homes near Vaishali Metro Stn.,
Sector 3, Vaishali, GZB



Actual View

Panchsheel
Villas

GREATER NOIDA (WEST)

Plot No. GH-01A, Sector 16, Gr. Noida (W)



Actual View

Phase-1 Possession offered.
1950 Flats

PANCHSHEEL
Greens-II

2/3 BR Apts. Gr. Noida (West)

Plot No. GH-01A, Sector 16, Gr. Noida (W)



Artistic View

PANCHSHEEL
GREENMART

Plot No. GH-01A, Sector 16, Gr. Noida (W)



Actual View

Booking Open in
2 New Towers

PANCHSHEEL
Wellington

At crossings of road No. 24, Ghaziabad
2/3 BEDROOM APARTMENTS

Crossings Republik, Ghaziabad

Disclaimer: Visual representation of images and elevation shown in this brochure are purely conceptual. All plans, specifications, layouts etc. are tentative and subject to variations and modifications by the company or the competent authorities and company does not bear any legal consequences for it. The areas are approx. 1 sq. mt. = 10.764 sq.ft. (10.764 sq.ft. = 1.0 sq.mt. = 10⁶ sq.mm.) we are RERA compliant

Location Map

This brochure and its content is purely conceptual and not a legal offering.



LOCATION ADVANTAGES:

- 2 Km from Crossings Republik, NH-24 • 8 Km from Noida, Sec-71
- 4 Km from Noida, Sec-121 • 11 Km from Noida City Centre Metro Station
- 8.5 Km from Sai Mandir • 10 Km from Indirapuram, Ghaziabad



Project Funded By:



Panchsheel Buildtech Pvt. Ltd. (ISO 9001 : 2008 Company)

Corporate Office: H-169, Sec. 63, Noida - 201301. | Tel.: 0120 - 4777700 / 0120 - 4777777 (15 Lines) | Fax: 0120 - 4777798

Site Office: Plot No. GH-01A, Sector-16, Greater Noida (West) | E-mail: sales@panchsheelgroup.com

Toll Free No. : 1800 200 3656 | sms PBL to 53030 | Website: www.panchsheelgroup.com

Follow us



Sales Enq. : 8287 789 789



Disclaimer: Visual representation of images and elevation shown in this brochure are purely conceptual. All plans, specifications, layouts etc. are tentative and subject to variations and modifications by the company or the competent authorities and company does not bear any legal consequences for it. The areas are approx. 1 sq. mt. = 10.764 sq.ft. (10.764 sq.ft. = 1.0 sq.mt. = 10' sq.mm.)