

The
Pride



*The relationship that makes
everyone happy.*

The
Pride
Location Map

a Contemporary Vision





*Where the only limitation is
your imagination.*





Enviabile Facilities

Unmatched Location

C.V.Raman
Engg. College



Located at TAMANDO, the new center of the expanded Bhubaneswar, "The Pride" is adjacent to Kalinga Vihar, the mega BDA housing project. The project is well connected to the major place of the town. The 200' wide road from Kalinga Vihar to Ghatikia is connected to the project. Any part of the city can be reached through NH5, which is just 1.5 km from the project. Set amidst a tranquil environment the project is well located from essential amenities like transportation, health, education & daily needs.

- Airport - 7 Km
- Bus Stand - 4 Km
- Railway Station - 11 Km
- Sum Hospital - 5 Km
- National Highway - 1.2 Km

Everybody Has Something In Here.



- Project Approved By B.D.A & Banks.
- Bore Wells For 24 Hrs. Water Supply.
- Power Backup For Common Area & Individual Unit (200 Watt).
- Provision For Intercom, Telephone and Cable TV.
- Designed as per Vastu.
- Swimming Pool with toddler pool.
- Automatic Lift

- 24 Hrs Security.
- Car Parking Facilities.
- Club with Multigym
- Community Hall .
- Jogging Track.
- Children Play Area With Landscaped Garden.



Plans to give growth



Block A

Flat No	Type	SBA (Sft.)
101, 201, 301, 401, 501	3BHK	1337
102, 202, 302, 402, 502	2BHK	1188
103, 203, 303, 403, 503	2BHK	1188
104, 204, 304, 404, 504	3BHK	1332
105, 205, 305, 405, 505	2BHK	1112
106, 206, 306, 406, 506	2BHK	1017
107, 207, 307, 407, 507	2BHK	1031
108, 208, 308, 408, 508	2BHK	1082

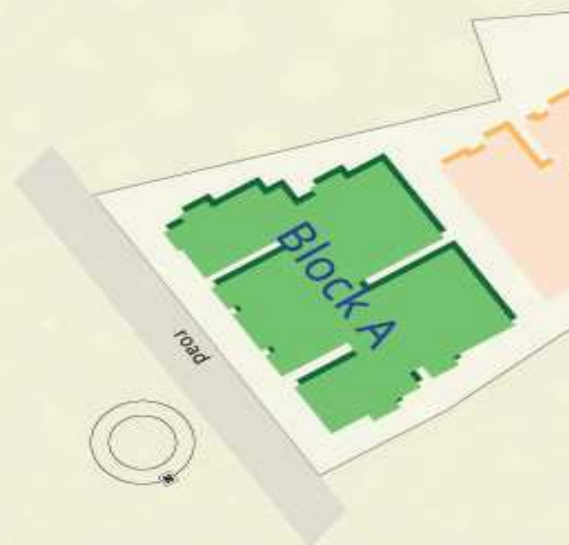



Block B

Flat No	Type	SBA (5Ft.)
101, 201, 301, 401, 501	3BHK	1468
102, 202, 302, 402, 502	2BHK	905
103, 203, 303, 403, 503	2BHK	850
104, 204, 304, 404, 504	3BHK	1387

Flat No	Type	SBA (5Ft.)
105, 205, 305, 405, 505	2BHK	1372
106, 206, 306, 406, 506	2BHK	909
107, 207, 307, 407, 507	2BHK	851
108, 208, 308, 408, 508	2BHK	1445

specification

THAT MAKES YOU STRONG

- **STRUCTURE** : RCC framed construction with infill brick wall.
- **FLOORING** : Designer range vitrified tiles inside the flat in the living, dining, kitchen, bed rooms. Anti skid floor tiles to the balconies and toilets.
- **WALLS** : All internal walls inside the flats are finished with one coat Wall Putty and plastic emulsion paints. All external walls are weather proof paints.
- **KITCHEN** : Granite cooking platform with stainless steel sink, wall above the platform is finished with ceramic tiles up to 3' height.
- **TOILET** : Premium quality ceramic ware along with C.P. Fitting. Walls are finished with designer's range ceramic tiles up to 7'ht .
- **DOORS** : Main door is of Teak Wood over 30mm branded flushed and all other internal doors are flush doors, finished with enamel paints.



- **WINDOWS** : All windows are of anodized aluminium frames with 5mm glass panelled with MS grill protection.
- **ELECTRICALS** : Concealed network with reputed quality copper wires, modular type switches and sockets. AC point in one bed room & geyser point in one bath room.

trust

NAME YOU CAN TRUST



Specimens Realty is founded on a vision which seeks to usher in a better tomorrow by providing people with improved quality of life and living standards. Recognizing the basic need to approach the issue of planned development and growth across the Residential, Commercial and Retail segments of the Real Estate Industry, we at SRL believe that the key element of this transformation is change - a change from within and without.

Our work is not based on guess or assumption, "RESEARCH", is the only way we follow to accomplish our client's requirement of real estate. We are supported by our property experts and extensive property and client database, which enable our professionals to access regional property opportunities and to pursue client interest in a cost-effective manner.

With entrepreneurial spirit being the way of life at Client Associates, our entire approach is geared towards innovation and taking the initiative on behalf of the client. Our clients come to us for our expertise and deep knowledge. They build their businesses and maximize the gains on the power of our managed network.



Specimens Group is one of the fastest growing groups with different companies spanning across multi lines of business - Marketing, Retail Trading, Consultancy, Wealth Management Advisory Services, and Data Sourcing, Software solutions, Health Care Services, Tourism, Education, Human Resource, Social Welfare, Training development & HRD. It has developed strong corporate governance model based on the core values of excellence, knowledge, care integrity & team work. Each following company of the group is professionally managed and has best of the talents from the respective fields. Companies believe its people and provide a very positive environment.

Own a piece of
Pride
to feel pride.

Group Concerns :



Consultant:

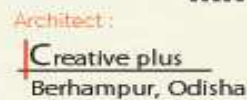

www.thepride.co.in
email: info@thepride.co.in

SPECIMENS REALTY LIMITED

Corp. Office : Plot no.-99, Ground Floor, Jharpada, Bhubaneswar-06, Odisha
Regd. Office : Specimens House, 4th Floor, BhabaNagar, Berhampur-04, Odisha
www.specimensrealty.com, www.specimensgroup.com

Disclaimer

This brochure is not a legal document. All designs, perspectives, specifications, layout plans, etc. are indicative and are subject to change. Accessories shown in some of the pictures in this brochure, such as furniture, cabinets, electrical appliances, light fittings, paintings, wall and floor textures etc. are indicative/ decorative and are not part of the sale offered.